

39 Homes to rent and buy at Monger Lane, Midsomer Norton

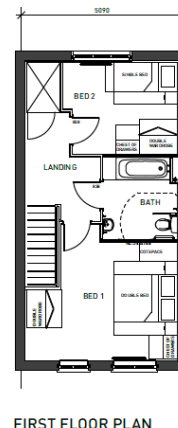
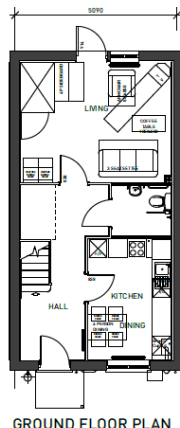

Left: Front elevation drawing 2bed affordable house
Above: Floor plans for 2bed affordable house

Developer	Taylor Wimpey	
Landlord	<u>Selwood Housing</u>	
Scheme details	39 New build affordable homes to rent and buy on the <u>Taylor Wimpey</u> development at Midsomer Norton.	
Tenure and unit mix	Affordable Rent:	2 x 1bed flat over garages 4 x 1bed flats 8 x 2bed houses 7 x 3bed houses 4 x 4bed houses 1 x 5bed house 2 x 1bed wheelchair apartments 3 x 2bed wheelchair houses
	Shared Ownership:	4 x 2bed houses 4 x 3bed houses
Allocation	All homes will be allocated to people with a local connection to Bath and NE Somerset. All rented homes will be allocated through <u>Homesearch</u> Purchase of shared ownership homes will be through <u>Help to Buy South</u> Purchasers will be able to buy a minimum of a 40% share and will be charged 2.75% rent on the unsold equity.	
Completion	These homes will complete between October 2017 and May 2019.	