

SHEET 5 OF 6 SHEETS

20 NW

SHEET 5 of 6 SHEETS

| Parish or District No. | Name |
|------------------------|---------------------|
| 4 | CAMERTON |
| 7 | COMBE HAY (part) |
| 10 | DUNKERTON (part) |
| 11 | ENGLISHCOMBE (part) |
| 19 | PEASEDOWN ST. JOHN |
| 20 | PRISTON (part) |
| 23 | SHOSCOMBE (part) |
| 25 | WELLOW (part) |

| 6" O.S. Sheet Nos. (County Series) | |
|------------------------------------|-------|
| 20 NW | 20 NE |
| 20 SW | 20 SE |

SOMERSET COUNTY COUNCIL
 NATIONAL PARKS AND ACCESS TO THE COUNTRYSIDE ACT, 1949
 RIGHTS OF WAY SURVEY
 DEFINITIVE MAP
 FOR
 BATHAVON RURAL DISTRICT AND KEYNSHAM URBAN DISTRICT
 L. P. WALLEN,
 Clerk of the Council and
 Chief Executive Officer.
 Date:

SHEET 5 OF 6 SHEETS

Will members of the public kindly note that since the relevant date certain public rights of way have been by Order stopped up or diverted. On the attached map these are shown thus (diversions in blue):



REFERENCE
 Public Footpath, shown coloured purple, thus:—

Public Bridleway, shown coloured green, thus:—

Road used as a Public Path, shown coloured broken green line, thus:—

Any further information thereon may be obtained from the undersigned.
 L. P. WALLEN,
 Clerk of the Council and
 Chief Executive Officer,
 County Hall,
 TAUNTON.

Rural District boundary shown coloured blue, thus:—

Parish boundary, shown coloured red, thus:—

Roads shown coloured brown thus:— have been shown for guidance and are not intended on this map to indicate which roads are or are not publicly maintainable.

not to scale

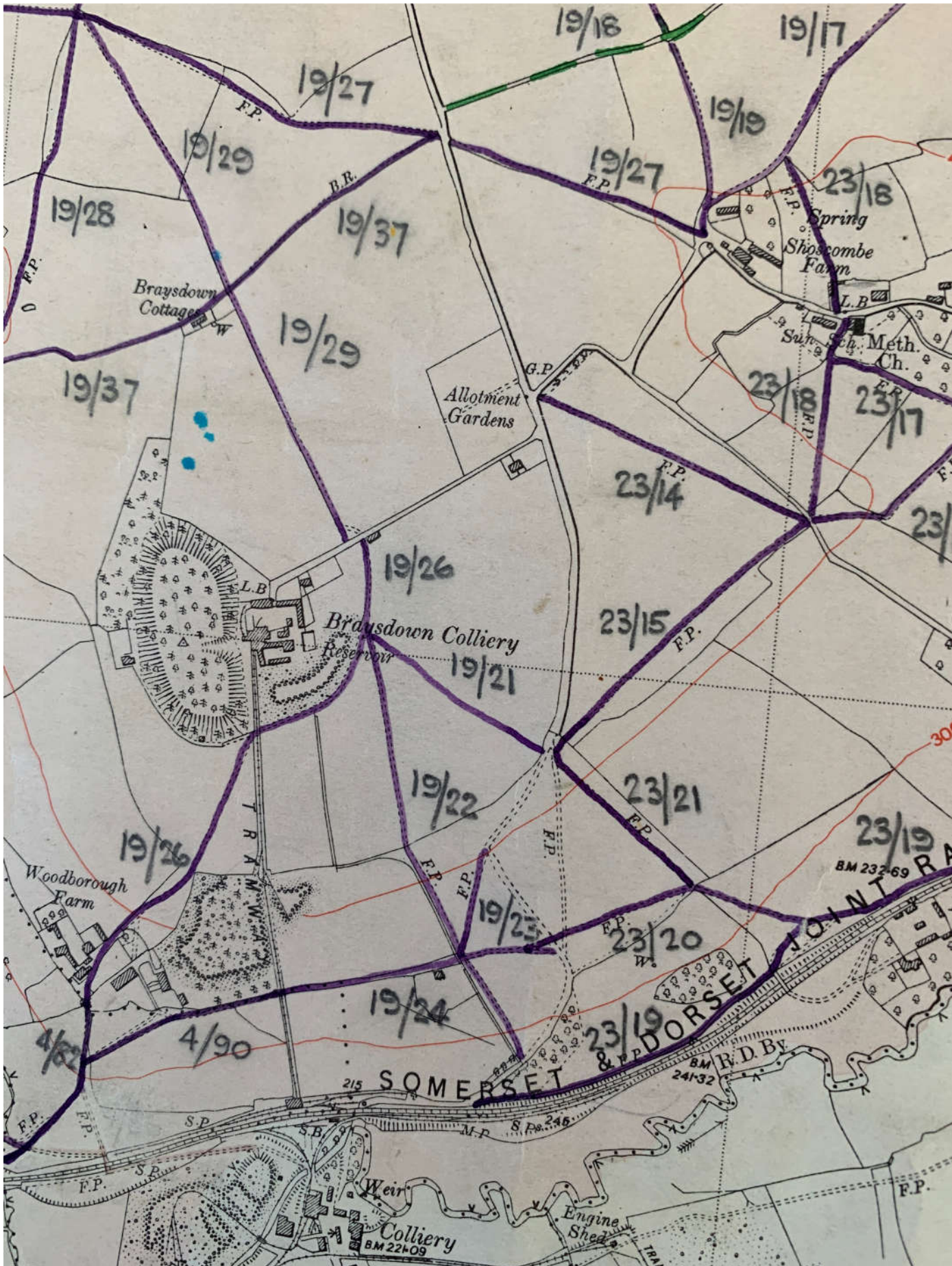

(THIS SIDE ONLY TO BE COMPLETED BY PARISH COUNCIL
AT TIME OF FIRST SURVEY)

(1) PARISH NO. OF PATH:- 21

SYMBOLS TO BE USED
IN BOX (5) BELOW

- Footpath F.P.
- Bridle Road (including Driftway for Cattle) B.R.
- Carriage or Cart Road or Green (unmetalled lane) mainly used by Public as
- (1) Footpath C.R.F.
- (2) Bridleway C.R.B.

(2) CONCISE DESCRIPTION OF PATH (TO INCLUDE WIDTH, NATURE OF SURFACE, MEANS OF ACCESS, OBSTRUCTIONS, ETC.)

FROM:- Gasson Hill

TO:- Braysdown Colliery

DESCRIPTION:- THE PATH IS A F.P. IT STARTS AT the top of Gasson Hill and runs north west to join footpath 26 near Braysdown Colliery.

BA19/21

From: Gasson Hill

To: Woodborough Lane, Braysdown Colliery

Description: The path is a FP it starts at the top of Gasson Hill and runs north west to Woodborough Lane near Braysdown Colliery.

Bath and North East Somerset District Council
(Former Bathavon Rural District Area) (No 1)
Definitive Map and Statement Modification Order 1999
relevant date: 22nd December 1999

WILDLIFE AND COUNTRYSIDE ACT 1981

BATH AND NORTH EAST SOMERSET DISTRICT COUNCIL
(FORMER BATHAVON RURAL DISTRICT AREA) (NO. 1) DEFINITIVE MAP AND
STATEMENT MODIFICATION ORDER 1999

This order is made by the Bath and North East Somerset District Council under section 53(2)(b) of the Wildlife and Countryside Act 1981 (hereinafter called "the Act") because it appears to that authority that the Definitive Map and Statement for the former Bathavon Rural District require modification in consequence of the occurrence of events specified in section 53(3)(a)(i) of the Act, namely, that highways shown or required to be shown in the map and statement have been authorised to be stopped up, diverted, widened or extended; and in section 53(3)(a)(ii) of the Act, namely that highways shown or are required to be shown in the map and statement as highways of a particular description have ceased to be highways of that description.

The Bath and North East Somerset District Council hereby order that:

1. For the purposes of this order the relevant date shall be 30th November 1999.
2. The Bathavon Rural District Definitive Map and Statement shall be modified as described in Part I and Part II of the Schedule and shown on the maps attached to the order.
3. This order shall take effect on 22nd December 1999 and may be cited as the Bath and North East Somerset District Council (Former Bathavon Rural District Area) (No. 1) Definitive Map and Statement Modification Order 1999.

Given under the Common Seal of the Bath and North East Somerset District Council the 22nd day of December 1999.

The COMMON SEAL of the
BATH AND NORTH EAST SOMERSET
DISTRICT COUNCIL
was hereunto affixed
in the presence of:-



AK Brooks
Corporate Law Manager

~~Solicitor to the Council~~

| | |
|------------------------------|-------------|
| AUTHORITY FOR SEALING | |
| Council resolution | PT+E |
| Committee minute | 38 of 47/96 |
| Initials | AK |

SCHEDULE**PART 1****Modification of Definitive Map****Description of path or way to be deleted**

- BA4/18** The whole section of footpath BA4/18 which commences on the south side of the bridge crossing the Priston Brook on the parish boundary at the junction of footpaths BA4/17 and BA20/5 and runs in a generally south easterly direction for approximately 422 metres to the point where the footpath joins footpaths BA4/15 and BA20/16 shown by a bold continuous line marked A - B on the map numbered BA4/18 annexed to this order.
- BA4/64** That section of footpath BA4/64 commencing at a point approximately 33 metres north north east of the start of footpath at Skinners Hill and running north north east veering north east for approximately 314 metres to the junction of public footpaths BA2/63, BA2/67 and BA4/68 and shown by a bold continuous line marked A - B - C on the map numbered BA4/64 annexed to this order.
- BA4/66** That section of footpath BA4/66 commencing from a point approximately 151 metres north east of the public highway at Camerton Hill running in a north easterly direction for approximately 156 metres shown by a bold continuous line marked A - B on the map numbered BA4/66 annexed to this order.
- BA4/74** That section of footpath BA4/74 commencing at a point 326 metres south east of the start of footpath in Paulton Lane and running in a generally east south easterly direction for a distance of approximately 108 metres to the end of the path at Skinners Hill, shown as a bold continuous line marked A - B on the map numbered BA4/74 annexed to this order.
- BA10/14** That section of footpath BA10/14 commencing at the public highway Stoneage Lane, west of Lower Tunley Farm and running in a generally south westerly direction for approximately 50 metres shown by a bold continuous line marked A - B on the map numbered BA10/14 annexed to this order.
- BA10/16** That section of footpath BA10/16 which runs from Fosse Way, BA10/40, in an east south-easterly direction to the end of the footpath at the Bath-Radstock Road, a distance of approximately 80 metres shown by a bold continuous line marked A - B on the map numbered BA10/16 annexed to this order.

- BA10/23** The whole length of footpath BA10/23 known as Button's Lane starting from The Hollow and running in a generally north westerly direction for a distance of approximately 70 metres to the junction of footpath BA10/22, shown by a bold continuous line marked A - B on the map numbered BA10/23 annexed to this order.
- BA11/10** The whole length of footpath BA11/10 commencing in Mill Lane west of Home Farm running in a south westerly direction to the footbridge on Priston Brook shown by a bold continuous line marked A - B on the map numbered BA11/10 annexed to this order.
- BA11/23** That section of footpath of BA11/23 commencing approximately 76 metres south of the junction of Priston Road and extending southwards for a distance of 3.3 metres with a width of 1.2 metres as shown by a bold continuous line marked A - B on the map numbered BA11/23 annexed to this order.
- BA19/5** That section of footpath BA19/5 commencing at a point approximately 100 metres from the start of the footpath in Church Road alongside the church yard, running north, veering north east then in a northerly direction to the end of the footpath in Church Road for a distance of approximately 50 metres shown by a bold continuous line marked A - B on the map numbered BA19/5 annexed to this order.
- BA19/25** That section of footpath BA19/25 commencing at a point 363 metres from the start of the footpath in Braysdown Lane and running in a southerly direction for a distance of approximately 219 metres to the end of the footpath in Wellow Lane shown by a bold continuous line marked A - B on the map numbered BA19/25 annexed to this order.
- BA19/26** That section of footpath BA19/26 commencing from the start of the path at Braysdown Road and running in a southerly direction for a distance of approximately 610 metres north of Woodborough Farm shown by a bold continuous line marked A - B on the map numbered BA19/26 annexed to this order.
- BA19/32** That section of footpath of BA19/32 commencing at a point approximately 120 metres from the start of the footpath running in a generally north easterly direction for a distance of approximately 68 metres to the end of the footpath shown by a bold continuous line marked A - B on the map numbered BA19/32 annexed to this order.
- BA19/33** That section of footpath BA19/33 from the junction of footpath BA19/32 running in a generally easterly veering southerly direction for a distance of approximately 45 metres shown by a bold continuous line marked A - B on the map numbered BA19/33 annexed to this order.

- BA19/35
- a) That section of the footpath BA19/35 commencing at a point on the west side of French Close running east north-east for a distance of approximately 6 metres shown by a bold continuous line marked A - B on the map numbered BA19/35-1 annexed to this order.
 - b) That section of the footpath BA19/35 commencing at a point north east of No 23 Naishes Avenue running east for a distance of approximately 6 metres shown by a bold continuous line marked C - D on the map numbered BA19/35-1 annexed to this order.
 - c) That section of the footpath BA19/35 commencing at a point north east of No 5 Naishes Avenue running east north-east for a distance of approximately 8 metres shown by a bold continuous line marked E - F on the map numbered BA19/35-1 annexed to this order.
 - d) That section of footpath BA19/35 commencing at a point 20 metres east of Naishes Avenue running in a generally east north-easterly direction veering easterly to the end of the footpath in Eckweek Lane shown by a bold continuous line marked A - B on the map numbered BA19/35-2 annexed to this order.
- BA20/12 The whole length of footpath BA20/12 from the top of Conygre Hill running in a north easterly direction to the junction with B.R. BA20/11 shown by a bold continuous line marked A - B on the map numbered BA20/12 annexed to this order.

Description of path to be added

- BA4/18 From point C, to the east of point A, running in a generally south easterly direction for approximately 431 metres to point D at a junction of footpath BA20/16 south east of the original termination of the path at the junction of path BA4/15 and BA20/16 shown by a bold broken line marked C - D on the map numbered BA4/18 annexed to this order.
- BA4/64 From point A the footpath runs in a generally north easterly direction for approximately 302 metres to rejoin the original line of the footpath at point C, shown by a bold broken line marked A - C on the map numbered BA4/64 annexed to this order.
- BA4/66 From point A, the footpath runs in an east north easterly direction for approximately 58 metres, turning north north east for a distance of approximately 110 metres to rejoin the original line of the footpath at point B, shown by a bold broken line marked A - B on the map numbered BA4/66 annexed to this order.

- BA4/74** From point A the footpath runs in a east north easterly direction for a distance of approximately 72 metres turning south east for a distance of approximately 25 metres to meet the public highway at point D, to the north of point B and shown by a bold broken line marked A - C - D on the map numbered BA4/74 annexed to this order.
- BA10/14** From point C, on the highway, Stoneage Lane, 34 metres north north-west of point A and running in a generally south westerly direction for a distance of approximately 49 metres veering south east for a further 50 metres to rejoin the original line of the footpath at point B shown by a bold broken line marked C - B on the map numbered BA10/14 annexed to this order.
- BA10/23** From point C, on the highway, The Hollow, approximately 50 metres south of point A and running in a generally westerly direction for a distance of approximately 50 metres veering north north-west for a further distance of approximately 70 metres to rejoin the original line of footpath at point B shown by a bold broken line marked C - B on the map numbered BA10/23 annexed to this order.
- BA11/10** From point C in Mill Lane, 150 metres north west of point A, running in a generally southerly direction veering south west to rejoin the original line of the footpath at point B shown by a bold broken line C - B on the map numbered BA11/10 annexed to this order.
- BA19/25** From point A running in a generally south westerly direction for approximately 14 metres turning south, running in a generally southerly direction to the west of original footpath for a distance of approximately 216 metres to point C on the Wellow Road shown by a bold broken line marked A - C on the map numbered BA19/25 annexed to this order.
- BA19/25A** From point A at northern end of Sunnyside View running in an westerly direction turning north into the access road to the former St John Youth Club, 40 metres south of the Bath Road shown by a bold broken line A - B on the map numbered BA19/25A annexed to this order.
- BA19/32**
- a) From point A running in a generally easterly direction for a distance of approximately 20 metres to point D shown by a bold broken line A - D on the map numbered BA19/32 annexed to this order, and
 - b) from point C at the junction with footpath BA19/33 running in a northerly direction for a distance of approximately 35 metres to rejoin the original line of the footpath at point B shown by a bold broken line C - B on the map numbered BA19/32 annexed to this order.
- BA19/33** From point C, 40 metres east of point A and at a junction with footpath BA19/32, running in a generally southerly direction for a distance of approximately 20 metres to rejoin the original line of the footpath at point B shown by a bold broken line C - B on the map numbered BA19/33 annexed to this order.

- BA19/35
- a) From point A 20 metres east of Naishes Avenue, near Nos. 2 and 4 Naishes Avenue, running in an east north-easterly direction veering south east into Heritage Close at point C shown by a bold broken line A - C on the map numbered BA19/35-2 annexed to this order.
 - b) From point D near No 15 Heritage Close running east north-east to point E south of No 9 Heritage Close shown by a bold broken line D - E on the map numbered BA19/35-2 annexed to this order.
 - c) From point F near 5 Heritage Close running south south-east to point G in Orchard Way shown by a bold broken line F - G on the map numbered BA19/35-2 annexed to this order.
 - d) From point H near No 49 Faulkland View running east north-east into Eckweek Lane at point J shown by a bold broken line H - J on the map numbered BA19/35-2 annexed to this order.

PART II

Modification of Definitive Statement

Variation of particulars of path or way

- BA4/18** **From:** Priston Brook, junction of footpath BA20/5
To: FP BA20/16
Description: The path is a FP it starts on parish boundary by Priston Brook at junction with footpath BA20/5 and follows field boundary hedges to the east, running south east to junction with footpath BA20/16.
- BA4/64** **From:** Skinner's Hill
To: Top of Hurdles
Description: The path is a FP it starts at the bottom of Skinner's Hill opposite Manor Farm and passes through iron gate to field near entrance to Court, and thence north east across field crossing footpath BA4/62 to the top of Hurdles where it joins footpath BA4/63.
- BA4/66** **From:** Pound Cottages
To: Bottom of Hurdles and Wick Lane
Description: The path is a FP it starts at footpath BA4/65 near Pound Cottages and runs north east veering east north east then north east to stile giving access to Hurdles, and continues down to wooden wicket at the bottom of Hurdles where it joins footpaths BA4/68 and BA4/69 leading into Wick Lane.
- BA4/74** **From:** Glebe Cottage
To: Top of Skinner's Hill
Description: The path is a FP it starts at stile on the Camerton - Paulton road opposite Glebe Cottage, and it runs south east across field and then east along top of field for approximately 150 metres turning south east and thence to the top of Skinner's Hill (county road) north of Camerton Farm.
- BA10/4** **From:** Main Road at Tunley
To: Priston Parish boundary in Blind Lane
Description: The path is a BR it starts at the Old Colliery at main road Tunley and runs north along Blind Lane continuing into Priston Parish as BR 20/4.

- BA10/14** From: Lower Tunley Farm
 To: Camerton Parish boundary
 Description: The path is a FP it starts at the county road at Lower Tunley Farm runs south west for a distance of approximately 49 metres veering south east for a further 50 metres turning south west across fields to the parish boundary where it continues as footpath BA4/27.
 Note: Gates maintained by Parish council.
- BA10/16** From: County road by Dunkerton Church
 To: The Old Fosse Way, BA10/40
 Description: The path is a FP it starts at county road near Dunkerton Church and runs south between the Church and Lower Church Farm and then across fields, turning south east to the Old Fosse Way, BA10/40
 The path is called the Wrangle.
- BA10/23** From: The Hollow, south of The Coach House
 To: Footpath BA10/22
 Description: The path is a FP it starts at The Hollow south of The Coach House and runs in a westerly direction veering north north-west to join footpath BA10/22.
- BA11/10** From: Mill Lane, west of Inglesbatch Village
 To: Priston Parish boundary
 Description: The path is a FP it starts at Mill Lane west of Inglesbatch Village and runs south veering south west to footbridge on Priston Brook at the parish boundary, where it continues as footpath 20/1.
- BA19/5** From: Church Road
 To: Church Road (Cul-de-sac)
 Description: The path is a FP it starts at wicket gate close to the churchyard wall and runs north east veering north north east to cul-de-sac off Church Road.
- BA19/9** From: New Buildings
 To: Firs Plantation
 Description: The path is a FP it starts at the road at New Buildings almost opposite Bridleway BA19/12 and runs easterly between garden walls and houses to the edge of firs plantation at junction of footpaths 10 and 11.
- BA19/19** From: Wellow Road
 To: Shoscombe Farm
 Description: The path is a FP it starts at Wellow Road near Wellow Tynning Cottages and runs south easterly across BOAT BA19/18 and continues across field to joint footpath 17 at Shoscombe Farm.

- BA19/21** From: Gasson Hill
 To: Woodborough Lane, Braysdown Colliery
 Description: The path is a FP it starts at the top of Gasson Hill and runs north west to Woodborough Lane near Braysdown Colliery.
- BA19/22** From: Bottom of Gasson Hill
 To: Woodborough Lane, Braysdown Colliery
 Description: The path is a FP it starts at the bottom of Gassons Hill and runs northerly across footpath 24 and thence to Woodborough Lane near Braysdown Colliery.
- BA19/25A** From: Sunnyside View
 To: Access road to the former Peasedown St John Youth Club
 Description: The path is a FP it starts at northern end of Sunnyside View runs in an westerly direction turning north into the access road to the former St John Youth Club, 40 metres south of the Bath Road.
- BA19/26** From: Southern end Woodborough Lane
 To: Parish boundary at Woodborough Farm
 Description: The path is a FP it starts at southern end of Woodborough Lane and runs south west through Woodborough Farm to the Camerton Parish boundary where it continues as footpath BA4/82.
- BA19/32a** From: Eckweek Lane
 To: A367
 Description: The path is a FP it starts at Eckweek Lane and runs north east to the A367.
- BA19/32b** From: Junction of Footpath BA19/33
 To: Wellow Parish boundary
 Description: The path is a FP it starts at junction of footpath BA19/33 and runs north east to the parish boundary where it continues as footpath BA25/40 to White Ox Mead.
- BA19/33** From: F.P. 19/32
 To: Parish boundary
 Description: The path is a FP it starts at the junction of footpath BA19/32 and runs south westerly to the parish boundary where it continues as footpath BA23/23 to Bourne Farm, Wellow Road.
- BA19/35a** From: Footpath 25 near Bloomfield Cottages
 To: French Close
 Description: The path is a FP it starts at footpath 25 near Bloomfield Cottages (Fairfield Cottages on Map) and runs east turning south and finally east north-east to French Close.

- BA19/35b From: French Close
To: Naishes Avenue, north of No 23
Description: The path is a FP it starts at French Close and runs east north-east to Naishes Avenue, north of No 23.
- BA19/35c From: Naishes Avenue, south of No 11
To: Naishes Avenue south of No 8
Description: The path is a FP it starts at Naishes Avenue, south of No 11 and runs east north-east to Naishes Avenue, south of No 8.
- BA19/35d From: Naishes Avenue, south of No 4
To: Heritage Close, outside No 21
Description: The path is a FP it starts at Naishes Avenue, south of No 4 and runs east north-east to Heritage Close, outside No 21.
- BA19/35e From: Heritage Close, south of No 15
To: Heritage Close, south of No 9
Description: The path is a FP it starts at Heritage Close, south of No 15 and runs east north-east to Heritage Close, south of No 9.
- BA19/35f From: Heritage Close, east of No 5
To: Orchard Way
Description: The path is a FP it starts at Heritage Close, east of No 5 and runs east south-east to Orchard Way.
- BA19/35g From: Faulkland View, south of No 49
To: Eckweek Lane
Description: The path is a FP it starts at Faulkland View, south of No 49 and runs east north-east to Eckweek Lane.
- BA19/36 From: Wellow Road
To: Eckweek Lane
Description: The path is a FP it starts at Wellow Road opposite junction of BOAT BA 19/18 and it runs north east across field into Eckweek Lane.
- BA20/4 From: Priston – Nailwell road
To: Parish boundary in Blind Lane
Description: The path is a FP it starts at the county road south of Nailwell and proceeds south west along Blind Lane to the Dunkerton Parish boundary and continues as B.R. BA10/4.
- BA20/11 From: Pottern on Marksbury Road
To: Marksbury Parish Boundary
Description: The path is a FP it starts at the Marksbury road at the side Pottern and runs north across fields to the parish boundary where it continues as BOAT BA15/3 to Stanton Prior.

BA20/14**From: BOAT BA20/18****To: Englishcombe Parish boundary****Description: The path is a FP it starts at BOAT BA20/18 near Priston Mill and runs east to footbridge over stream on the parish boundary where it continues as footpath 11/11 to Inglesbatch.**

Wildlife and Countryside Act 1981
BATH & NORTH EAST SOMERSET DISTRICT COUNCIL
(Former Bathavon Rural District Area) (No. 1)
Definitive Map and Statement Modification Order 1999

Strategic Policy
Trimbridge House
Trim Street
BATH BA1 2DP

Grid Ref. 6835 5975

Map Number BA 4/18

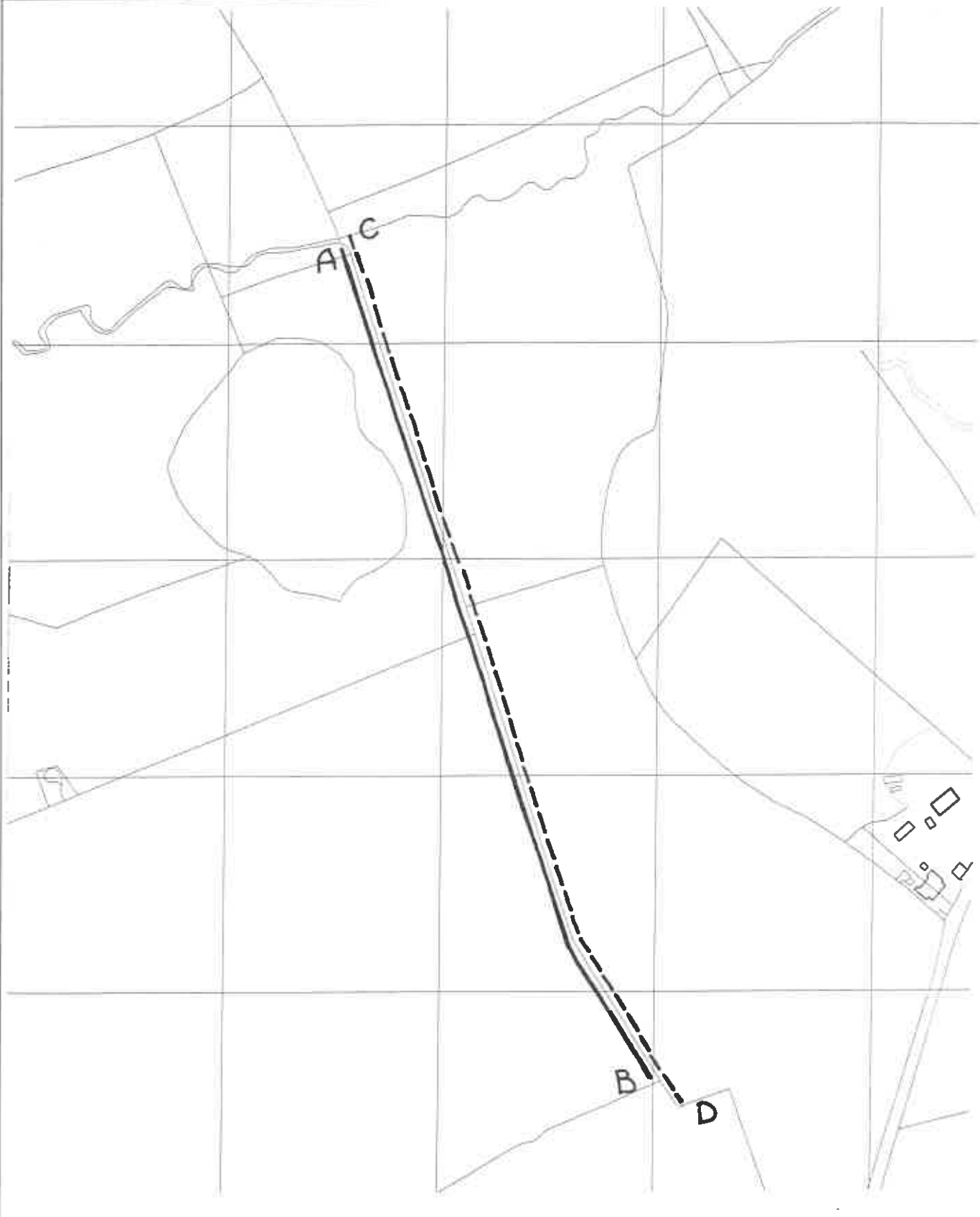

Scale 1:2500



Original path ———
Modified path - - - - -

The material contained in this plot has been reproduced from an Ordnance Survey Map with permission of Her Majesty's Stationary Office. Copyright Licence No: LA09054L

Wildlife and Countryside Act 1981
BATH & NORTH EAST SOMERSET DISTRICT COUNCIL
(Former Bathavon Rural District Area) (No. 1)
Definitive Map and Statement Modification Order 1999

Strategic Policy
Trimbridge House
Trim Street
BATH BA1 2DP

Grid Ref. 6846 5749

Map Number BA 4/64

DE FORT ROAD

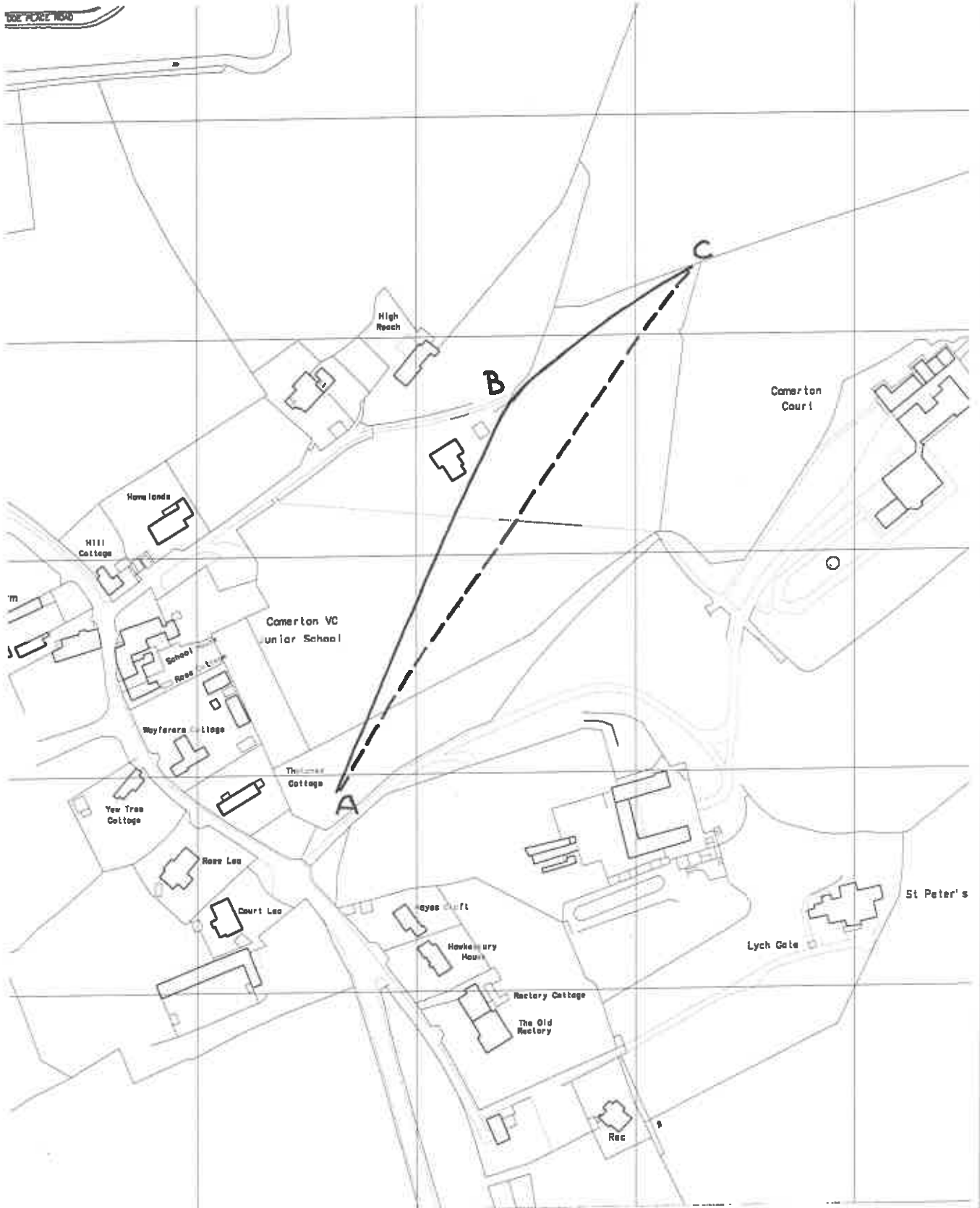

Scale 1:2500



Original path —————
Modified path - - - - -

The material contained in this plot has been reproduced from an Ordnance Survey Map with permission of Her Majesty's Stationary Office. Copyright Licence No: LA09054L

Wildlife and Countryside Act 1981
BATH & NORTH EAST SOMERSET DISTRICT COUNCIL
 (Former Bathavon Rural District Area) (No. 1)
 Definitive Map and Statement Modification Order 1999

Strategic Policy
 Trimbridge House
 Trim Street
 BATH BA1 2DP

Grid Ref. 6848 5766

Map Number BA 4/66

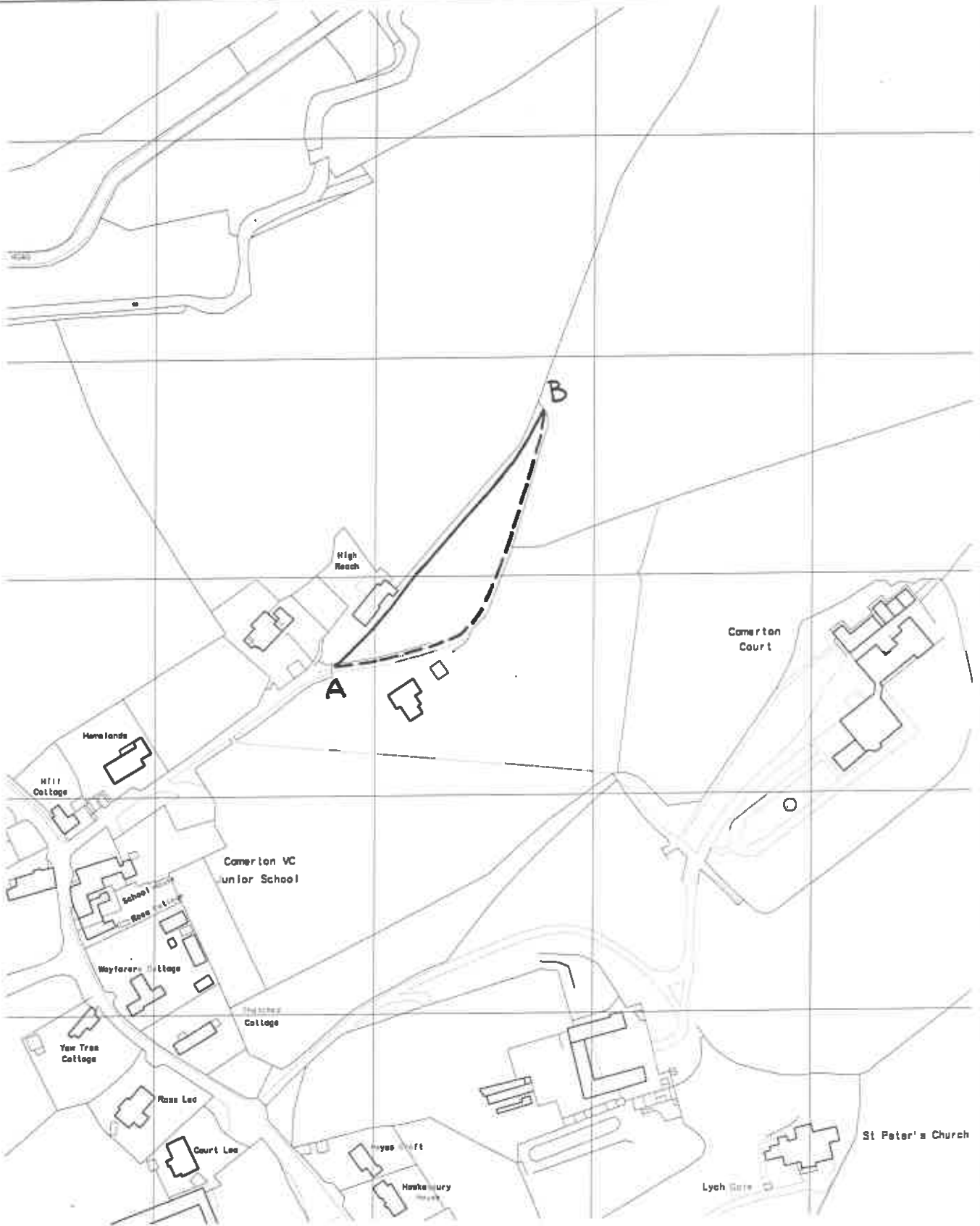

Scale 1:2500



Original path ————
 Modified path - - - - -

The material contained in this plot has been reproduced from an Ordnance Survey Map with permission of Her Majesty's Stationary Office. Copyright Licence No: LA09054L

Wildlife and Countryside Act 1981
BATH & NORTH EAST SOMERSET DISTRICT COUNCIL
(Former Bathavon Rural District Area) (No. 1)
Definitive Map and Statement Modification Order 1999

Strategic Policy
Trimbridge House
Trim Street
BATH BA1 2DP

Grid Ref. 6851 5691

Map Number **BA 4/74**



Scale 1:2500



Original path —————
Modified path - - - - -

The material contained in this plot has been reproduced from an Ordnance Survey Map with permission of Her Majesty's Stationary Office. Copyright Licence No: LA09054L

Wildlife and Countryside Act 1981
BATH & NORTH EAST SOMERSET DISTRICT COUNCIL
(Former Bathavon Rural District Area) (No. 1)
Definitive Map and Statement Modification Order 1999

Strategic Policy
Trimbridge House
Trim Street
BATH BA1 2DP

Grid Ref. 6934 5911

Map Number BA 10/14



Scale 1:2500



Original path —————
Modified path - - - - -

The material contained in this plot has been reproduced from an Ordnance Survey Map with permission of Her Majesty's Stationary Office. Copyright Licence No: LA09054L

Wildlife and Countryside Act 1981
BATH & NORTH EAST SOMERSET DISTRICT COUNCIL
 (Former Bathavon Rural District Area) (No. 1)
 Definitive Map and Statement Modification Order 1999

Strategic Policy
 Trimbridge House
 Trim Street
BATH BA1 2DP

Grid Ref. 7116 5863

Map Number BA 10/16



Scale 1:2500



Original path ———
 Extinguished

The material contained in this plot has been reproduced from an Ordnance Survey Map with permission of Her Majesty's Stationary Office. Copyright Licence No: LA09054L

Wildlife and Countryside Act 1981
BATH & NORTH EAST SOMERSET DISTRICT COUNCIL
 (Former Bathavon Rural District Area) (No. 1)
 Definitive Map and Statement Modification Order 1999

Strategic Policy
 Trimbridge House
 Trim Street
 BATH BA1 2DP

Grid Ref. 7103 5942

Map Number BA 10/23

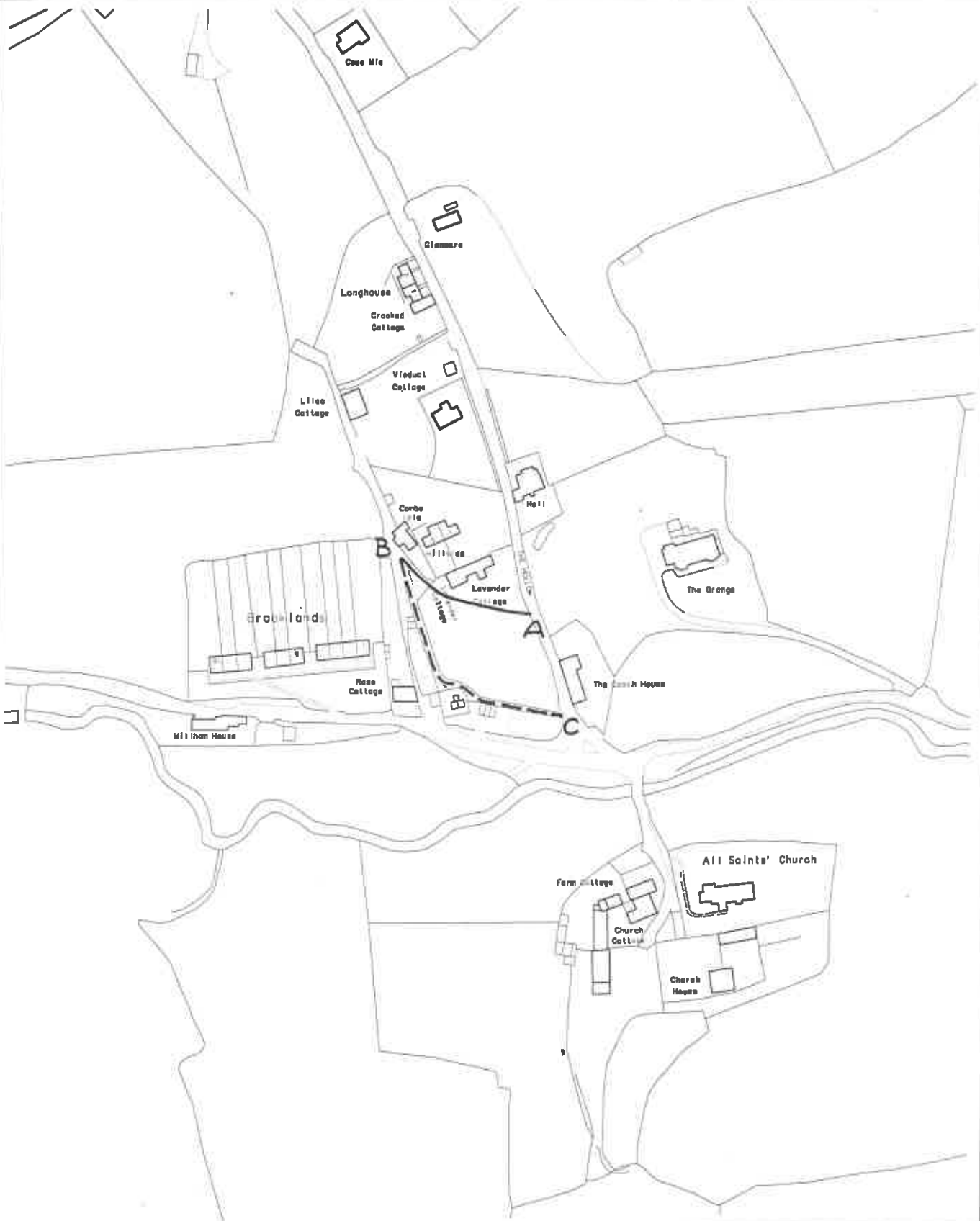

Scale 1:2500



Original path —————
 Modified path - - - - -

The material contained in this plot has been reproduced from an Ordnance Survey Map with permission of Her Majesty's Stationary Office. Copyright Licence No: LA09054L

Wildlife and Countryside Act 1981
BATH & NORTH EAST SOMERSET DISTRICT COUNCIL
 (Former Bathavon Rural District Area) (No. 1)
 Definitive Map and Statement Modification Order 1999

Strategic Policy
 Trimbridge House
 Trim Street
BATH BA1 2DP

Grid Ref. 7026 6136

Map Number BA 11/10

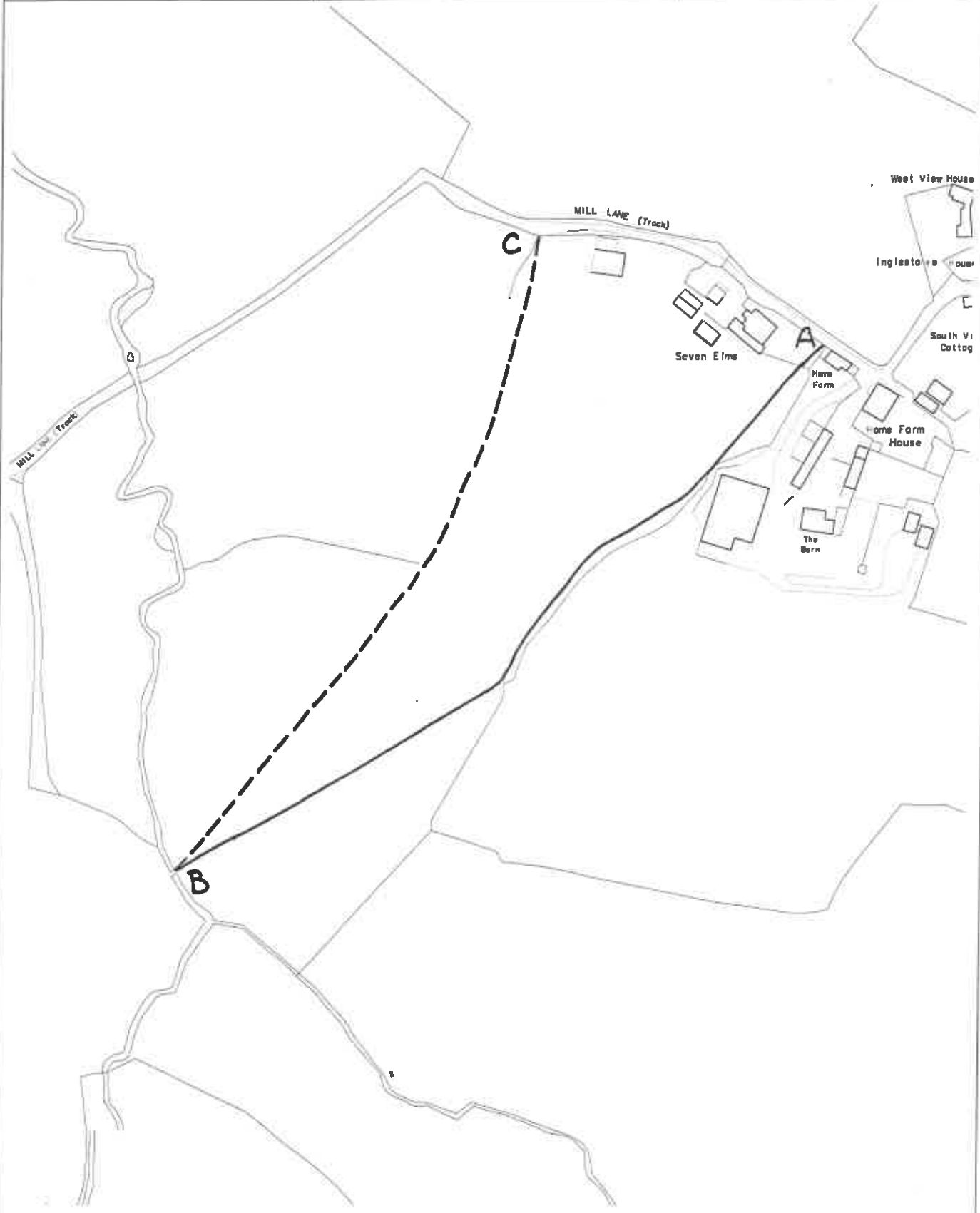

Scale 1:2500



Original path ———
 Modified path - - - - -

The material contained in this plot has been reproduced from an Ordnance Survey Map with permission of Her Majesty's Stationary Office. Copyright Licence No: LA09054L

Wildlife and Countryside Act 1981
BATH & NORTH EAST SOMERSET DISTRICT COUNCIL
(Former Bathavon Rural District Area) (No. 1)
Definitive Map and Statement Modification Order 1999

Strategic Policy
Trimbridge House
Trim Street
BATH BA1 2DP

Grid Ref. 7072 6084

Map Number BA 11/23



Scale 1:500



Original path ———
Extinguished - - - - -

The material contained in this plot has been reproduced from an Ordnance Survey Map with permission of Her Majesty's Stationary Office. Copyright Licence No: LA09054L

Wildlife and Countryside Act 1981
BATH & NORTH EAST SOMERSET DISTRICT COUNCIL
(Former Bathavon Rural District Area) (No. 1)
Definitive Map and Statement Modification Order 1999

Strategic Policy
Trimbridge House
Trim Street
BATH BA1 2DP

Grid Ref. 6992 5763

Map Number BA 19/5



Scale 1:2500



Original path ———
Extinguished - - - - -

The material contained in this plot has been reproduced from an Ordnance Survey Map with permission of Her Majesty's Stationary Office. Copyright Licence No: LA09054L

Wildlife and Countryside Act 1981
BATH & NORTH EAST SOMERSET DISTRICT COUNCIL
(Former Bathavon Rural District Area) (No. 1)
Definitive Map and Statement Modification Order 1999

Strategic Policy
Trimbridge House
Trim Street
BATH BA1 2DP



Grid Ref. 7061 5718

Map Number BA 19/25



Scale 1:2500



Original path 
Modified path 

The material contained in this plot has been reproduced from an Ordnance Survey Map with permission of Her Majesty's Stationary Office. Copyright Licence No: LA09054L

Wildlife and Countryside Act 1981
BATH & NORTH EAST SOMERSET DISTRICT COUNCIL
 (Former Bathavon Rural District Area) (No. 1)
 Definitive Map and Statement Modification Order 1999

Strategic Policy
 Trimbridge House
 Trim Street
 BATH BA1 2DP

Grid Ref. 7029 5730

Map Number BA 19/25A



Scale 1:2500



Path to be added



The material contained in this plot has been reproduced from an Ordnance Survey Map with permission of Her Majesty's Stationary Office. Copyright Licence No: LA09054L

Wildlife and Countryside Act 1981
BATH & NORTH EAST SOMERSET DISTRICT COUNCIL
(Former Bathavon Rural District Area) (No. 1)
Definitive Map and Statement Modification Order 1999

Strategic Policy
Trimbridge House
Trim Street
BATH BA1 2DP

Grid Ref. 7050 5614

Map Number BA 19/26

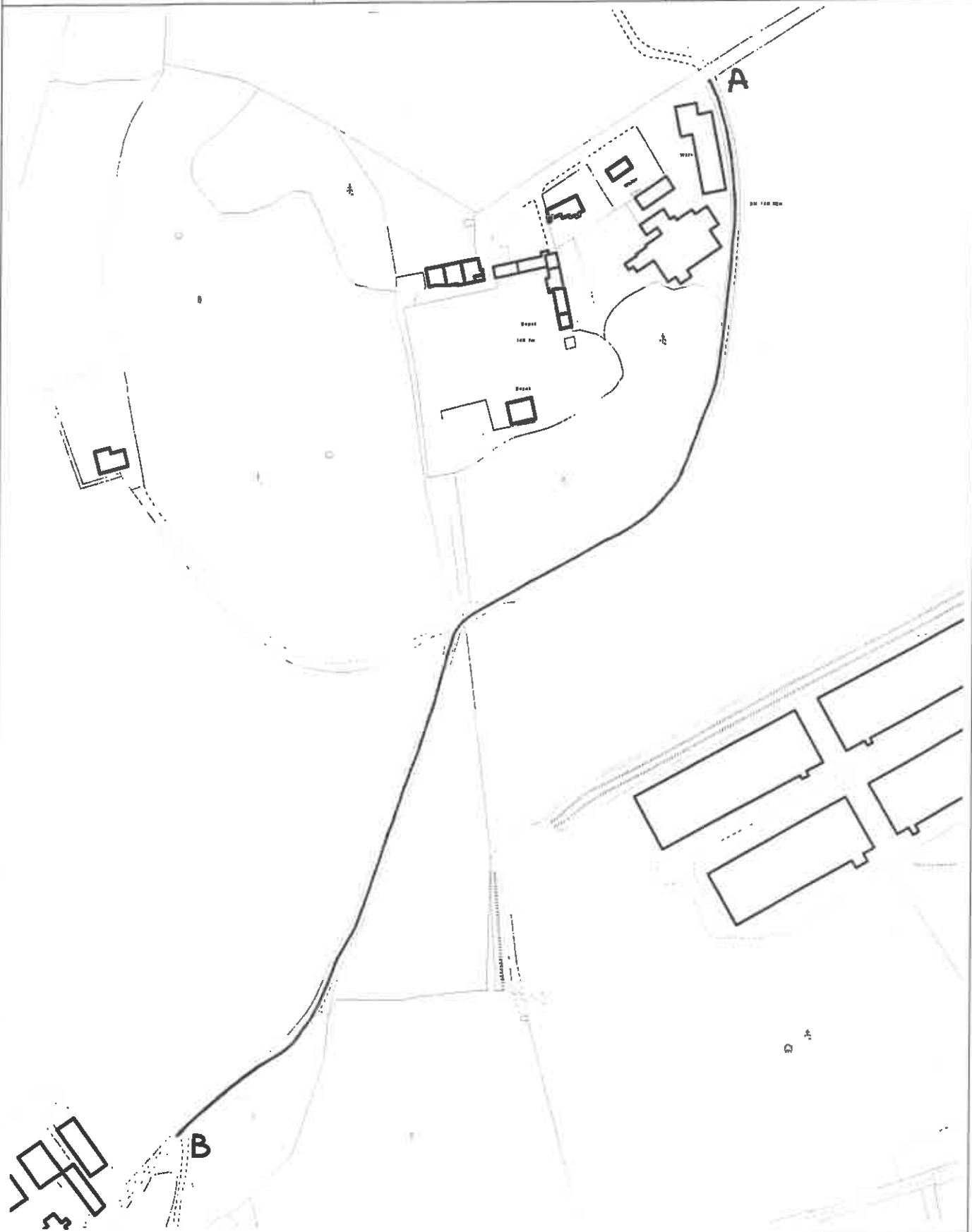

Scale 1:2500



Original path ———
Extinguished - - - - -

The material contained in this plot has been reproduced from an Ordnance Survey Map with permission of Her Majesty's Stationary Office. Copyright Licence No: LA09054L

Wildlife and Countryside Act 1981
BATH & NORTH EAST SOMERSET DISTRICT COUNCIL
 (Former Bathavon Rural District Area) (No. 1)
 Definitive Map and Statement Modification Order 1999

Strategic Policy
 Trimbridge House
 Trim Street
 BATH BA1 2DP

Grid Ref. 7123 5782

Map Number BA 19/32

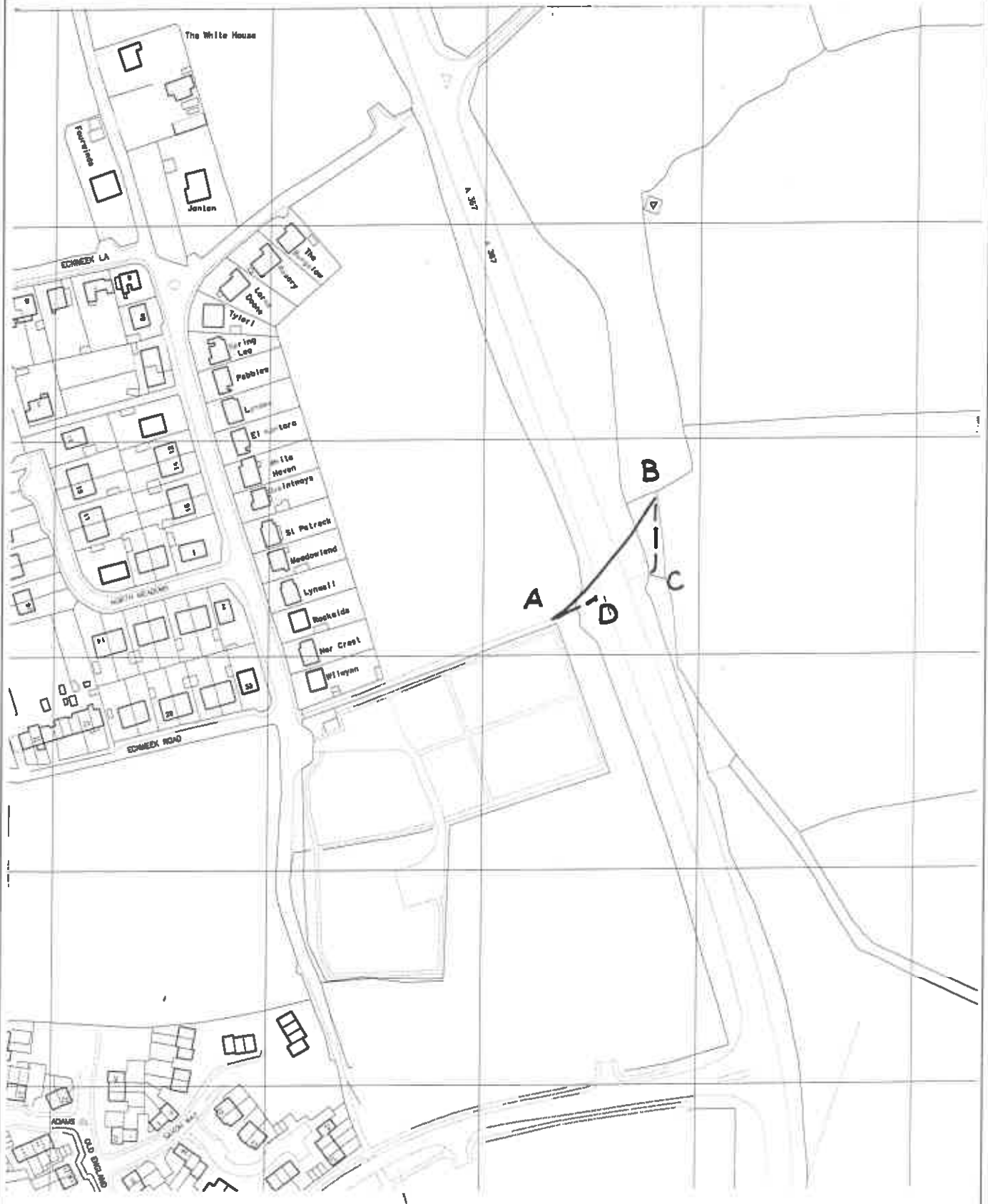

Scale 1:2500



Original path 
 Modified path 

The material contained in this plot has been reproduced from an Ordnance Survey Map with permission of Her Majesty's Stationary Office. Copyright Licence No: LA09054L

Wildlife and Countryside Act 1981
BATH & NORTH EAST SOMERSET DISTRICT COUNCIL
 (Former Bathavon Rural District Area) (No. 1)
 Definitive Map and Statement Modification Order 1999

Strategic Policy
Trimbridge House
Trim Street
BATH BA1 2DP

Grid Ref. 7123 5782

Map Number BA 19/33

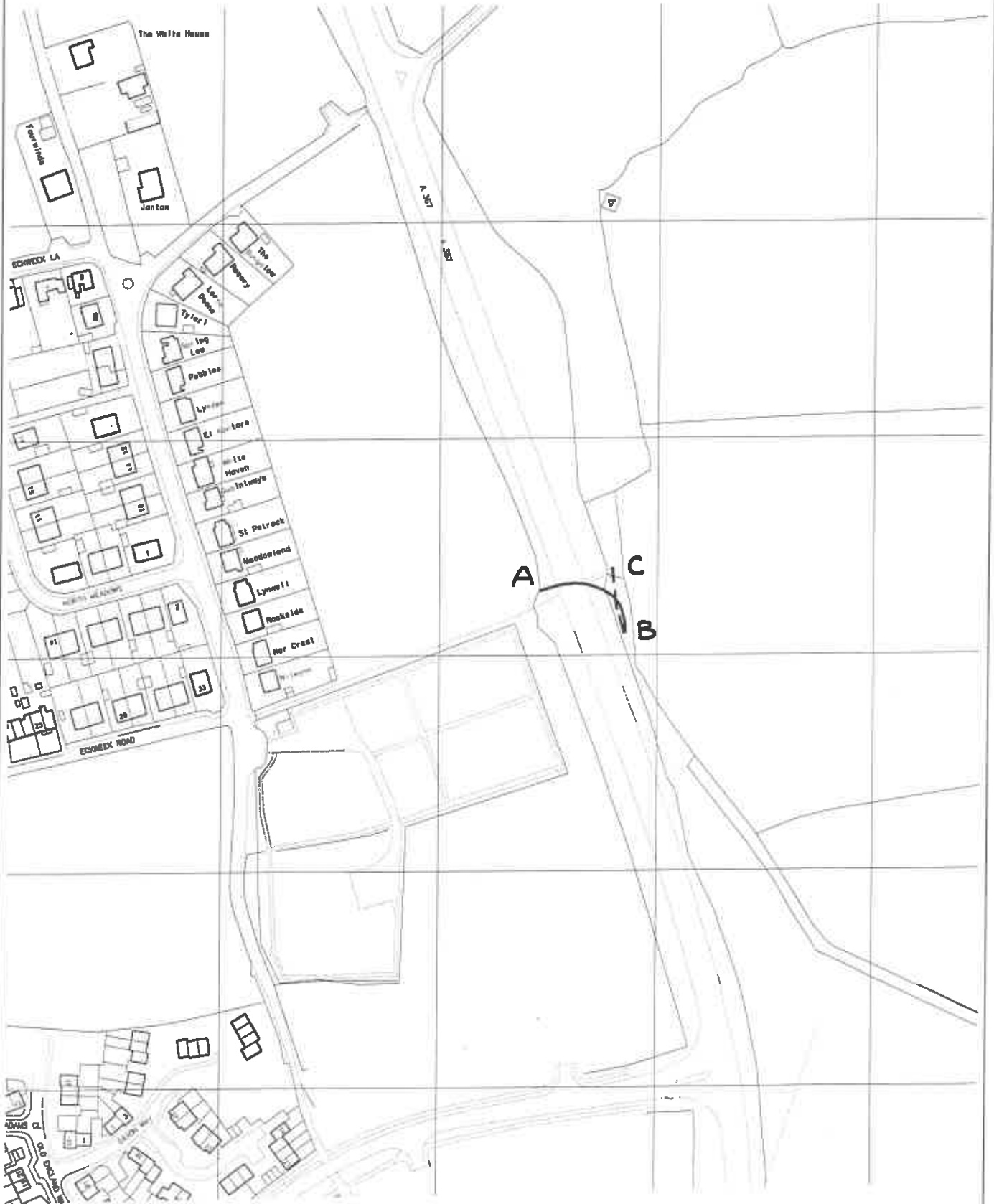

Scale 1:2500



Original path —————
 Modified path - - - - -

The material contained in this plot has been reproduced from an Ordnance Survey Map with permission of Her Majesty's Stationary Office. Copyright Licence No: LA09054L

Wildlife and Countryside Act 1981
BATH & NORTH EAST SOMERSET DISTRICT COUNCIL
 (Former Bathavon Rural District Area) (No. 1)
 Definitive Map and Statement Modification Order 1999

Strategic Policy
 Trimbridge House
 Trim Street
 BATH BA1 2DP

Grid Ref. 7078 5739

Map Number BA 19/35-1



Scale 1:2500



Original path 
 Extinguished 

The material contained in this plot has been reproduced from an Ordnance Survey Map with permission of Her Majesty's Stationary Office.
 Copyright Licence No: LA09054L

Wildlife and Countryside Act 1981
BATH & NORTH EAST SOMERSET DISTRICT COUNCIL
(Former Bathavon Rural District Area) (No. 1)
Definitive Map and Statement Modification Order 1999

Strategic Policy
Trimbridge House
Trim Street
BATH BA1 2DP



Grid Ref. 7093 5745

Map Number BA 19/35-2



Scale 1:2500



Original path 
Modified path  31

The material contained in this plot has been reproduced from an Ordnance Survey Map with permission of Her Majesty's Stationary Office. Copyright Licence No: LA09054L

Wildlife and Countryside Act 1981
BATH & NORTH EAST SOMERSET DISTRICT COUNCIL
 (Former Bathavon Rural District Area) (No. 1)
 Definitive Map and Statement Modification Order 1999

OMA27
Strategic Policy
 Trimbridge House
 Trim Street
 BATH BA1 2DP

Grid Ref. 6861 6140

Map Number BA 20/12

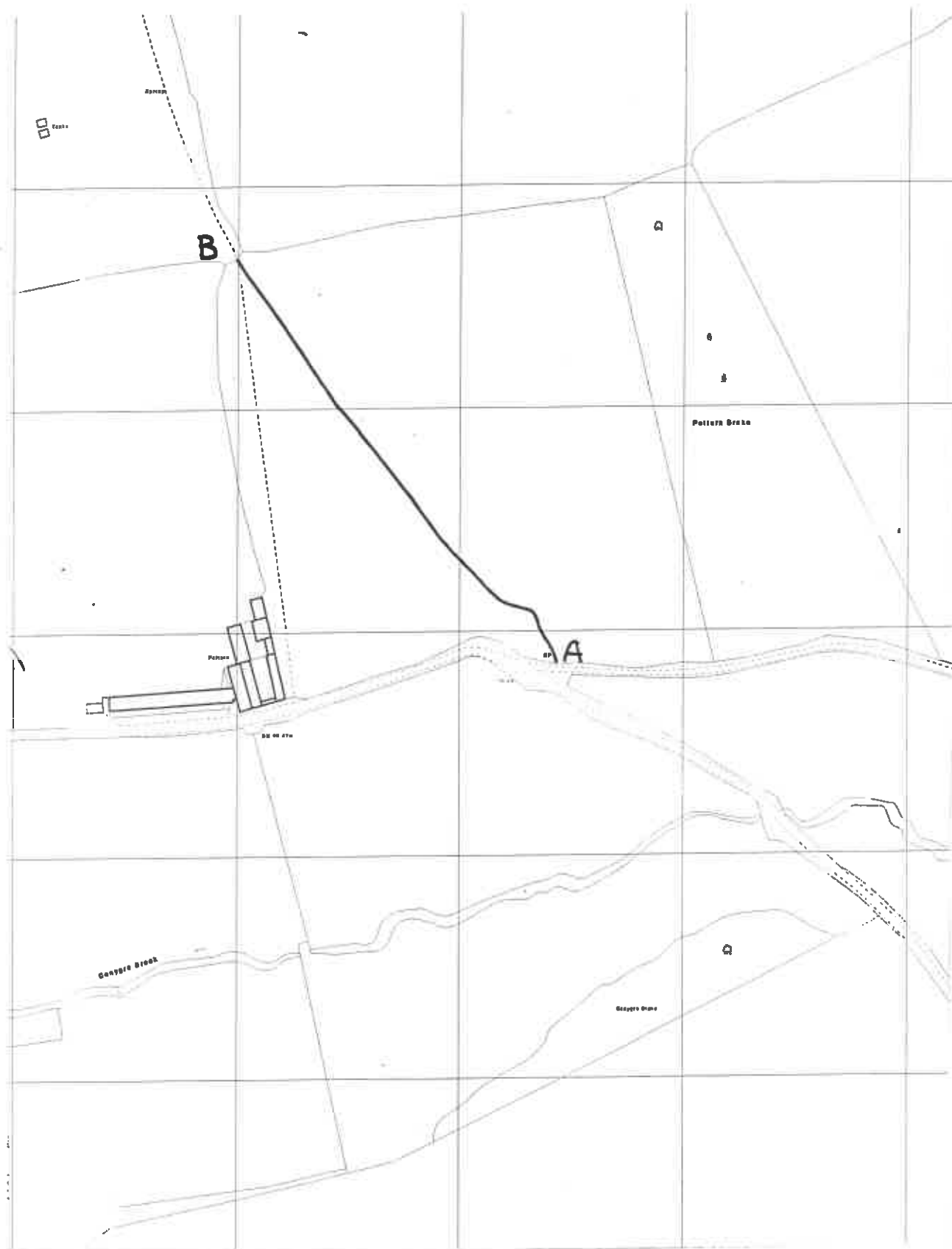

Scale 1:2500



Original path ———
 Extinguished - - - - -

The material contained in this plot has been reproduced from an Ordnance Survey Map with permission of Her Majesty's Stationary Office. Copyright Licence No: LA09054L

**PUBLIC PATH DIVERSION ORDER
HIGHWAYS ACT 1980**

BATH AND NORTH EAST SOMERSET COUNCIL

**BATH AND NORTH EAST SOMERSET COUNCIL
(PUBLIC FOOTPATH BA19/22 SKYLARK FARM, PEASEDOWN ST JOHN)
PUBLIC PATH DIVERSION ORDER 2017**

This order is made by Bath and North East Somerset Council ("the authority") under section 119 of the Highways Act 1980 ("the 1980 Act") because it appears to the authority that in the interests of the owner of the land crossed by the footpath described in paragraph 1 of this order it is expedient that the line of the path should be diverted.

Faccenda Foods Limited has agreed to defray any expenses which are incurred in bringing the new site of the path into a fit condition for use by the public.

BY THIS ORDER:

1. The public right of way over the land situated at Skylark Farm, Peasedown St John and shown by a bold continuous line on the map contained in this order and described in Part 1 of the Schedule to this order shall be stopped up from the date that the authority certifies that work has been carried out to bring the site of the new highway mentioned in Article 3 into a fit condition for use by the public.
2. No statutory undertakers rights are affected by this order.
3. There shall, on the date on which the authority certifies that the works to bring the new site of the path described in Part 2 of the Schedule into a fit condition for use by the public have been completed to the reasonable satisfaction of the authority, be a public footpath over the land situated at Skylark Farm, Peasedown St John described in Part 2 of the Schedule and shown by a bold broken line on the map attached to this order.
4. The rights conferred on the public under this order shall be subject to the limitations and conditions set out in Part 3 of the Schedule.

Given under the Common Seal of the Bath and North East Somerset Council on the 1st March 2017

The COMMON SEAL of the
BATH AND NORTH EAST SOMERSET
COUNCIL

was hereunto affixed
in the presence of:-

Simon Barnes

Authorised signatory



In pursuance of its powers conferred by Schedule 6 to the Highways Act 1980, the Council hereby confirms the foregoing Order

The COMMON SEAL of the
BATH AND NORTH EAST SOMERSET
COUNCIL

was hereunto affixed
this 20th day of September 2017
In the presence of:-

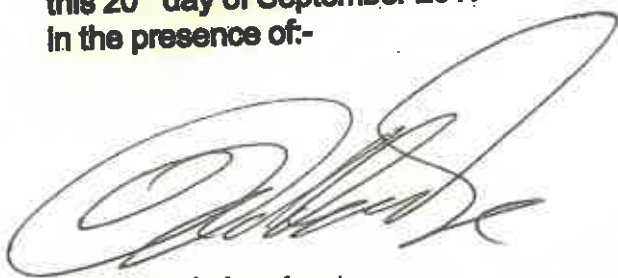

Authorised signatory

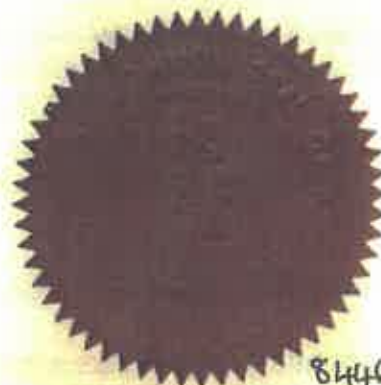

SCHEDULE**PART 1****DESCRIPTION OF SITE OF EXISTING PATH OR WAY**

The full width of that section of public footpath BA19/22 commencing from grid reference ST 7058 5577 (Point A on the Order Map) and continuing in a generally northerly direction for approximately 134 metres to the south of a field boundary at grid reference ST 7055 5590 (Point B on the Order Map).

PART 2**DESCRIPTION OF SITE OF NEW PATH OR WAY**

A section of public footpath commencing from grid reference ST 7058 5577 (Point A on the Order Map) and continuing in a generally north westerly direction for approximately 45 metres to grid reference ST 7055 5581 (Point C on the Order Map) and continuing in a generally northerly direction for approximately 94 metres to grid reference ST 7053 5589 (Point D on the Order Map) and continuing in a generally north easterly direction for approximately 20 metres to grid reference ST 7055 5590 (Point B on the Order Map).

Width: 2 metres between grid reference ST 7058 5577 (Point A on the Order Map) and grid reference ST 7055 5590 (Point B on the Order Map).

PART 3**LIMITATIONS**

None.

This Map forms part of the
Bath and North East Somerset Council
(Public Footpath BA19/22 Skylark Farm,
Peasedown St John)
Public Path Diversion Order 2017

Public footpath to be created
Unaffected public footpath
Public footpath to be stopped up

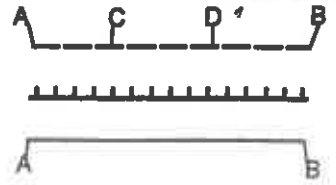

Scale: 1:1250

