

This map is based on Ordnance Survey material with the permission of the Controller of Her Majesty's Stationery Office Crown Copyright. Unauthorised reproduction infringes Crown Copyright and may lead to prosecution or civil proceedings. BATH AND NORTH EAST SOMERSET COUNCIL Licence No. 100023334

CROSSING VISIBILITY DISTANCES FROM T.S.M. Chapter 6 Table 15-1 30mph/40m
 SPEED READINGS TAKEN:
 SOUTHERN APPROACH - 85th %ile 28.6mph
 NORTHERN APPROACH - 85th %ile 29.52mph

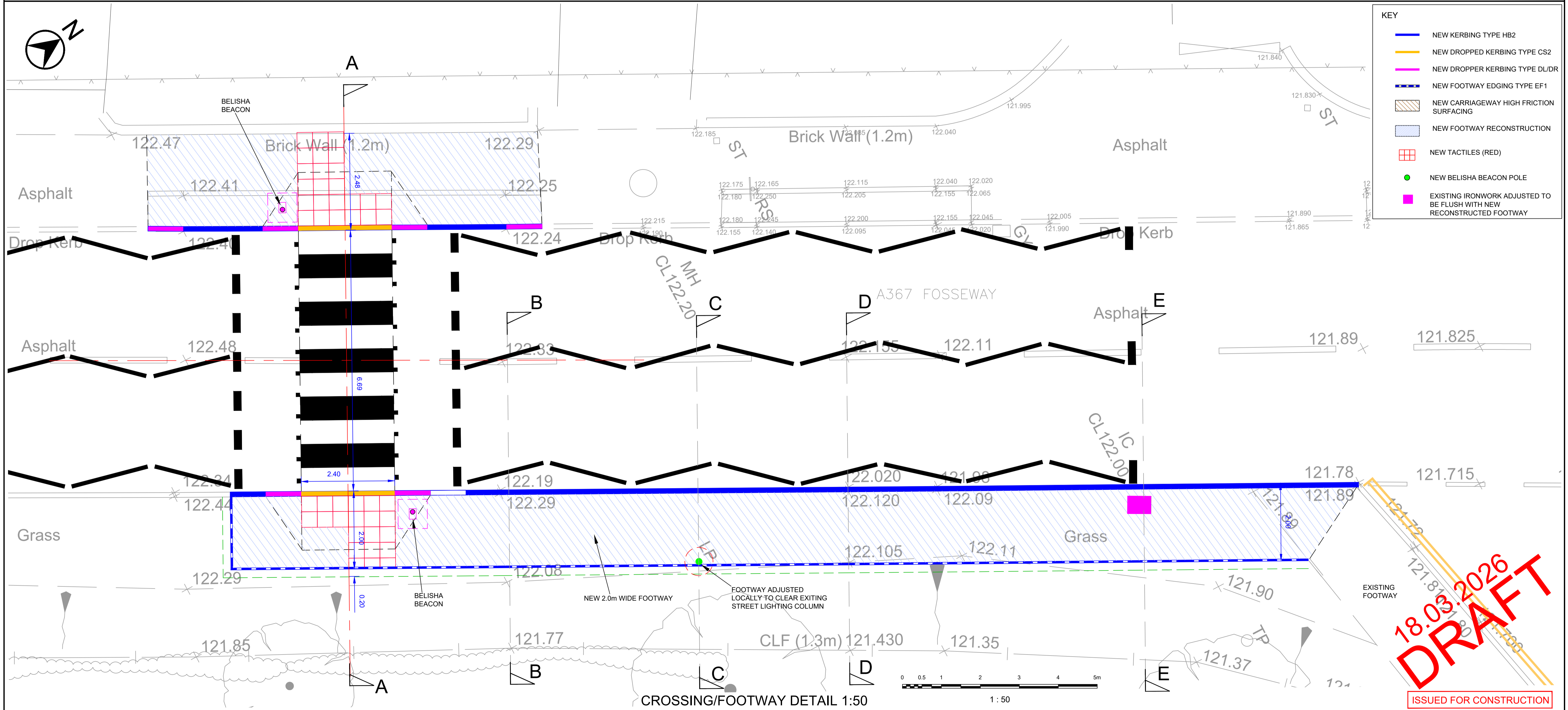
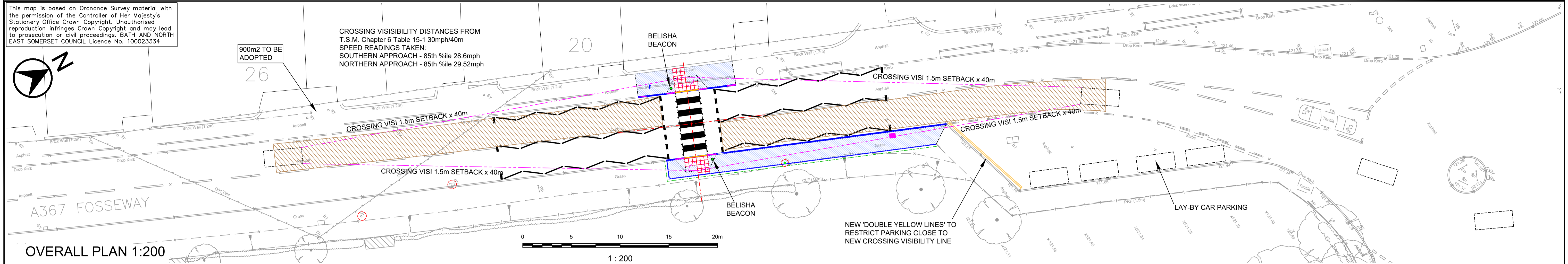

KEY

- NEW KERBING TYPE HB2
- NEW DROPPED KERBING TYPE CS2
- NEW DROPPER KERBING TYPE DL/DR
- - - NEW FOOTWAY EDGING TYPE EF1
- NEW CARRIAGEWAY HIGH FRICTION SURFACING
- NEW FOOTWAY RECONSTRUCTION
- NEW TACTILES (RED)
- NEW BELISHA BEACON POLE
- EXISTING IRONWORK ADJUSTED TO BE FLUSH WITH NEW RECONSTRUCTED FOOTWAY

DRAFT

18.03.2026

ISSUED FOR CONSTRUCTION

<p>Bath & North East Somerset Council</p> <p>PAUL GARROD Head of Highways Delivery Place Management</p>	PRODUCED BY	SCHEME TITLE	DRAWING TITLE	<table border="1" style="width: 100%; border-collapse: collapse;"> <tr> <td style="width: 15%;">DATE</td> <td>MAR 2026</td> <td style="width: 15%;">DRAWN BY</td> <td>TRH</td> <td style="width: 15%;">APPROVED BY</td> <td>SJF</td> </tr> <tr> <td>SCALE</td> <td>AsShown@A1</td> <td>CHECKED</td> <td>DMM</td> <td></td> <td></td> </tr> <tr> <td colspan="6">CLIENT REF. A367 FOSSEWAY SOUTH, MIDSOMER NORTON PEDESTRIAN CROSSING FACILITY ZEBRA CROSSING - GENERAL ARRANGEMENT</td> </tr> <tr> <td>DRAWING No.</td> <td colspan="4">TCN0001/02/100</td> <td>REV.</td> <td>-</td> </tr> </table>	DATE	MAR 2026	DRAWN BY	TRH	APPROVED BY	SJF	SCALE	AsShown@A1	CHECKED	DMM			CLIENT REF. A367 FOSSEWAY SOUTH, MIDSOMER NORTON PEDESTRIAN CROSSING FACILITY ZEBRA CROSSING - GENERAL ARRANGEMENT						DRAWING No.	TCN0001/02/100				REV.	-
	DATE	MAR 2026	DRAWN BY		TRH	APPROVED BY	SJF																						
	SCALE	AsShown@A1	CHECKED		DMM																								
CLIENT REF. A367 FOSSEWAY SOUTH, MIDSOMER NORTON PEDESTRIAN CROSSING FACILITY ZEBRA CROSSING - GENERAL ARRANGEMENT																													
DRAWING No.	TCN0001/02/100				REV.	-																							
DESIGN GROUP	A367 FOSSEWAY SOUTH MIDSOMER NORTON PEDESTRIAN CROSSING FACILITY	ZEBRA CROSSING GENERAL ARRANGEMENT	<table border="1" style="width: 100%; border-collapse: collapse;"> <tr> <td style="width: 15%;">REV.</td> <td style="width: 15%;">DATE</td> <td style="width: 40%;">REVISIONS</td> <td style="width: 10%;">DRWN.</td> <td style="width: 10%;">CHKD.</td> <td style="width: 10%;">APPROV.</td> </tr> <tr> <td>-</td> <td>18.03.26</td> <td>ISSUED FOR INFORMATION</td> <td>TRH</td> <td>DMM</td> <td>SJF</td> </tr> <tr> <td>-</td> <td>18.03.26</td> <td>FIRST DRAFT</td> <td>TRH</td> <td>DMM</td> <td>SJF</td> </tr> </table>	REV.	DATE	REVISIONS	DRWN.	CHKD.	APPROV.	-	18.03.26	ISSUED FOR INFORMATION	TRH	DMM	SJF	-	18.03.26	FIRST DRAFT	TRH	DMM	SJF								
REV.	DATE	REVISIONS	DRWN.	CHKD.	APPROV.																								
-	18.03.26	ISSUED FOR INFORMATION	TRH	DMM	SJF																								
-	18.03.26	FIRST DRAFT	TRH	DMM	SJF																								