

# ETRO Liveable Neighbourhood

Briefing – 10<sup>th</sup> October 2023

Lidia Derossi

# Charmouth Road

One Way ETRO

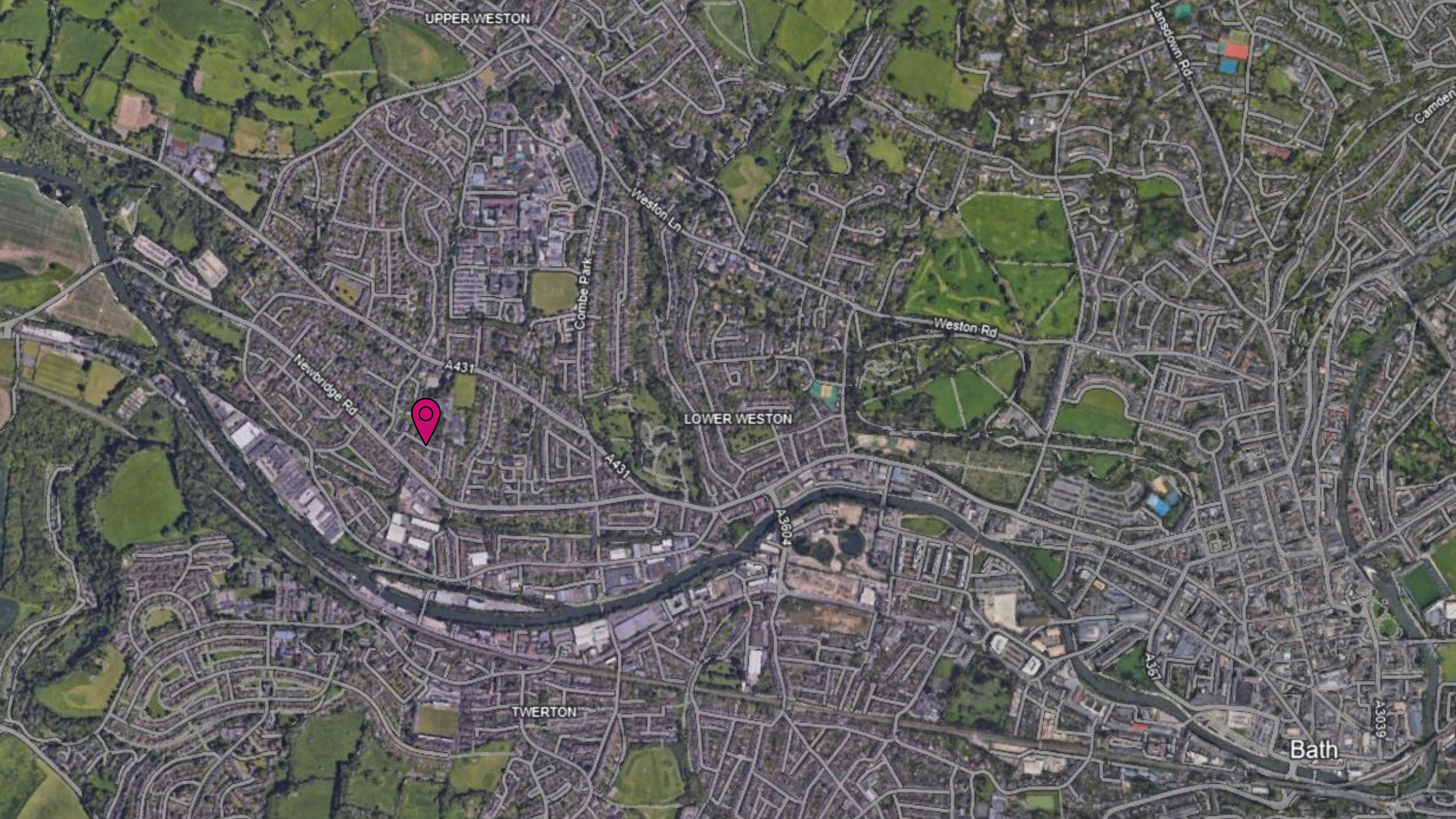

UPPER WESTON

Lansdown Rd

Camden

Weston Ln

Combe Park

Weston Rd

Newbridge Rd

A431

A431

LOWER WESTON

A3604

TWERTON

A397

A3039

Bath



Emmanuel Church,  
Apsley Road

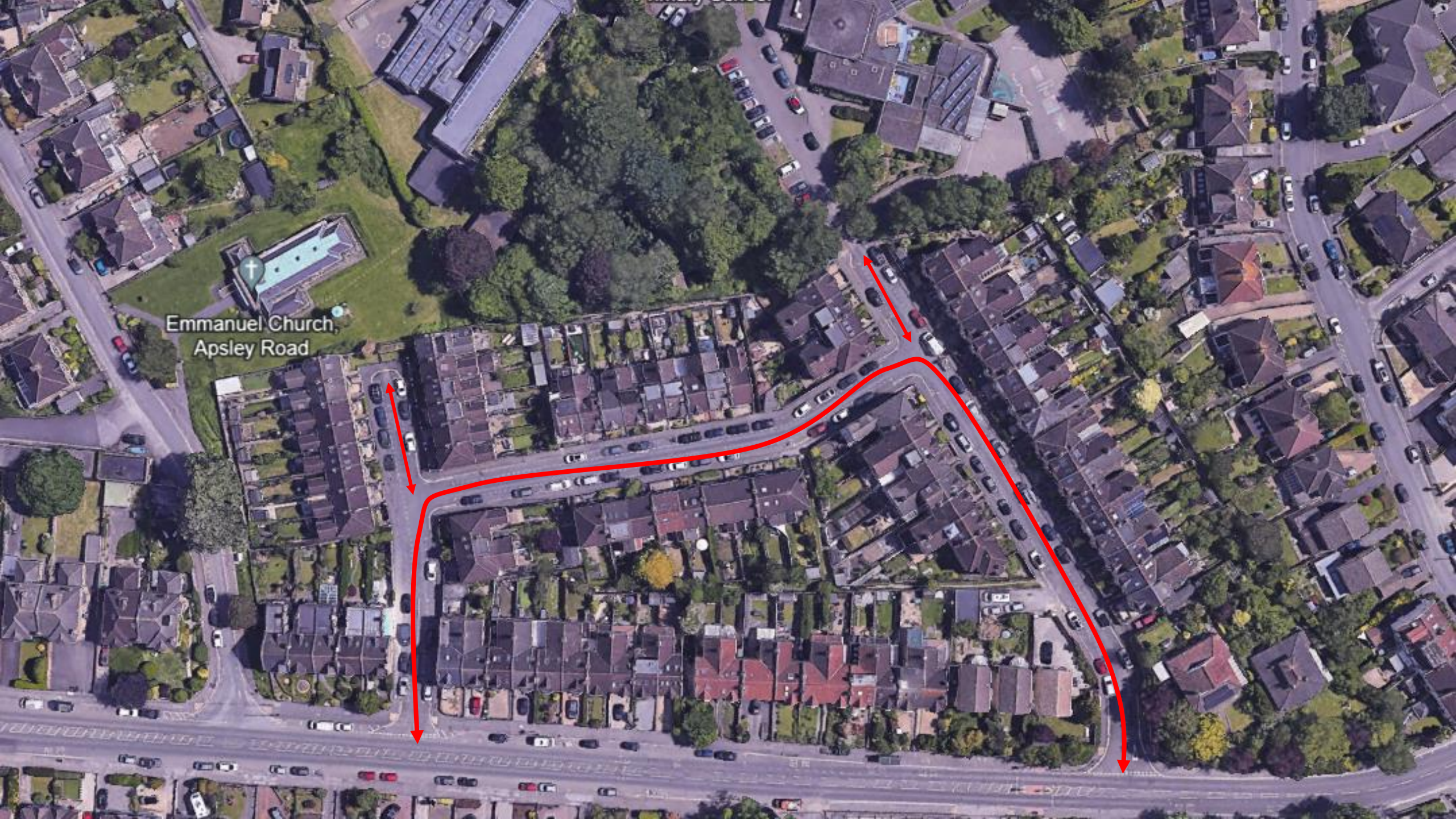

Emmanuel Church,  
Apsley Road



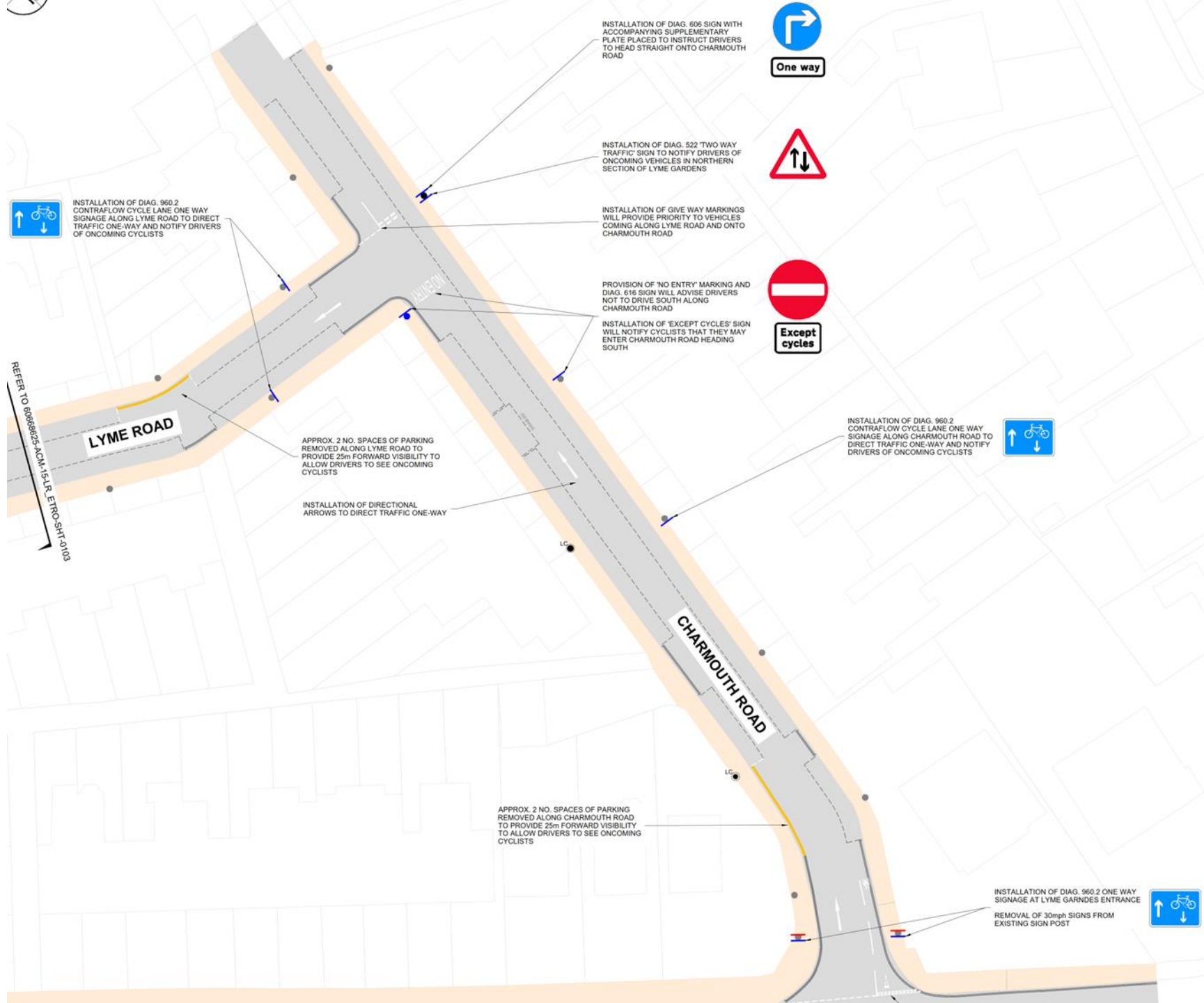

INSTALLATION OF DIAG. 606 SIGN WITH ACCOMPANYING SUPPLEMENTARY PLATE PLACED TO INSTRUCT DRIVERS TO HEAD STRAIGHT ONTO CHARMOUTH ROAD



INSTALLATION OF DIAG. 522 'TWO WAY TRAFFIC' SIGN TO NOTIFY DRIVERS OF ONCOMING VEHICLES IN NORTHERN SECTION OF LYME GARDENS



INSTALLATION OF GIVE WAY MARKINGS WILL PROVIDE PRIORITY TO VEHICLES COMING ALONG LYME ROAD AND ONTO CHARMOUTH ROAD

PROVISION OF 'NO ENTRY' MARKING AND DIAG. 616 SIGN WILL ADVISE DRIVERS NOT TO DRIVE SOUTH ALONG CHARMOUTH ROAD



INSTALLATION OF 'EXCEPT CYCLES' SIGN WILL NOTIFY CYCLISTS THAT THEY MAY ENTER CHARMOUTH ROAD HEADING SOUTH



INSTALLATION OF DIAG. 960.2 CONTRAFLOW CYCLE LANE ONE WAY SIGNAGE ALONG LYME ROAD TO DIRECT TRAFFIC ONE-WAY AND NOTIFY DRIVERS OF ONCOMING CYCLISTS

INSTALLATION OF DIAG. 960.2 CONTRAFLOW CYCLE LANE ONE WAY SIGNAGE ALONG CHARMOUTH ROAD TO DIRECT TRAFFIC ONE-WAY AND NOTIFY DRIVERS OF ONCOMING CYCLISTS



APPROX. 2 NO. SPACES OF PARKING REMOVED ALONG LYME ROAD TO PROVIDE 25m FORWARD VISIBILITY TO ALLOW DRIVERS TO SEE ONCOMING CYCLISTS

INSTALLATION OF DIRECTIONAL ARROWS TO DIRECT TRAFFIC ONE-WAY

APPROX. 2 NO. SPACES OF PARKING REMOVED ALONG CHARMOUTH ROAD TO PROVIDE 25m FORWARD VISIBILITY TO ALLOW DRIVERS TO SEE ONCOMING CYCLISTS

INSTALLATION OF DIAG. 960.2 ONE WAY SIGNAGE AT LYME GARNDES ENTRANCE  
REMOVAL OF 30mph SIGNS FROM EXISTING SIGN POST



REFER TO 60669625 ACM-15-LR-ETHRO-SHT-0103

LYME ROAD

CHARMOUTH ROAD

HILTON

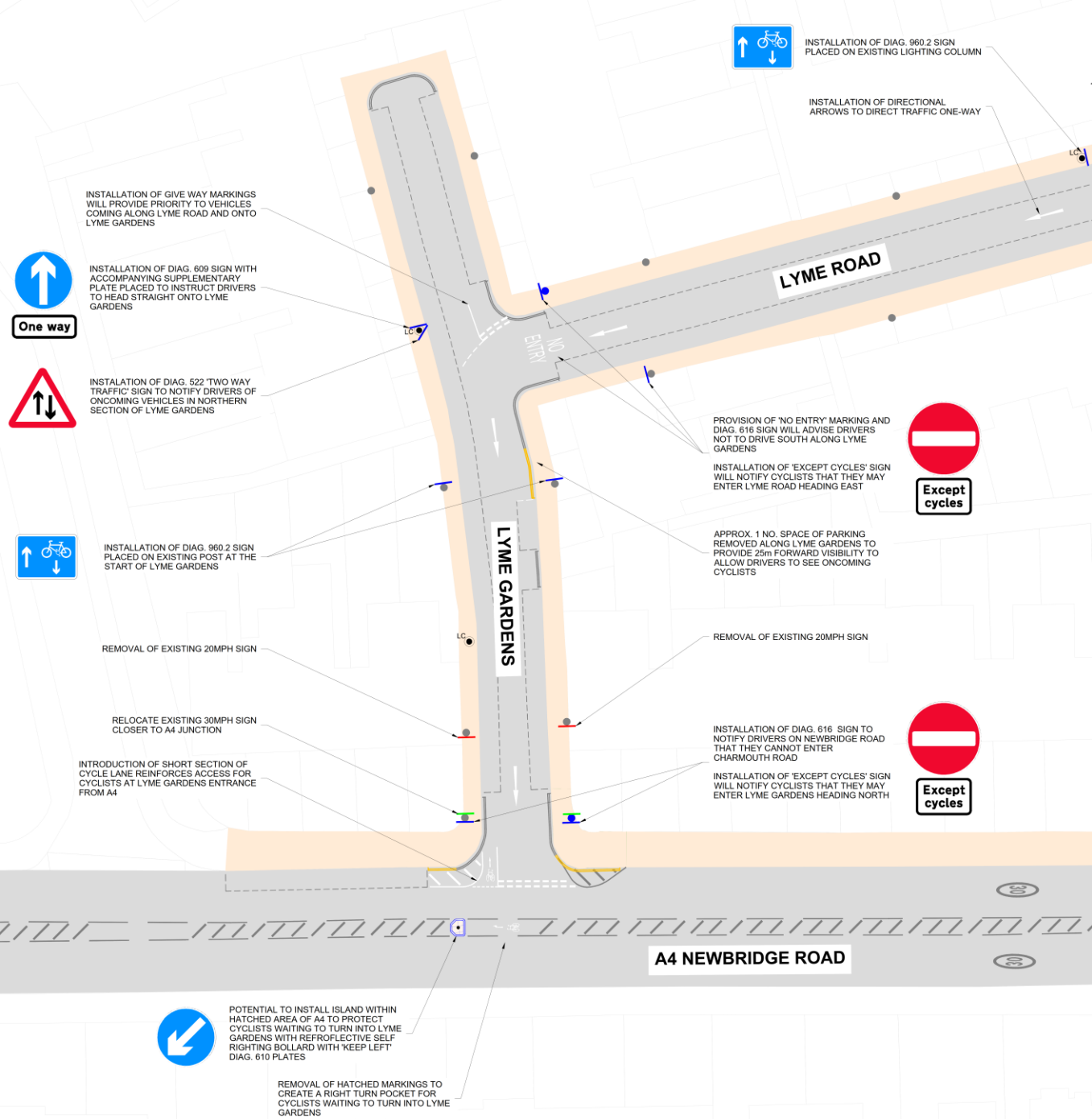

# New Sydney Place

Modal Filter ETRO



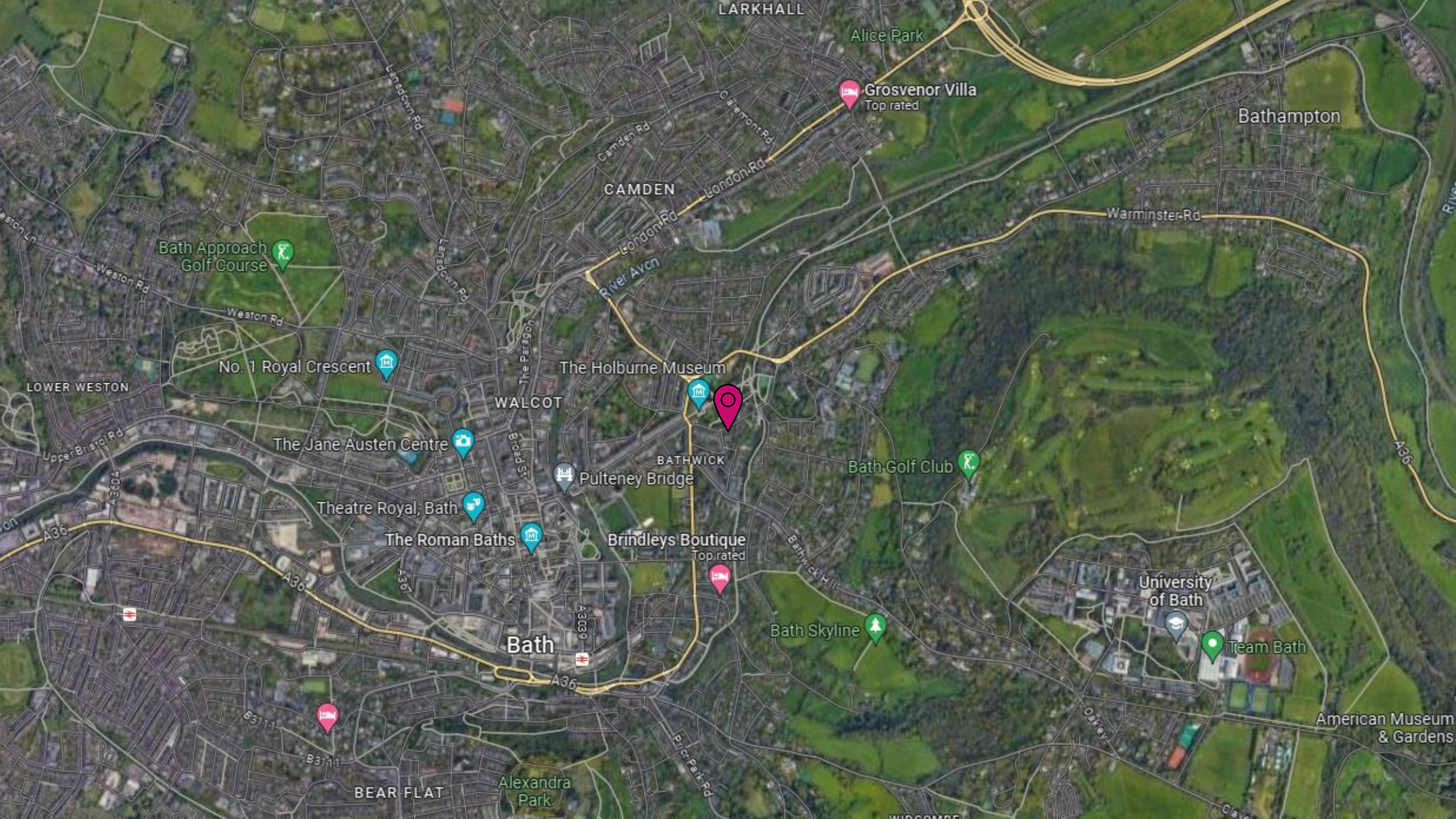

LARKHALL

Alice Park

Grosvenor Villa  
Top rated

Bathampton

CAMDEN

Bath Approach  
Golf Course

No. 1 Royal Crescent

The Holburne Museum

LOWER WESTON

WALCOT

The Jane Austen Centre

BATHWICK

Pulteney Bridge

Bath Golf Club

Theatre Royal, Bath

The Roman Baths

Brindleys Boutique  
Top rated

University  
of Bath

Bath

Bath Skyline

Team Bath

American Museum  
& Gardens

BEAR FLAT

Alexandra  
Park

WIDCOMBE

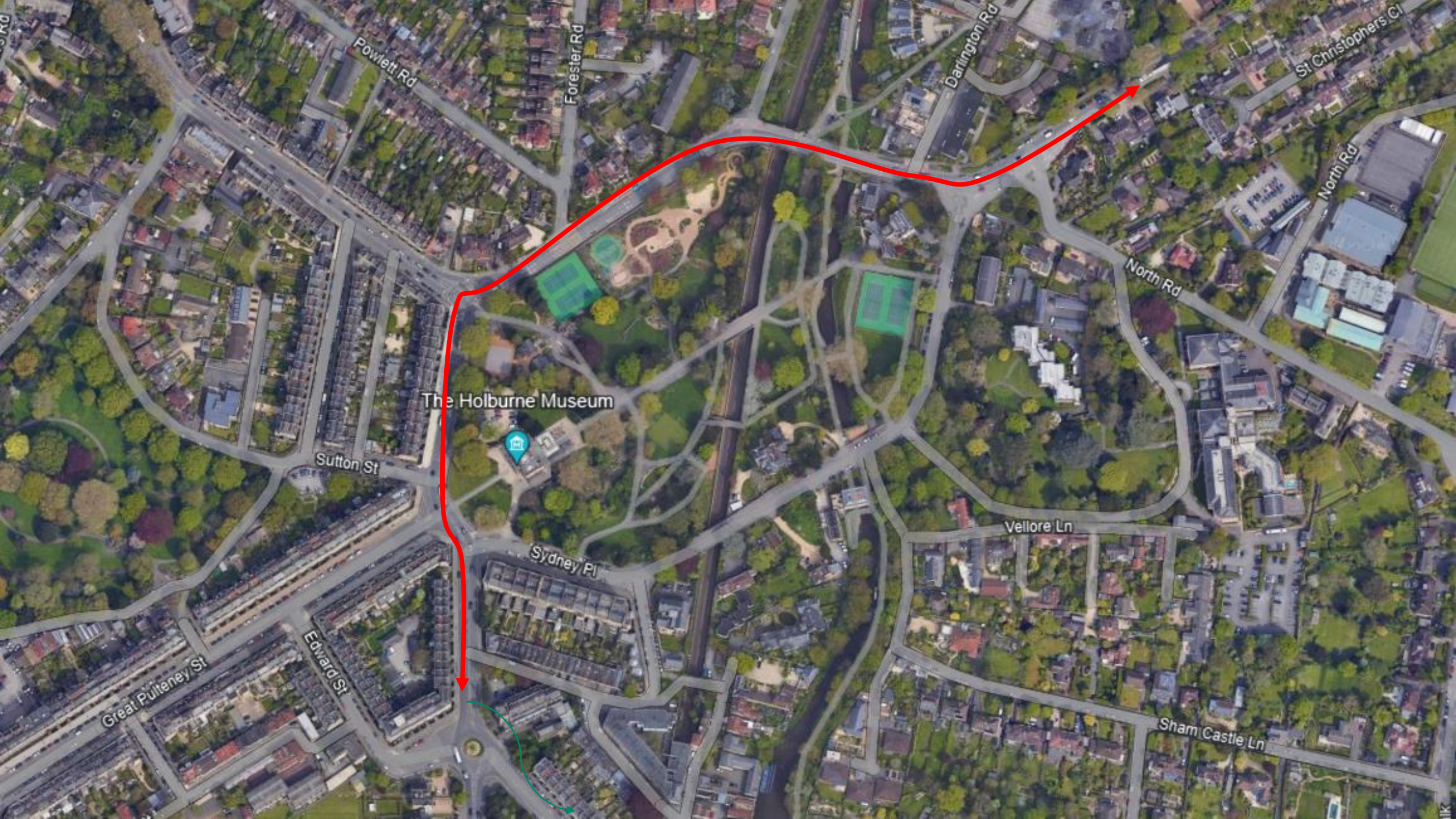

Powlett Rd

Forester Rd

Darlington Rd

St Christophers Ct

North Rd

North Rd

The Holburne Museum

Sutton St

Vellore Ln

Sydney Pl

Great Pulteney St

Edward St

Sham Castle Ln



Powlett Rd

Forester Rd

Darlington Rd

St Christophers Ct

North Rd

North Rd

The Holburne Museum

Sutton St

Vellore Ln

Sham Castle Ln

Sham Castle Ln

Edward St

Great Pulteney St

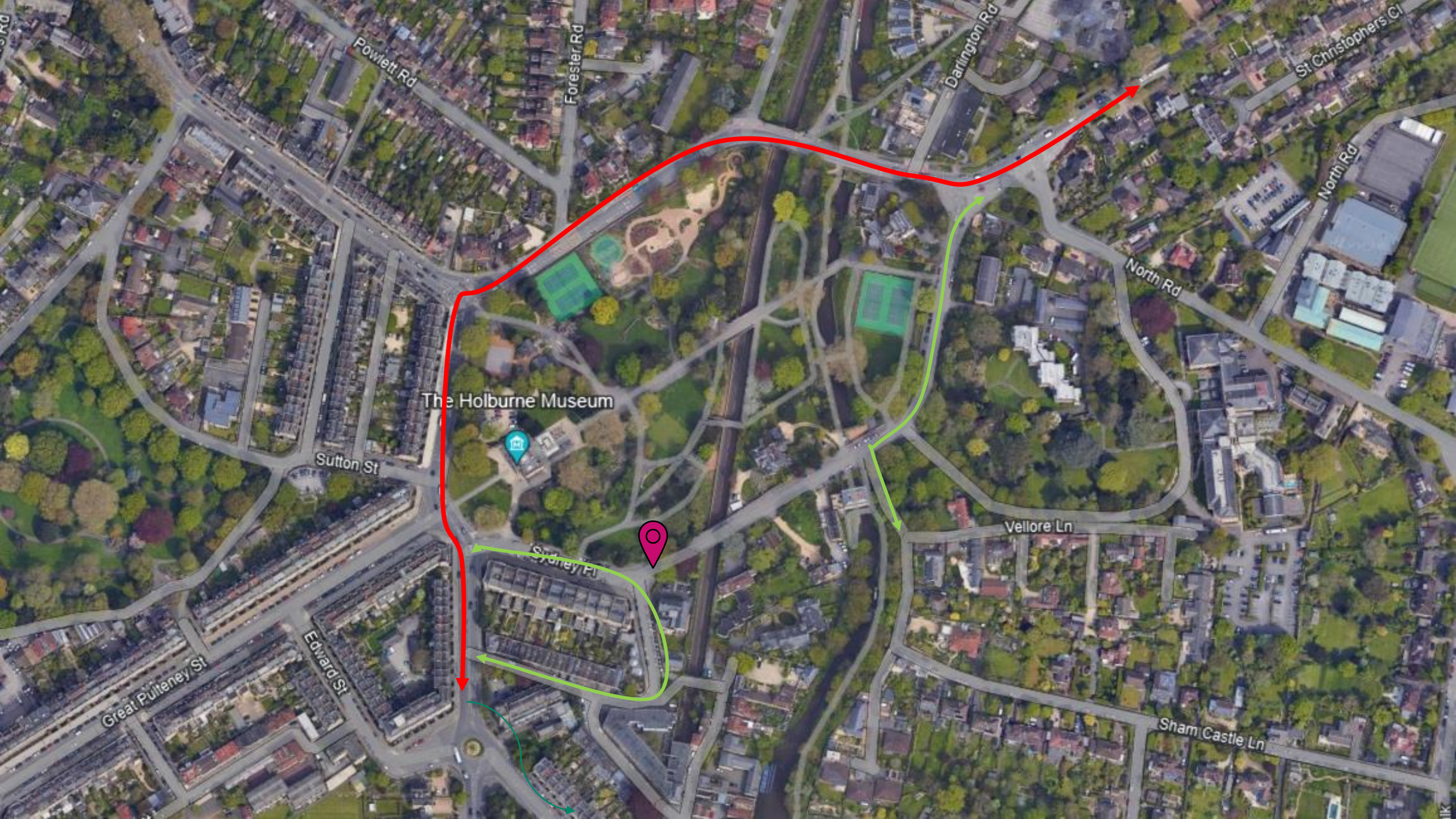

The Holburne Museum

Sutton St

Sydney Pl

Vellore Ln

Great Pulteney St

Edward St

Sham Castle Ln

St Christophers Ct

North Rd

North Rd

Darlington Rd

Forester Rd

Powlett Rd

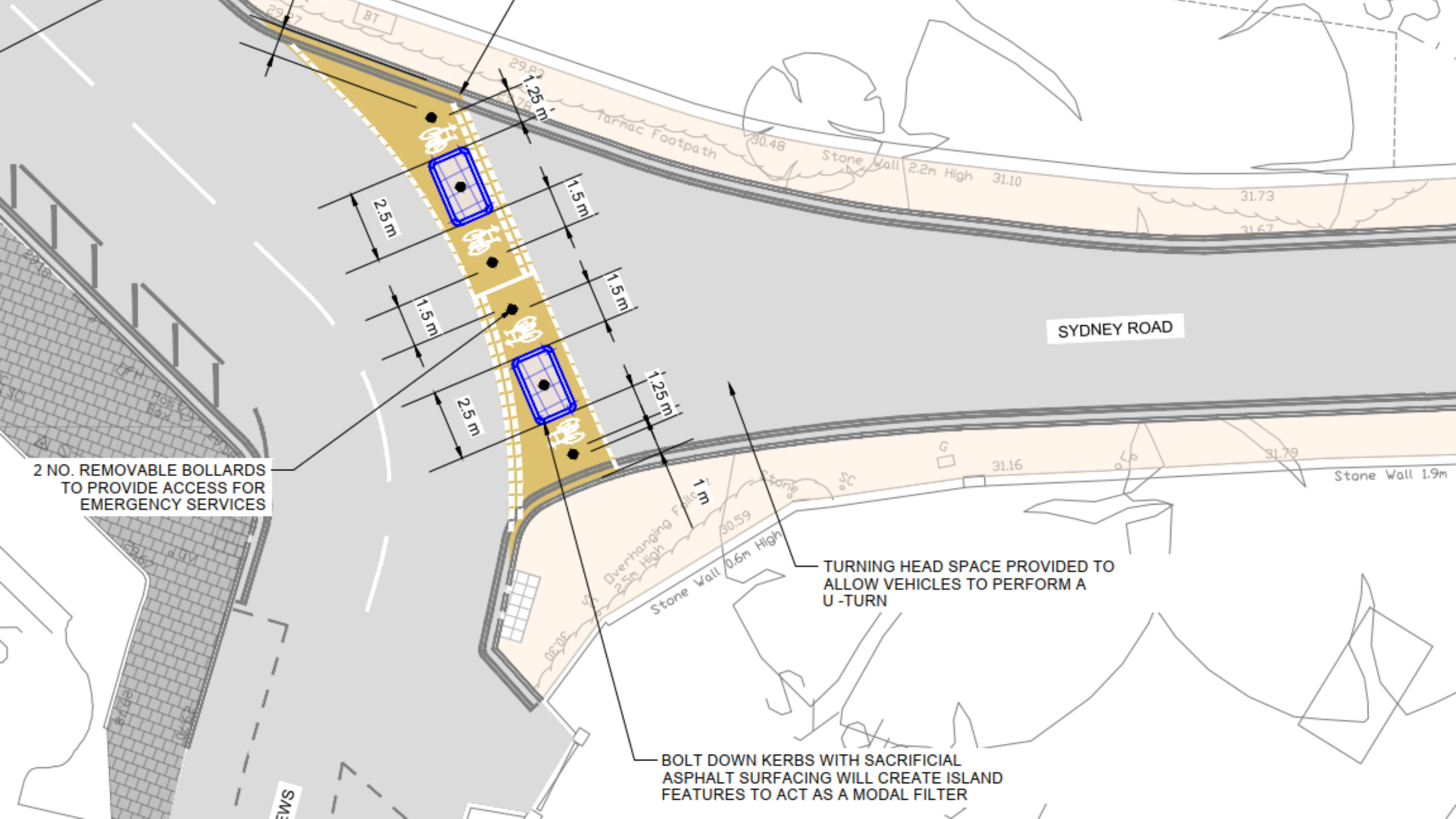

2 NO. REMOVABLE BOLLARDS TO PROVIDE ACCESS FOR EMERGENCY SERVICES

TURNING HEAD SPACE PROVIDED TO ALLOW VEHICLES TO PERFORM A U-TURN

BOLT DOWN KERBS WITH SACRIFICIAL ASPHALT SURFACING WILL CREATE ISLAND FEATURES TO ACT AS A MODAL FILTER

ADVANCED WARNING SIGNAGE OF NO THROUGH ROUTE ALONG SYDNEY GARDENS REFER TO INSET 1

RAISE EXISTING SIGNAL DUCTING ACCESS CHAMBER TO NEW ISLAND LEVEL

EXISTING SIGNAL LOOPS TO BE DISCONNECTED AND LEFT IN-SITU

PLANTERS AND OTHER STREET FURNITURE WOULD REVITALISE SPACE AND PROVIDE A PLACE FOR PEDESTRIANS TO REST

SIGNAL HEAD RELOCATED NORTH TOWARDS NEW KERBLINE

SIGNAGE TO INFORM DRIVERS THAT THERE IS NO THROUGH ROUTE TO A36 (DIAG NO. 816) WITH ACCOMPANYING PLATE

FORD ROAD

CLOSED WARNING WARMINSTER ROAD SYDNEY PLACE

CLOSED VEHICLES X/2024 MENTAL SCHEME

NGTON

Beckford Court

WARMINSTER ROAD

FOR MORE INFORMATION ON WARMINSTER ROAD REFER T

El Sub Sta

North Lodge

Redwa

PROPOSED BOLT DOWN KERBS WILL DIRECT TRAFFIC ALONG WARMINSTER ROAD AWAY FROM ISLAND BUILD OUT

POTENTIAL TO INFILL AREA OF RECLAIMED CARRIAGEWAY AND PROVIDE ADDITIONAL FOOTWAY SPACE

BOLT DOWN KERBING LAYOUT DOES NOT INTERFERE WITH EXISTING GULLY.

INTRODUCTION OF SURFACE MOUNTED TACTILE PAVING AT NORTH ROAD ISLAND DROPPED KERBS TO AID PEDESTRIANS CROSSING

BOLT DOWN KERBING LAYOUT DOES NOT INTERFERE WITH EXISTING GULLY

R6 m

R20 m

R20 m

3.7 m

3.2 m

3.9 m

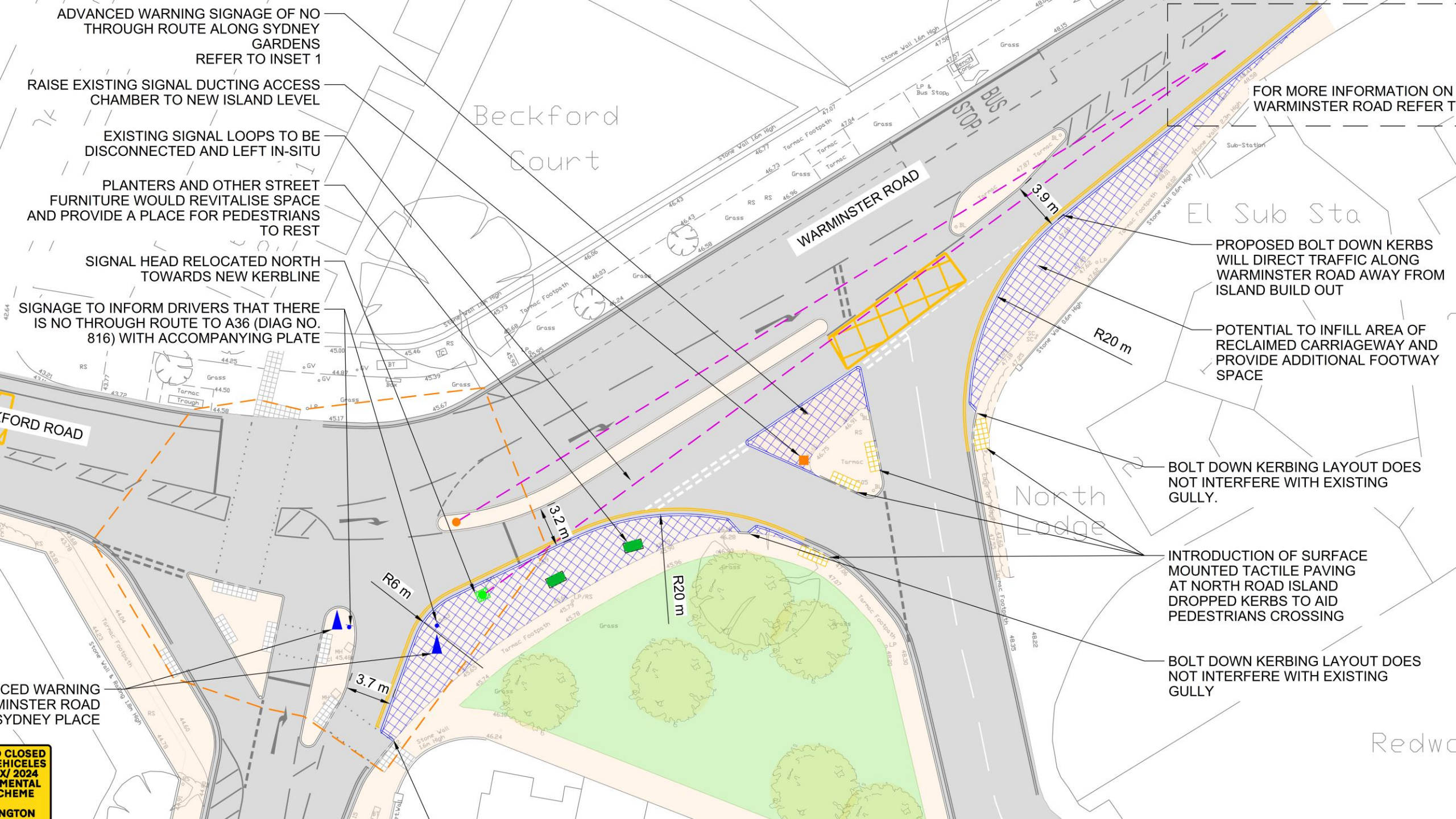

# Catherine Place

Modal Filter ETRO

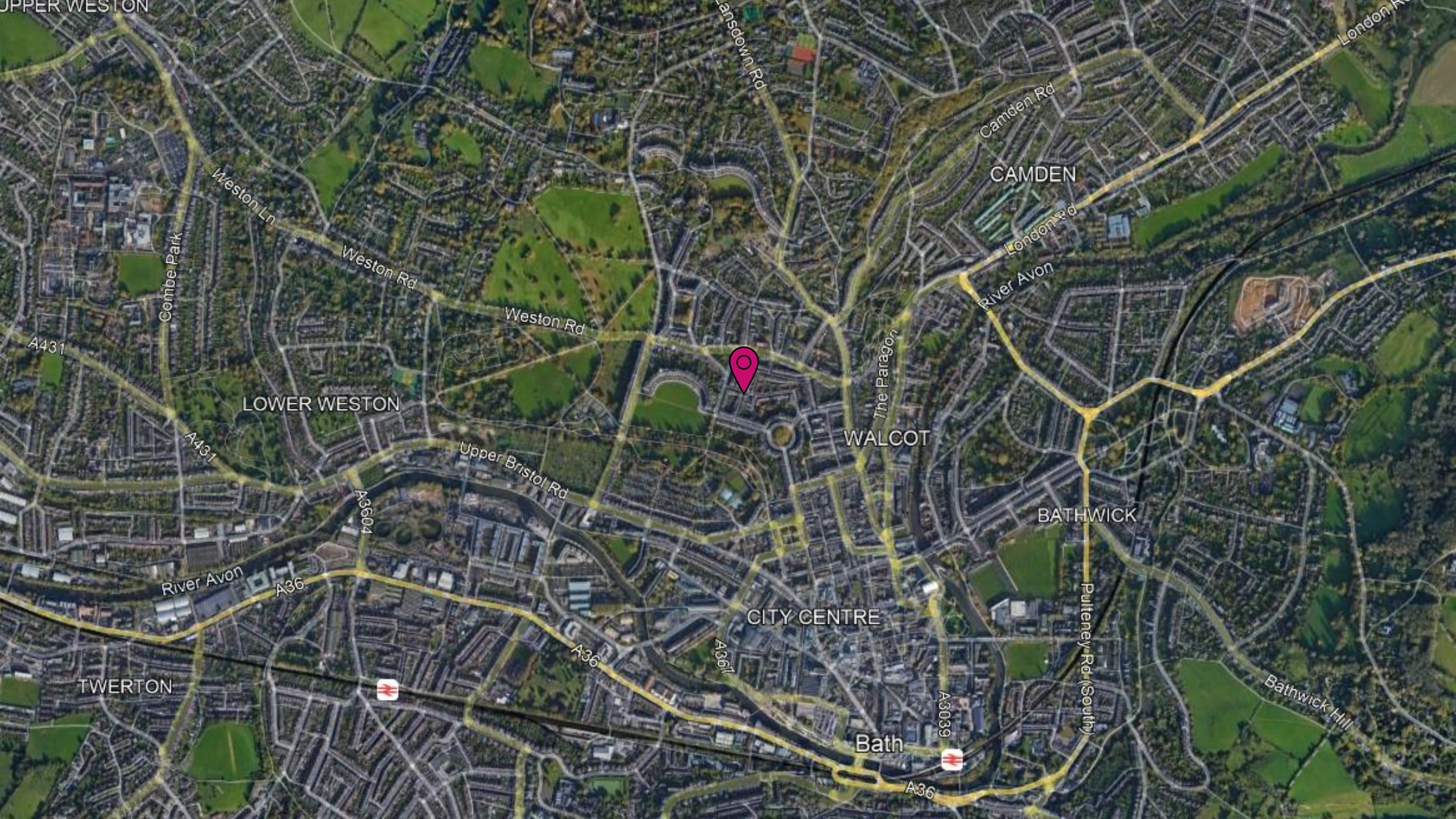

UPPER WESTON

A431

Combe Park

Weston Ln

Weston Rd

Weston Rd

LOWER WESTON

A431

K3604

Upper Bristol Rd

WALCOT

The Paragon

CAMDEN

River Avon

London Rd

BATHWICK

River Avon

A36

A36

CITY CENTRE

A3611

Pulteney Rd (South)

TWERTON



Bath

A3039



Bathwick Hill

A36



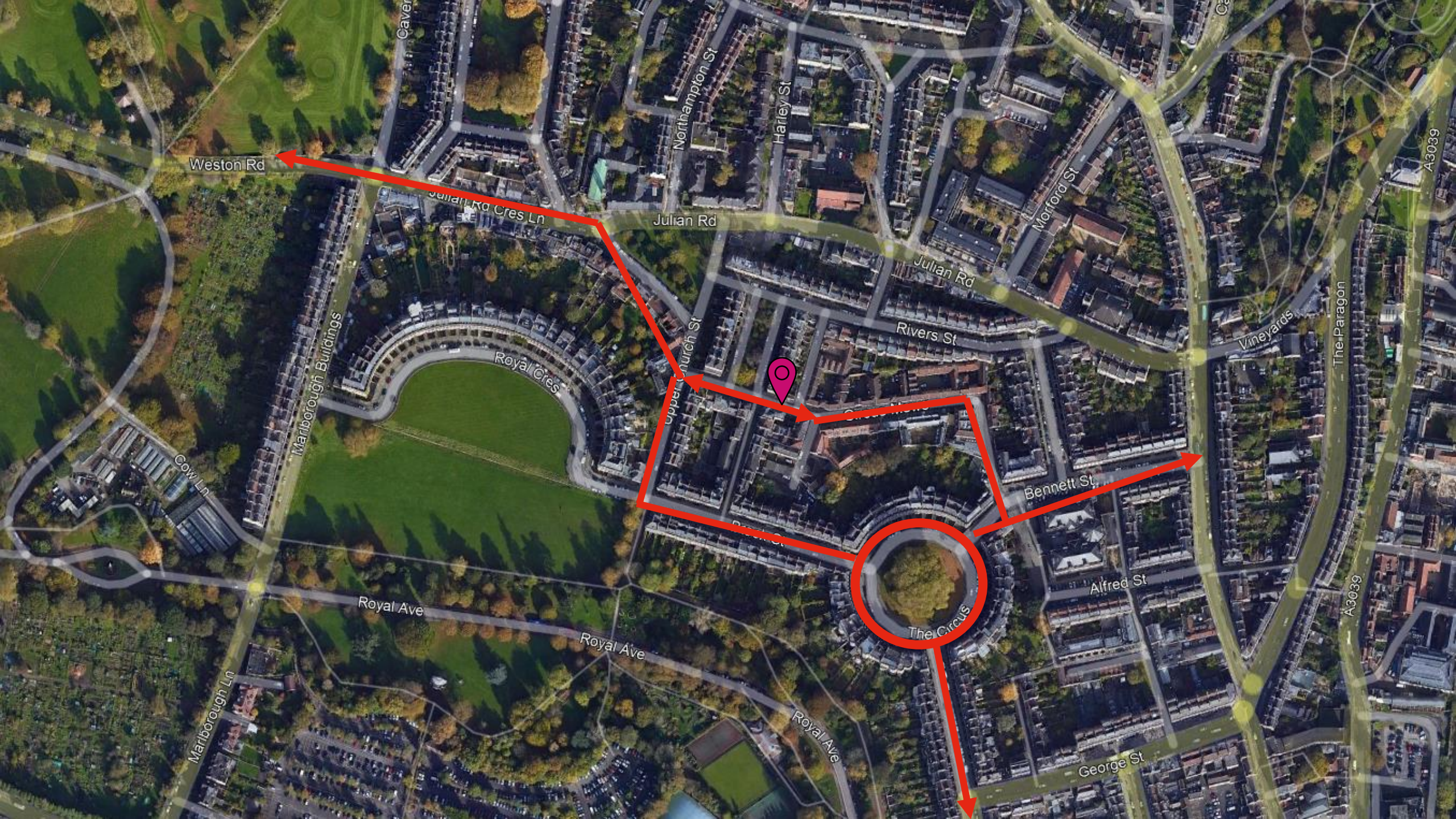

Weston Rd

Caver

Northampton St

Harley St

Julian Rd Cres Ln

Julian Rd

Julian Rd

Marford St

Marborough Buildings

Royal Cres

Uppert Church St

Rivers St

Vineyards

The Paragon

Cow Ln



Bennett St

Royal Ave

Royal Ave

Royal Ave

Alfred St

The Circus

George St

Marborough Ln

A3039

A3039

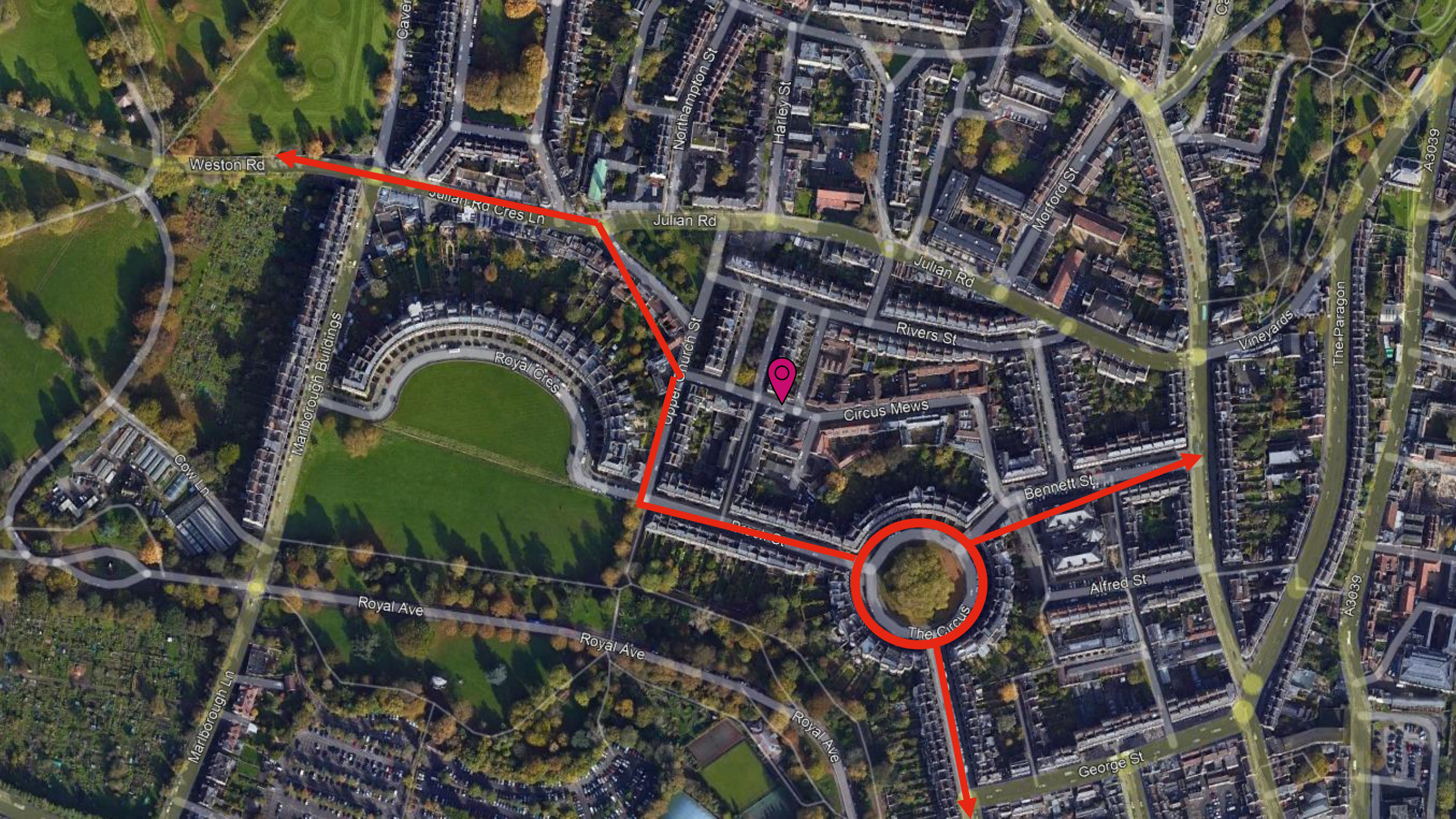

Weston Rd

Caver

Northampton St

Harley St

Julian Rd Cres Ln

Julian Rd

Julian Rd

Marford St

Marborough Buildings

Royal Cres

Upper Church St

Rivers St

Vineyards

The Paragon

Cow Ln

Circus Mews

Bennett St

Royal Ave

Royal Ave

Royal Ave

Alfred St

Marborough Ln

The Circus

George St

A3039

A3039

REMOVAL OF 1 NO. DUAL USE PARKING TO ALLOW ACCESS FOR REFUSE VEHICLE

CONTRACTOR TO HAND DIG TRIAL TRENCH TO DETERMINE DEPTH OF POTENTIAL CELLARS IN THE AREA AND OTHER BURIED SERVICES

LC

RIVERS STREET MEWS

3 m

MOUNT 2 NO. 'MOTOR VEHICLES PROHIBITED' (DIAG. 619) SIGNS ON NEW POST WITH 2 NO. ACCOMPANYING 'EXCEPT CYCLES' LEGENDS



2 NO. BOLT DOWN BOLLARDS WILL RESTRICT MOTORISED VEHICLE ACCESS

1 m  
1.5 m  
1 m

CIRCUS MEWS

REMOVAL OF 3 NO. RESIDENTS ONLY PARKING SPACES TO ALLOW ACCESS FOR REFUSE VEHICLE

# Gay Street

One way entry treatment ETRO

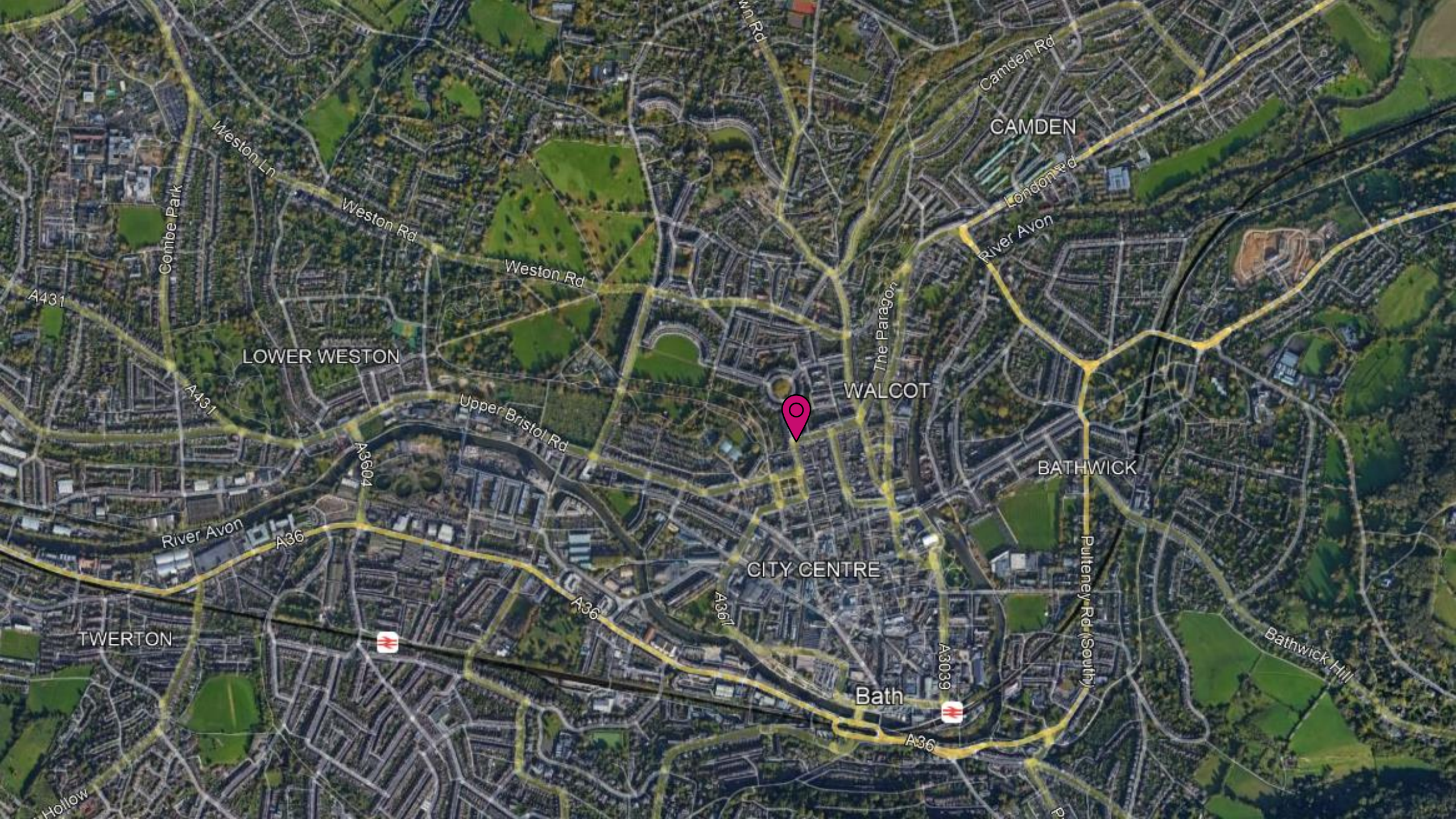

A431

Weston Ln

Combe Park

Weston Rd

Weston Rd

LOWER WESTON

A431

Upper Bristol Rd

A3604

River Avon

A36

TWERTON



CITY CENTRE

A36

A361

Bath



A36

A3039

WALCOT



The Paragon

CAMDEN

London Rd

River Avon

BATHWICK

Putney Rd (South)

Bathwick Hill

Hollow

p

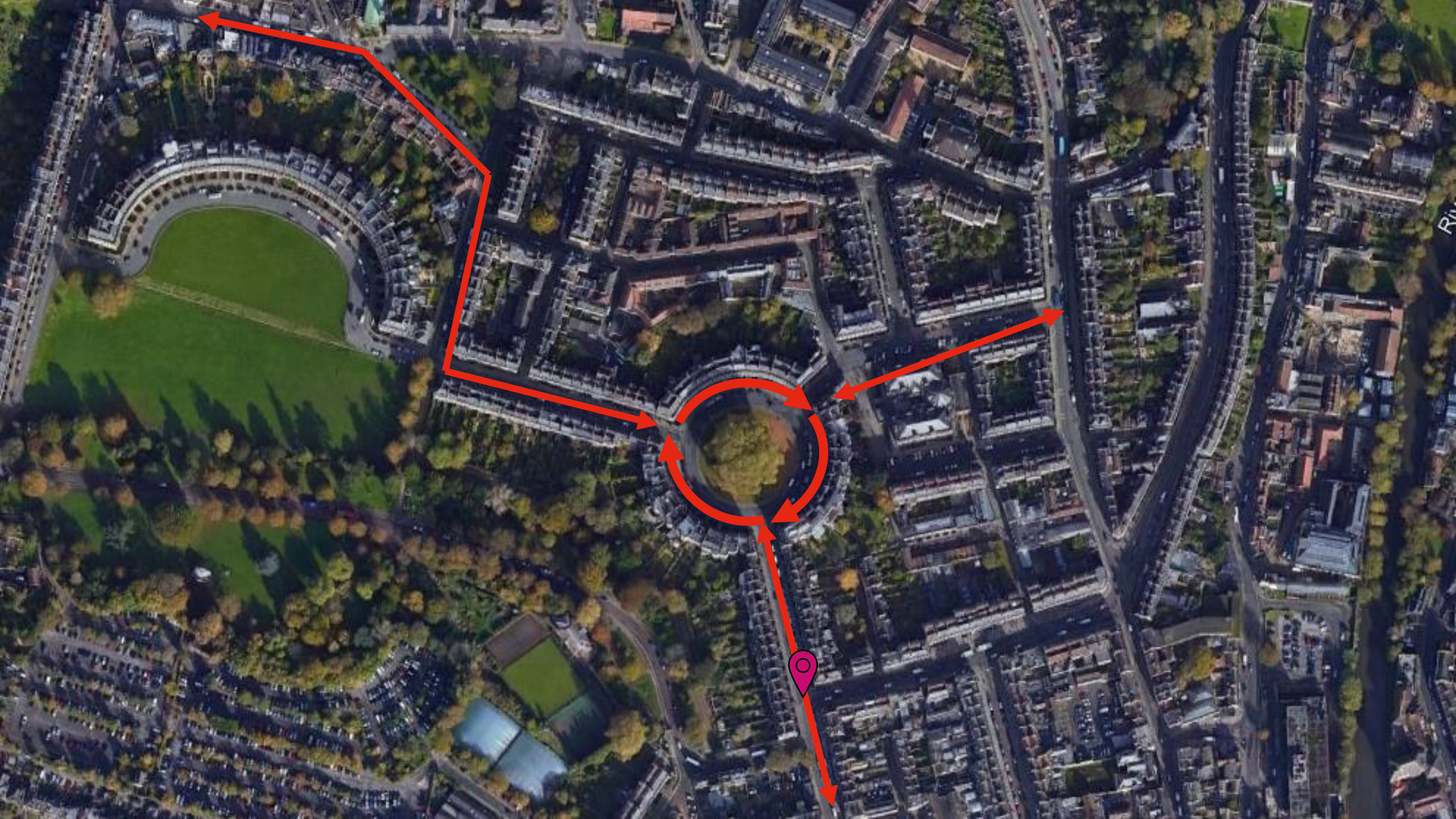



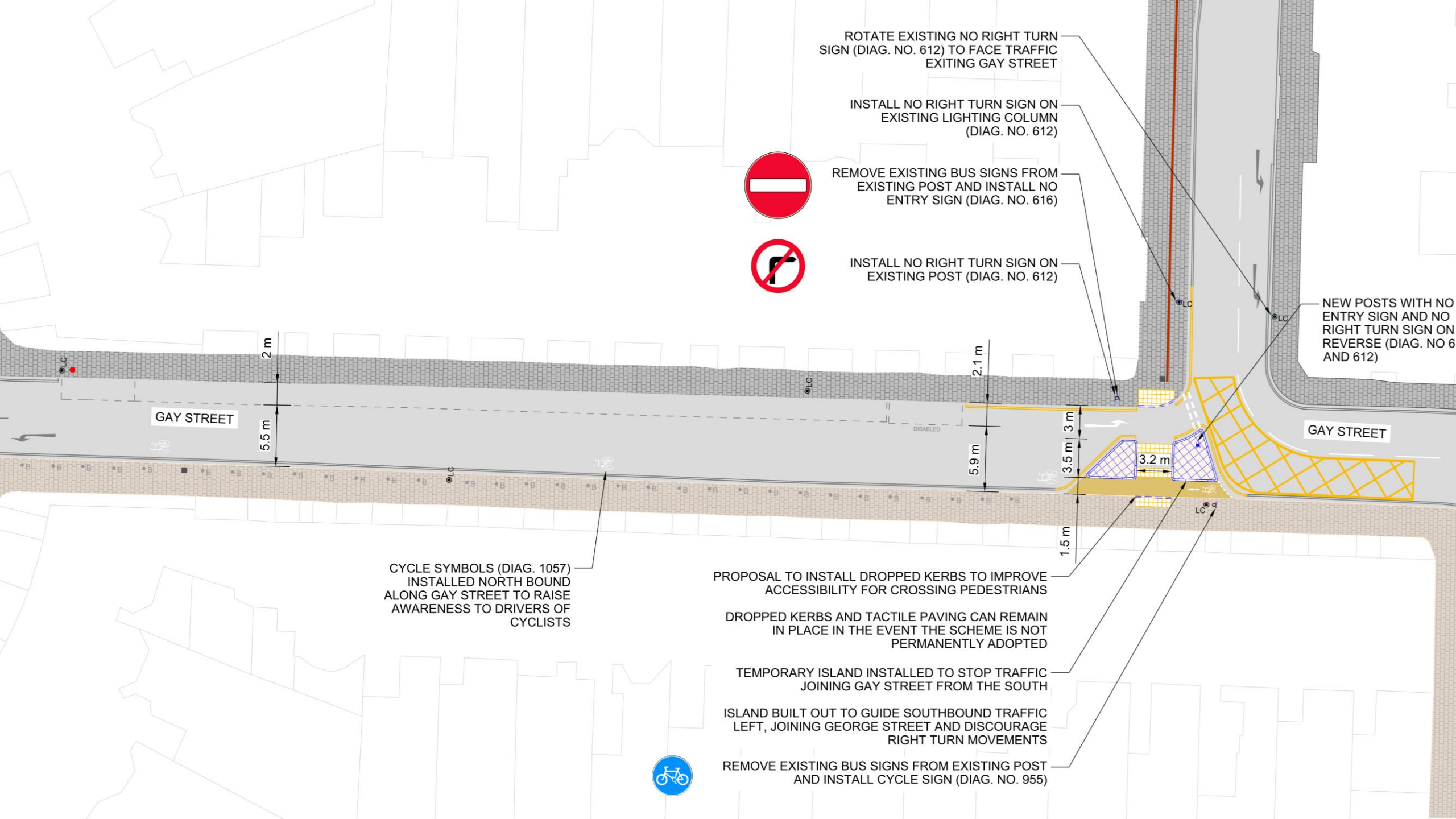

ROTATE EXISTING NO RIGHT TURN SIGN (DIAG. NO. 612) TO FACE TRAFFIC EXITING GAY STREET

INSTALL NO RIGHT TURN SIGN ON EXISTING LIGHTING COLUMN (DIAG. NO. 612)

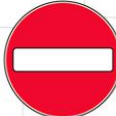

REMOVE EXISTING BUS SIGNS FROM EXISTING POST AND INSTALL NO ENTRY SIGN (DIAG. NO. 616)



INSTALL NO RIGHT TURN SIGN ON EXISTING POST (DIAG. NO. 612)

NEW POSTS WITH NO ENTRY SIGN AND NO RIGHT TURN SIGN ON REVERSE (DIAG. NO. 616 AND 612)

GAY STREET

GAY STREET

CYCLE SYMBOLS (DIAG. 1057) INSTALLED NORTH BOUND ALONG GAY STREET TO RAISE AWARENESS TO DRIVERS OF CYCLISTS

PROPOSAL TO INSTALL DROPPED KERBS TO IMPROVE ACCESSIBILITY FOR CROSSING PEDESTRIANS

DROPPED KERBS AND TACTILE PAVING CAN REMAIN IN PLACE IN THE EVENT THE SCHEME IS NOT PERMANENTLY ADOPTED

TEMPORARY ISLAND INSTALLED TO STOP TRAFFIC JOINING GAY STREET FROM THE SOUTH

ISLAND BUILT OUT TO GUIDE SOUTHBOUND TRAFFIC LEFT, JOINING GEORGE STREET AND DISCOURAGE RIGHT TURN MOVEMENTS

REMOVE EXISTING BUS SIGNS FROM EXISTING POST AND INSTALL CYCLE SIGN (DIAG. NO. 955)







# Winifred's Lane

Modal Filter / Bus Gate ETRO

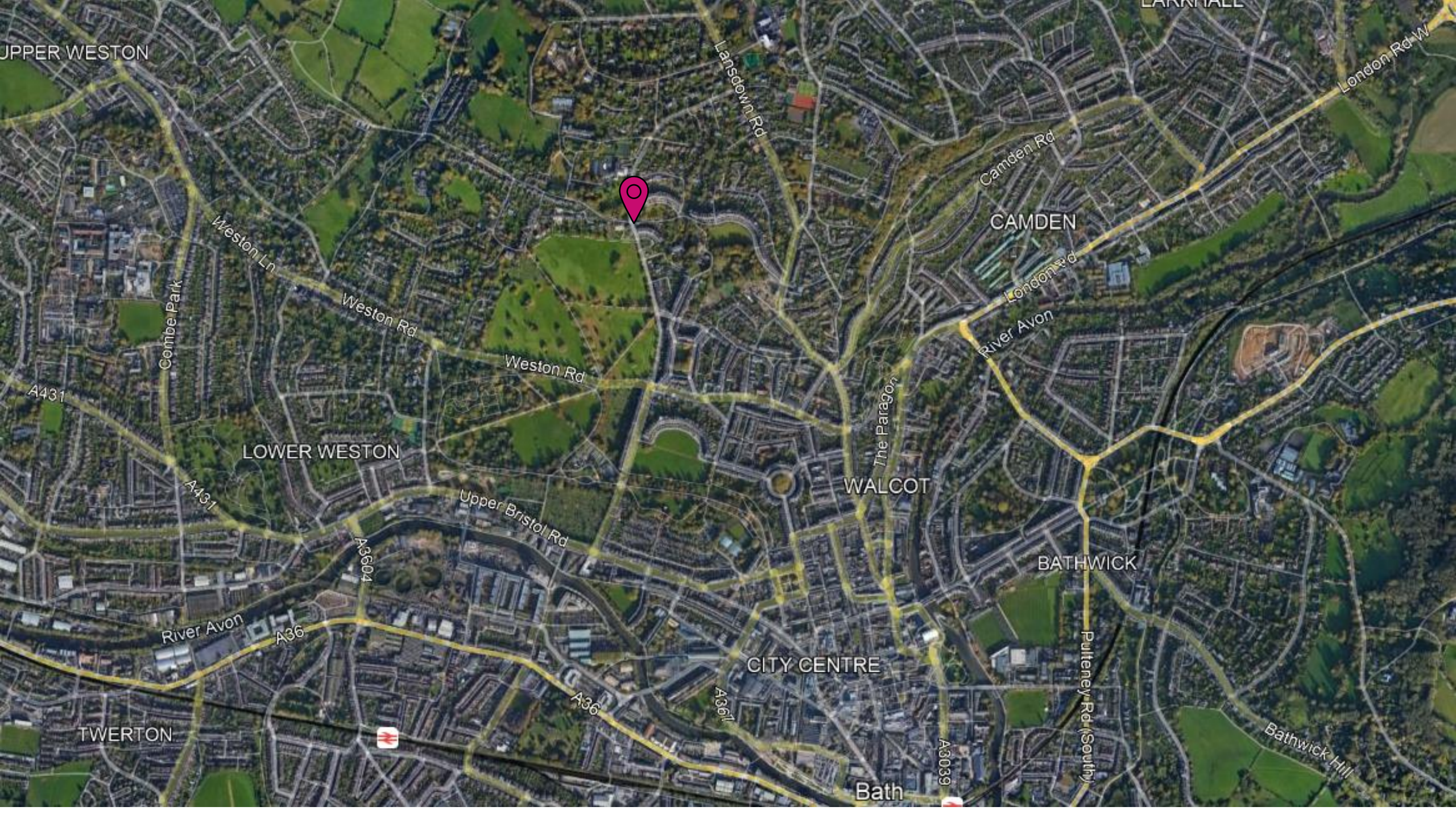

UPPER WESTON

LARKHALL



CAMDEN

LOWER WESTON

WALCOT

BATHWICK

CITY CENTRE

TWERTON

Bath

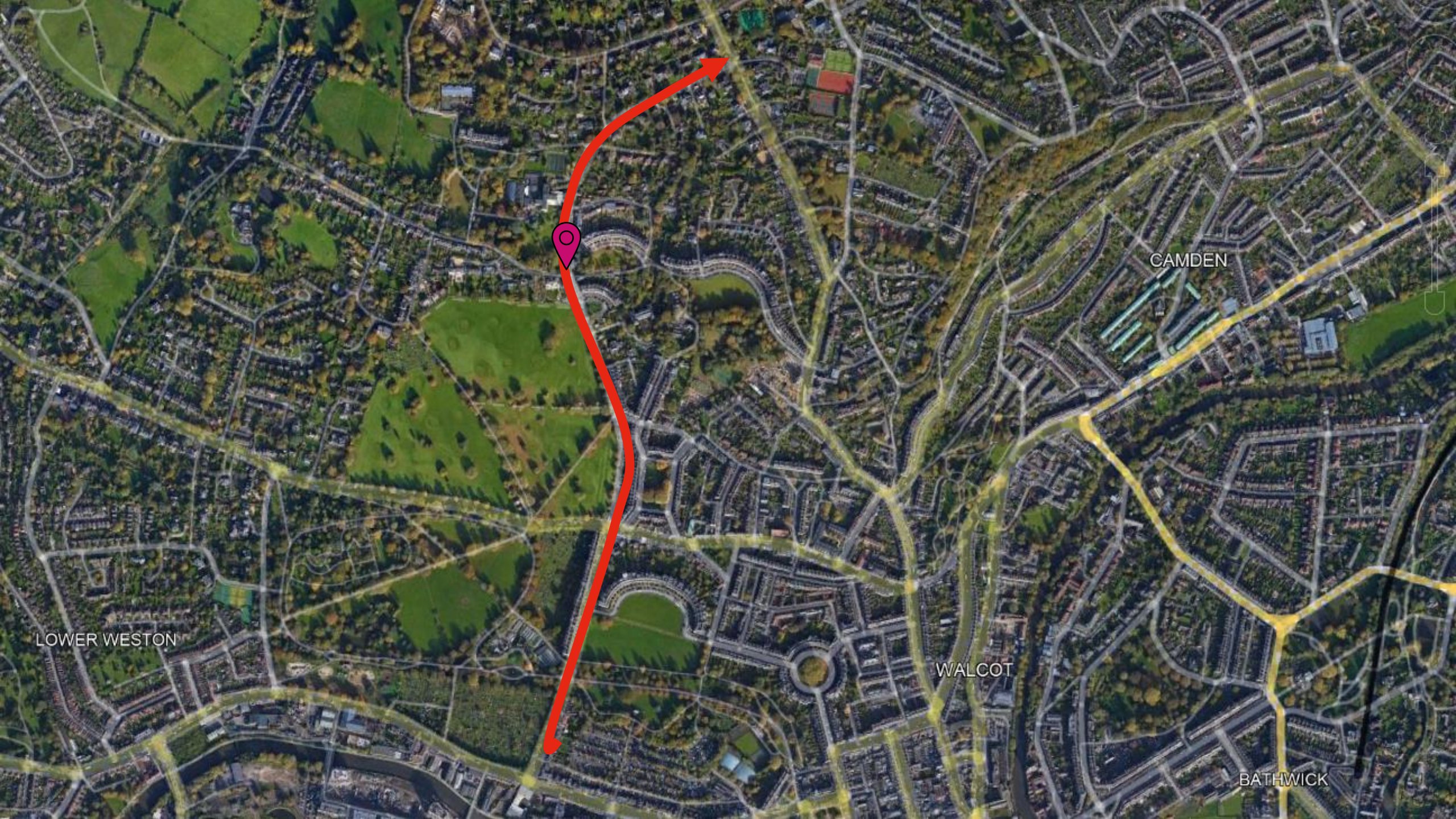

LOWER WESTON

CAMDEN

WALCOT

BATHWICK

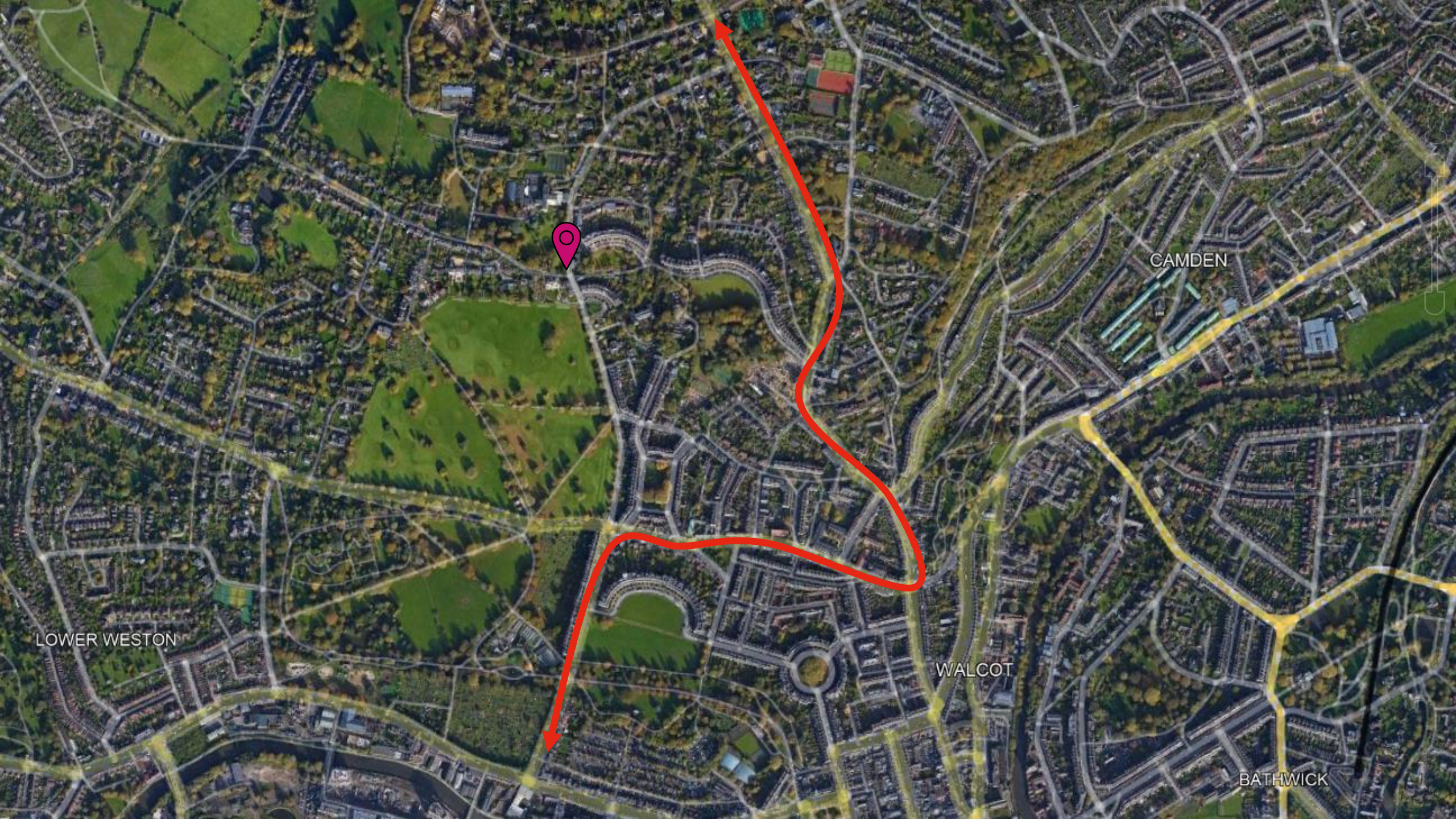

LOWER WESTON

CAMDEN

WALCOT

BATHWICK

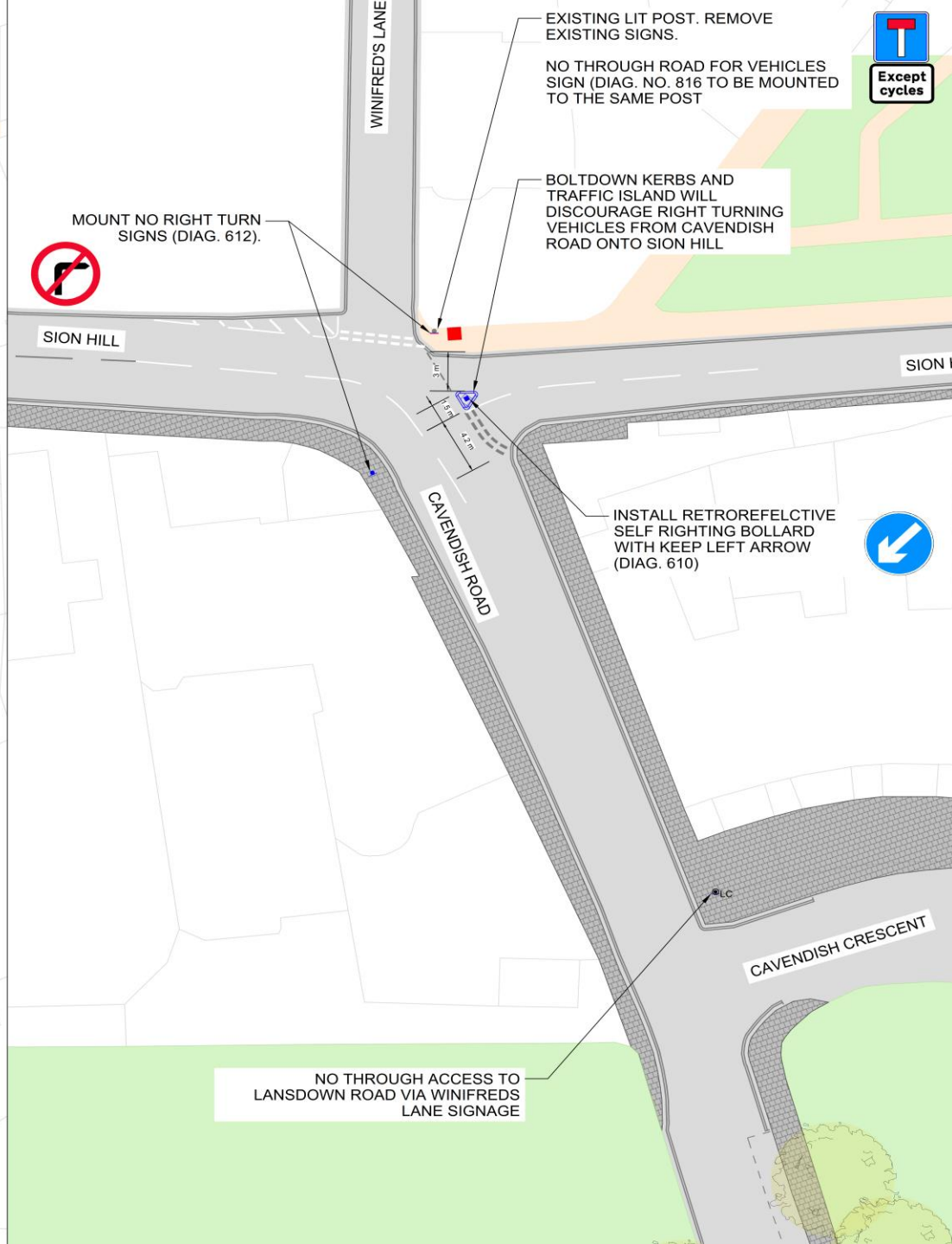
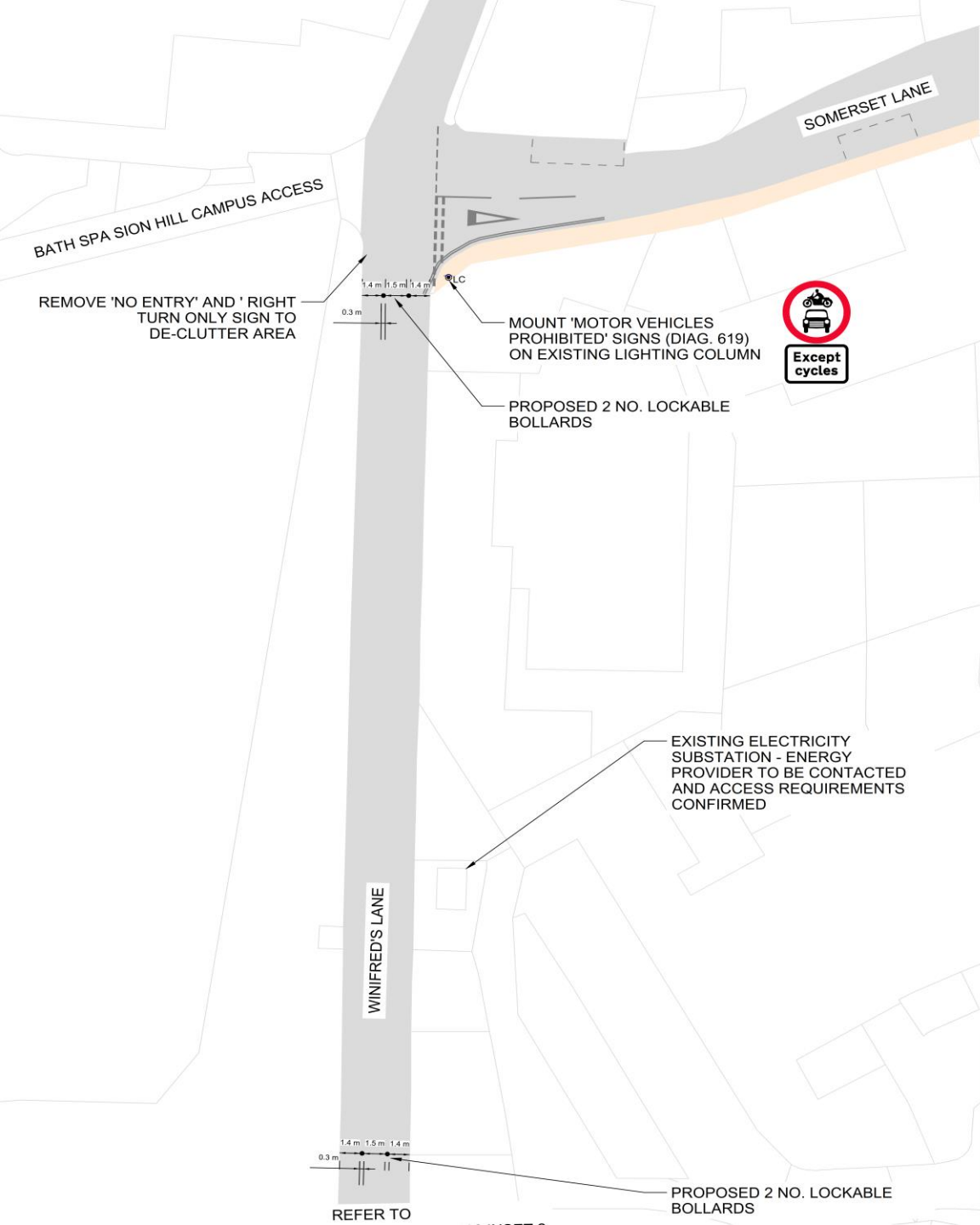

**Thank you.**