

This map is based on Ordnance Survey material with the permission of the Controller of Her Majesty's Stationery Office Crown Copyright. Unauthorised reproduction infringes Crown Copyright and may lead to prosecution or civil proceedings. BATH AND NORTH EAST SOMERSET COUNCIL Licence No. 100023334

- Notes:
1. DO NOT SCALE. If in doubt please consult the Designer.
 2. Design is based upon Ordnance Survey mapping and is subject to change once designed on a topographical survey.
 - 3.

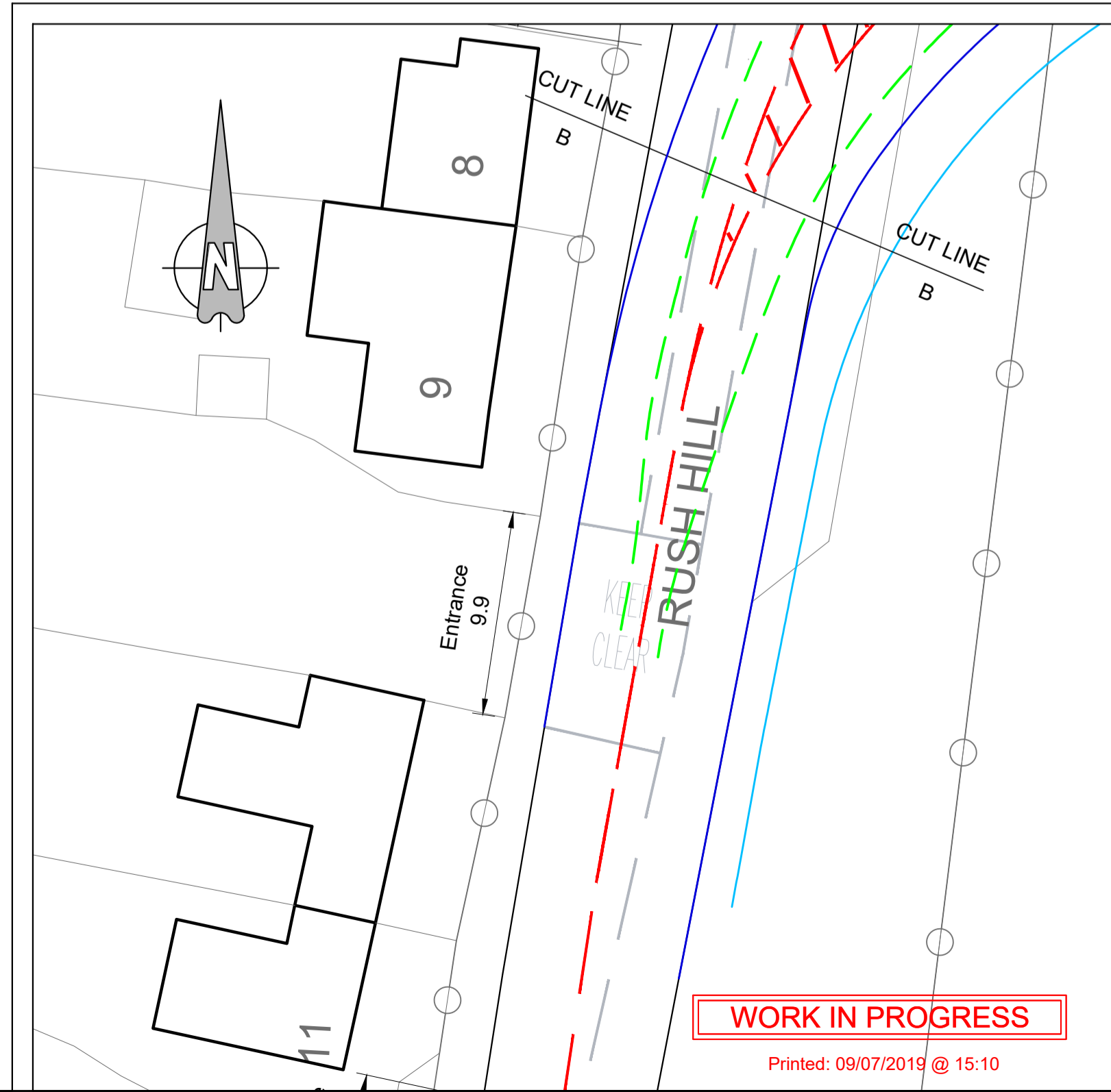
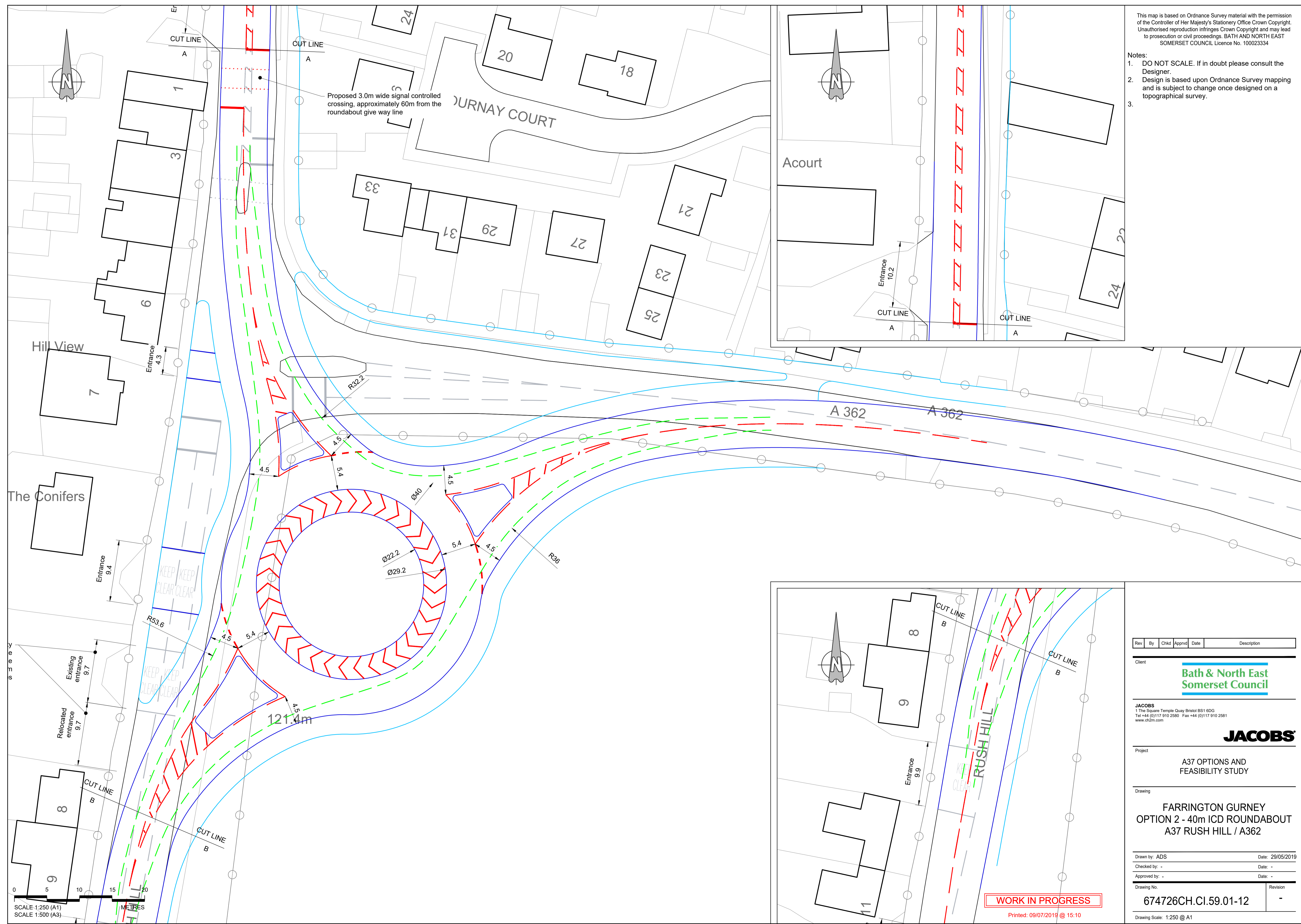

0 5 10 15 20 METRES
 SCALE 1:250 (A1)
 SCALE 1:500 (A3)

WORK IN PROGRESS
 Printed: 09/07/2019 @ 15:10

Rev	By	Chkd	Apprvd	Date	Description

Client
Bath & North East Somerset Council

JACOBS
 1 The Square Temple Quay Bristol BS1 6DG
 Tel +44 (0)117 910 2580 Fax +44 (0)117 910 2581
 www.cj2m.com



Project
 A37 OPTIONS AND FEASIBILITY STUDY

Drawing
**FARRINGTON GURNEY
 OPTION 2 - 40m ICD ROUNDABOUT
 A37 RUSH HILL / A362**

Drawn by: ADS Date: 29/05/2019

Checked by: - Date: -

Approved by: - Date: -

Drawing No. Revision

674726CH.CI.59.01-12

Drawing Scale: 1:250 @ A1

Drawing File Path: X:\reference files path
 User and Plot Date