

Do not scale from this drawing.	
SAFETY HEALTH AND ENVIRONMENTAL INFORMATION	
IN ADDITION TO THE HAZARD/RISKS NORMALLY ASSOCIATED WITH THE TYPES OF WORK DETAILED ON THIS DRAWING, NOTE THE FOLLOWING RISKS AND INFORMATION:	
RISKS LISTED HERE ARE NOT EXHAUSTIVE. REFER TO DESIGN ASSESSMENT FORM NO.	
CONSTRUCTION	None a competent contractor would not already be aware of.
DEMOLITION	None a competent contractor would not already be aware of.
FOR INFORMATION RELATING TO USE, CLEANING AND MAINTENANCE SEE THE HEALTH AND SAFETY FILE	
IT IS ASSUMED THAT ALL WORKS WILL BE CARRIED OUT BY A COMPETENT CONTRACTOR WORKING, WHERE APPROPRIATE, TO AN APPROVED METHOD STATEMENT.	

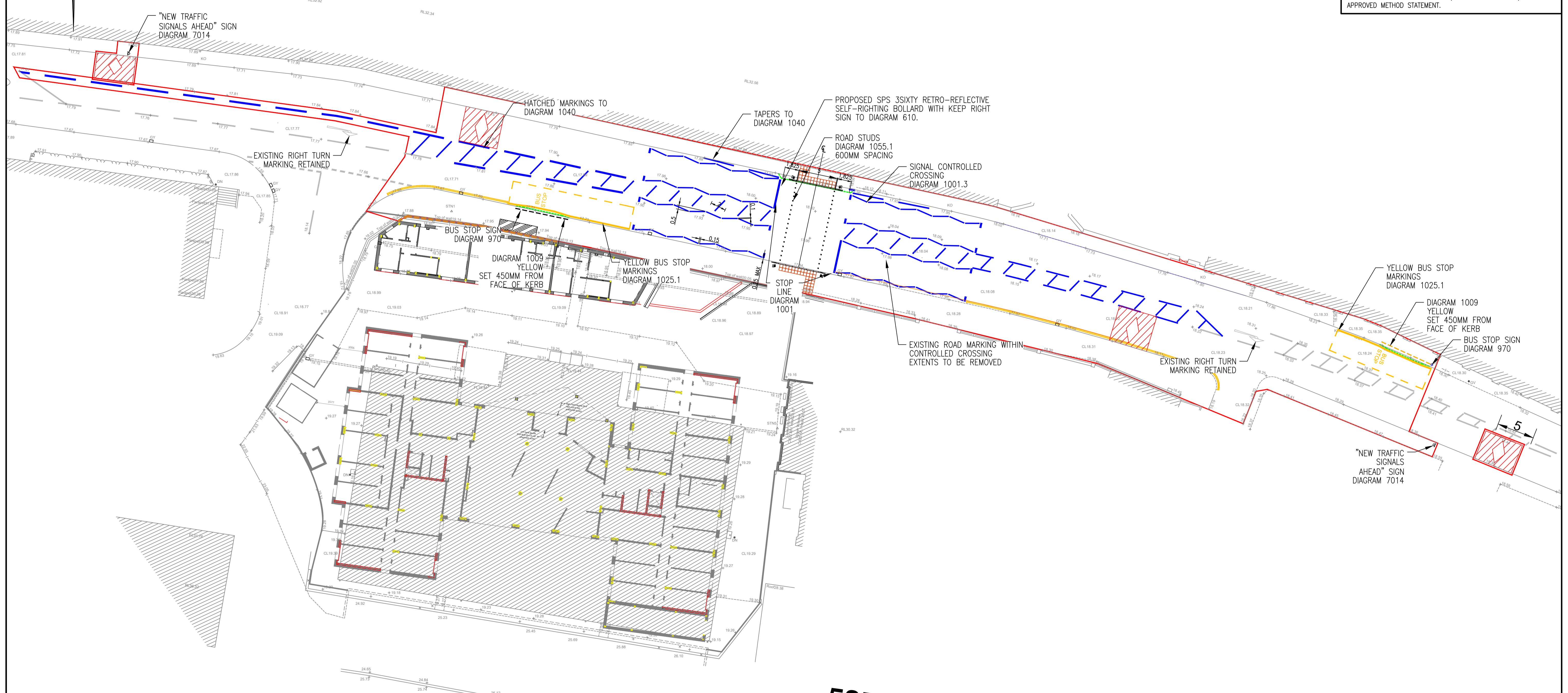

Rev.	Date	Description	Drawn	Checked	Approved
H	16.02.20	Existing right turn marking notes added.	MDF	NS	MH
G	24.02.20	Road markings amended to Bathnes comments.	DL	MDF	MH
F	07.02.20	Build out amended.	DL	MDF	MH
E	22.01.20	Pedestrian crossing build out added.	MDF	MH	MH
D	07.11.19	Bus shelter position amended.	MDF	MH	MH
C	11.10.19	Bus stop markings amended.	MDF	MH	MH
B	12.08.19	Bus stop and cross road markings amended.	MDF	MH	MH
A	30.04.19	Signs moved, notes amended.	MDF	NS	MH

Notes:

- LAYOUT BASED OFF OF IMA DRAWING IMA-16-117-16-A.
- TOPOGRAPHICAL DATA FROM BERRY GEOMATICS DRAWING 74/18.
- ALL LINES, INCLUDING JUNCTION MARKINGS, TO BE REFRESHED WHERE REQUIRED.
- BUS STOP LAYOUT BASED OFF OF SOUTH GLOUCESTERSHIRE COUNCIL ADOPTABLE HIGHWAY SPECIFICATION AS PER EMAIL FROM BATHNES COUNCIL RECEIVED 10.10.2018.
- "NEW TRAFFIC SIGNALS AHEAD" SIGN TO BE IN PLACE FOR A MINIMUM OF 6 MONTHS.
- SEE DRAWING 115296-1005 FOR HIGHWAY CONSTRUCTION DETAILS, 115296-1007 FOR KERBING AND FOOTWAY LAYOUT, 115296-1008 FOR COLOURED PLAN OF WORKS.
- ALL ROAD MARKINGS TO BE COMPLIANT WITH TRAFFIC SIGNS MANUAL: CHAPTER 5.
- ALL ROAD SIGNS TO BE COMPLIANT WITH TRAFFIC SIGNS MANUAL CHAPTERS 3&4.
- SUBJECT TO TECHNICAL APPROVAL.

Subject to technical approval.
Any works carried out before technical approval is obtained is at their own risk.



Project Title:		PROJECT AQUILA BATH	
Drawing Title:		ROAD MARKINGS AND SIGNS	
Scale at A1:	Status:	Drawn:	Checked:
1:250	Preliminary	MF	NS
Date:	Date:	Date:	Date:
14/03/19	18/03/19	18/03/19	18/03/19
Drawing No.:	Revision:		
115296/1006	H		

FAIRHURST

Clifton Heights, Triangle West, Clifton,
BRISTOL, BS8 3JA
Tel: 0117 925 0259 Fax: 0844 381 4412