

This map is based on Ordnance Survey material with the permission of the Controller of Her Majesty's Stationery Office Crown Copyright. Unauthorised reproduction infringes Crown Copyright and may lead to prosecution or civil proceedings. BATH AND NORTH EAST SOMERSET COUNCIL Licence No. 100023334

- Notes:
1. DO NOT SCALE. If in doubt please consult the Designer.
  2. Design is based upon Ordnance Survey mapping and is subject to change once designed on a topographical survey.
  - 3.

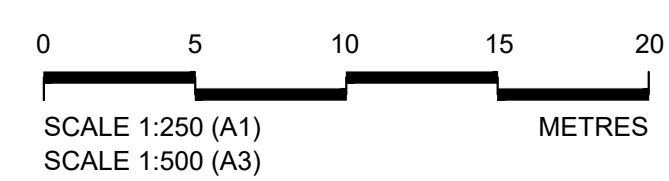
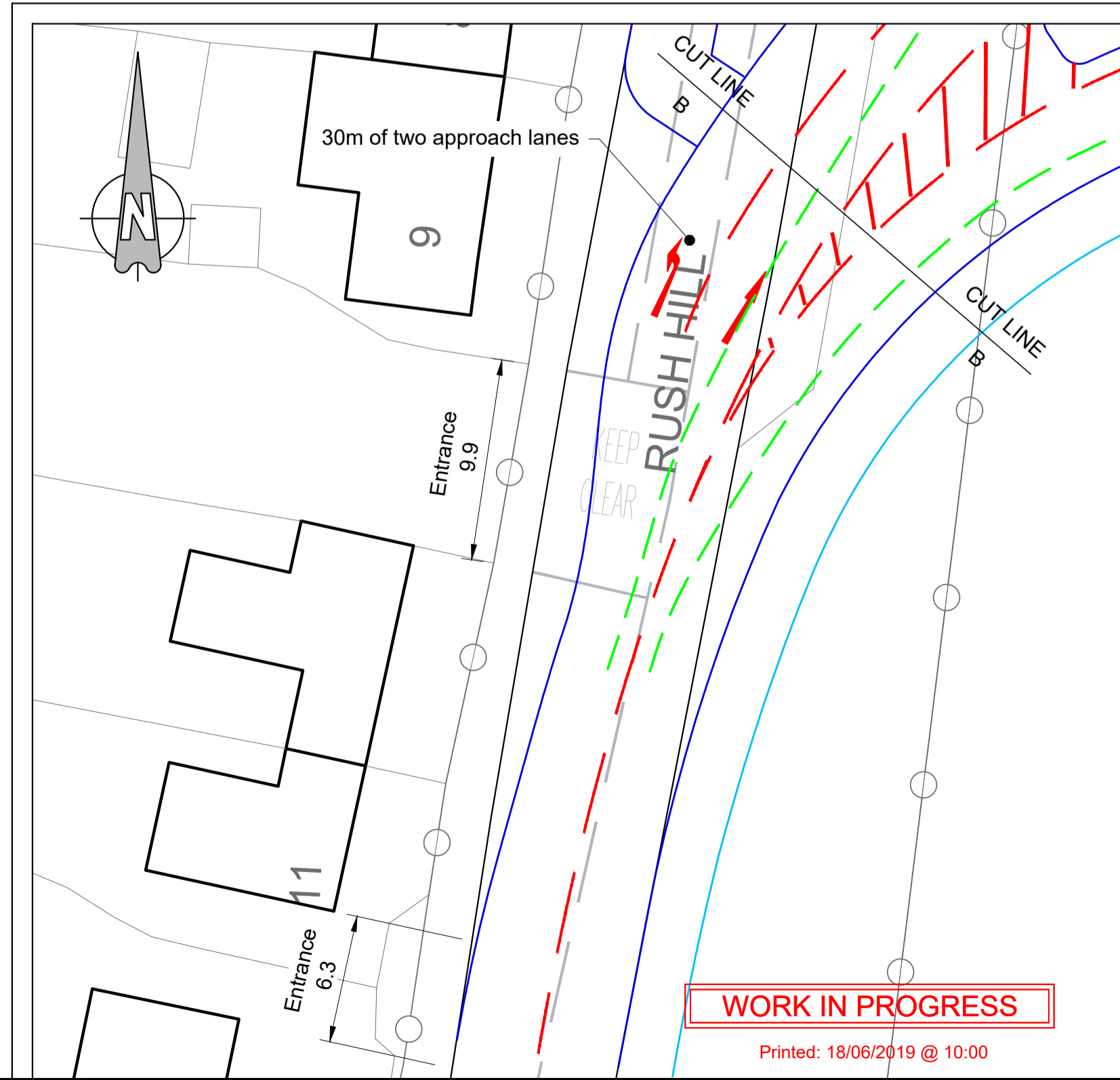
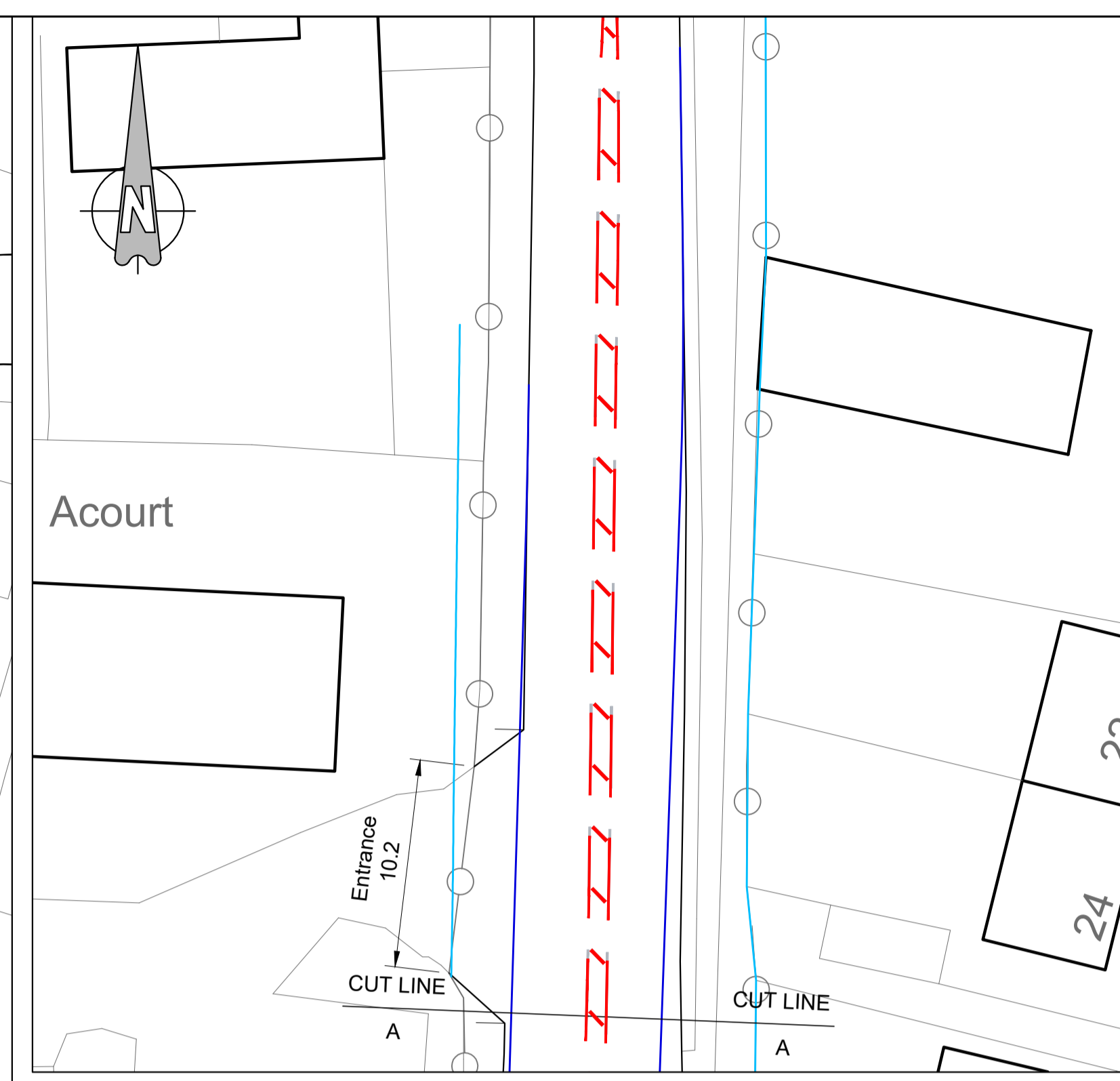
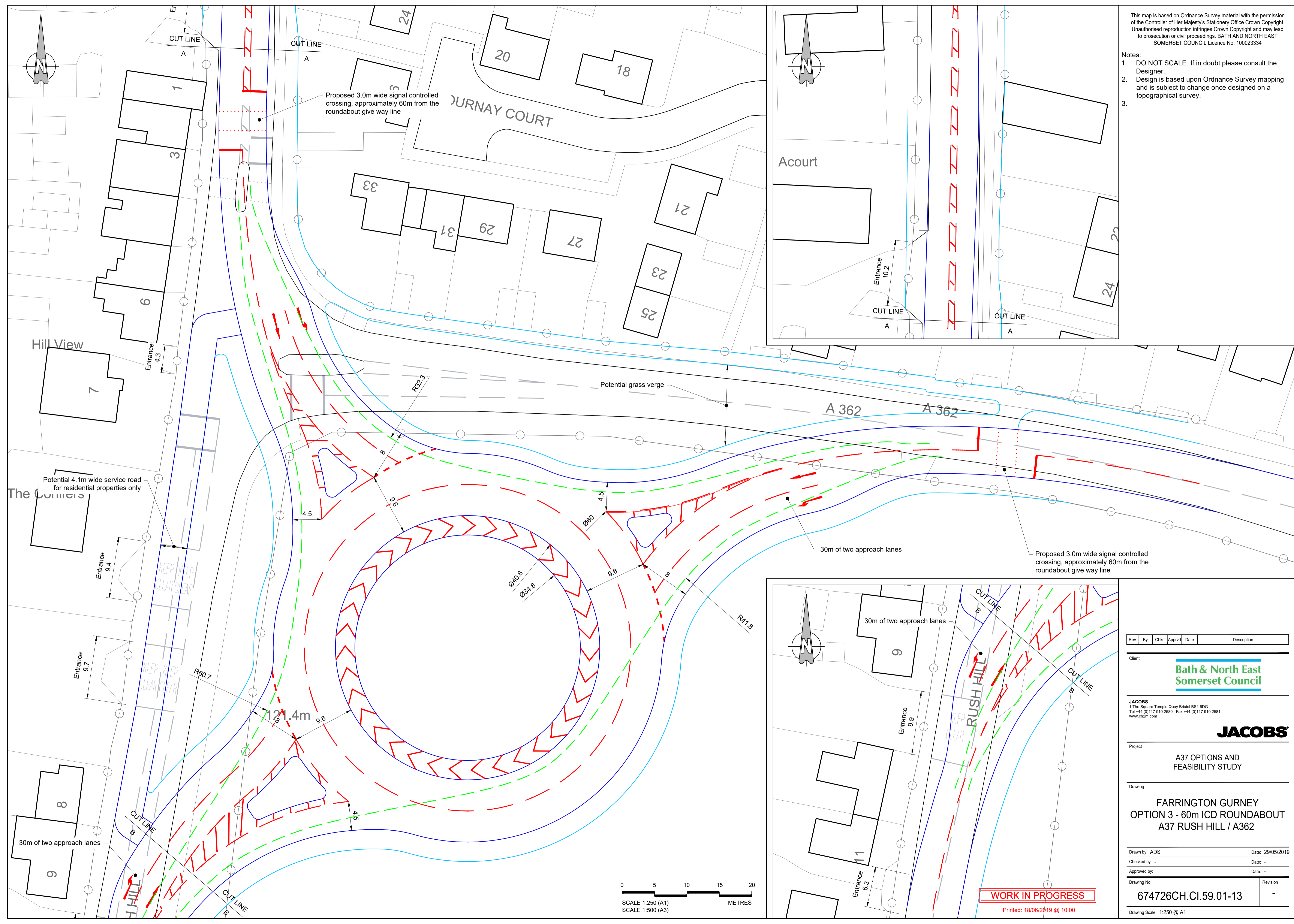

**WORK IN PROGRESS**  
Printed: 18/06/2019 @ 10:00

| Rev   | By | Chkd | Apprvd | Date | Description |
|---|----|------|--------|------|-------------|
| Client  |    |      |        |      |             |
| <b>Bath &amp; North East Somerset Council</b>   |    |      |        |      |             |
| <small>JACOBS<br/>1 The Square Temple Quay Bristol BS1 6DG<br/>Tel +44 (0)117 910 2580 Fax +44 (0)117 910 2581<br/>www.cj2m.com</small> |    |      |        |      |             |
| <b>JACOBS</b>   |    |      |        |      |             |
| Project   |    |      |        |      |             |
| A37 OPTIONS AND FEASIBILITY STUDY   |    |      |        |      |             |
| Drawing   |    |      |        |      |             |
| FARRINGTON GURNEY<br>OPTION 3 - 60m ICD ROUNDABOUT<br>A37 RUSH HILL / A362  |    |      |        |      |             |
| Drawn by: ADS Date: 29/05/2019  |    |      |        |      |             |
| Checked by: - Date: -   |    |      |        |      |             |
| Approved by: - Date: -  |    |      |        |      |             |
| Drawing No. Revision  |    |      |        |      |             |
| 674726CH.CI.59.01-13  |    |      |        |      |             |
| Drawing Scale: 1:250 @ A1   |    |      |        |      |             |

Drawing No. 674726CH.CI.59.01-13  
 User and Plot Date