

KEY:

- FOOTWAY RESURFACING  
AC20 DENSE BIN 100/150 REC BINDER COURSE 50mm THICK  
AC6 DENSE SURF 100/150 SURFACE COURSE 20mm THICK
- CARRIAGEWAY RESURFACING  
AC10 CLOSE SURF 100/150 30mm THICK
- PROPOSED PRE-CAST CONCRETE TYPE DL/DR KERB
- PROPOSED PRE-CAST CONCRETE TYPE CS2 KERB
- PROPOSED PRE-CAST CONCRETE TYPE HB2 KERB
- EXISTING IRONWORK TO BE RAISED
- PROPOSED TACTILE PAVING (RED)
- PROPOSED ROAD MARKINGS (WHITE)
- ZEBRA CROSSING BEACON WITH FLOODLIGHT
- VISIBILITY (MEASURED ON SITE) - 65 METRES EASTBOUND & 65 METRES WESTBOUND.  
(LTN-2.95 85th PERCENTILE SPEED 30mph DESIRABLE VISIBILITY REQUIREMENTS - 65 METRES)
- NEW WARNING SIGNS (TEMPORARY FOR 3 MONTHS)

Checked By	Issue No	Issue Date
Drawn By	Issue No	Issue Date
Checked By	Issue No	Issue Date
Drawn By	Issue No	Issue Date
Checked By	Issue No	Issue Date
Drawn By	Issue No	Issue Date

0 0.5 1 2 3 4 5m  
1:50

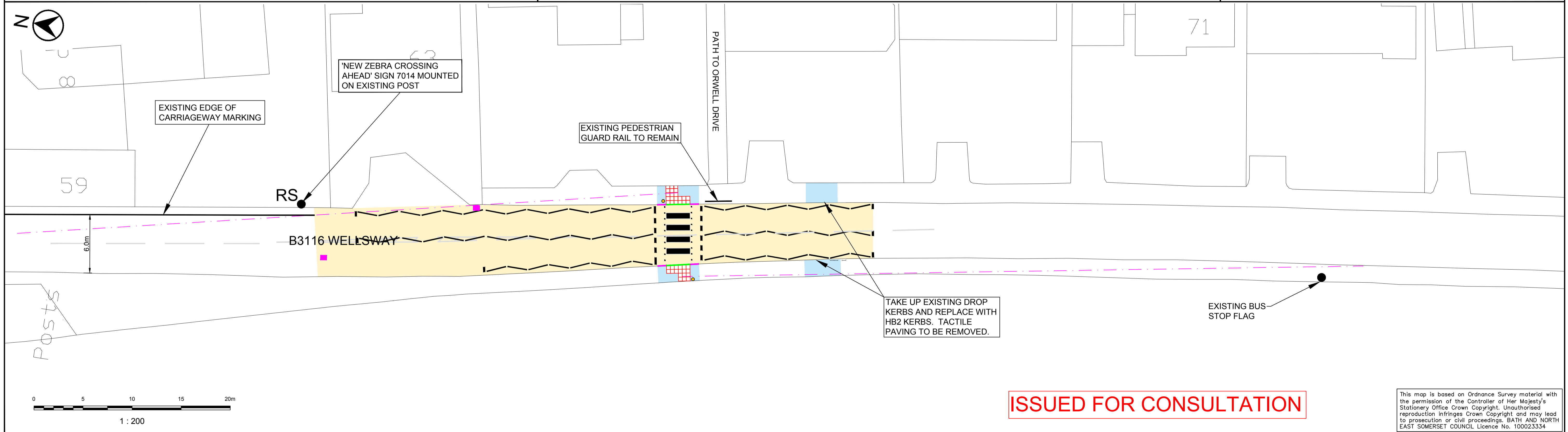

**ISSUED FOR CONSULTATION**

This map is based on Ordnance Survey material with the permission of the Controller of Her Majesty's Stationery Office Crown Copyright. Unauthorised reproduction infringes Crown Copyright and may lead to prosecution or civil proceedings. BATH AND NORTH EAST SOMERSET COUNCIL Licence No. 100023334

<p>KELVIN PACKER GROUP MANAGER - HIGHWAYS AND TRAFFIC ENVIRONMENTAL SERVICES</p>	PRODUCED BY	SCHEME TITLE	DRAWING TITLE	DATE	DRAWN BY	APPROVED BY
	DESIGN GROUP	PROPOSED ZEBRA CROSSING WELLSWAY, KEYNSHAM	GENERAL ARRANGEMENT	MAY 2019	LED	SRC
				SCALE	CHECKED	
				AS SHOWN	DMM	
				TITLE	DRAWING No. TCG0034/01	
				REV. DATE	REVISIONS	REV. C
				C SEPT 19	ISSUED FOR CONSULTATION	DMM SRC S.J.F.
				B JULY 19	ISSUED FOR ROAD SAFETY AUDIT STAGE 2	DMM SRC S.J.F.
				A JUNE 19	ZEBRA CROSSING LOCATION MOVED NORTH	DMM SRC S.J.F.
				- MAY 19	FIRST ISSUE	DMM SRC S.J.F.
				REV. DATE	REVISIONS	DRWN. CHKD. APROV.