

N O R T H

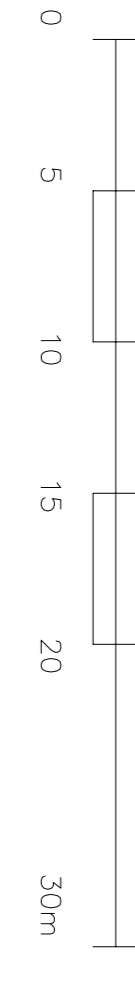

Tree planting
Species to include: Field maple, Small leaved lime, oak (in the wildlife zone), birch, native cherry alder (along stream)
Understorey: hazel, dogwood, holly, yew, roses

3.2m acoustic fence ground boundaries, excluding SE
Stained dark brown and planted on both sides with native ivy

Native standard trees to screen fence from high points

2.5m high dark green steel fence with sliding gates to close off carriageway

Individual amenity with drying areas, & raised beds

Shallow swales outside acoustic fence — see engineer's drawings

Extended area of patio defended with boulders to create fire separation between plots 1&2

Informal amenity space defended with planting & overlooked from plot 1

Water main @ 2m depth with 6m section west of site

Extra wide acoustic fence panel over water main — posts min. 2m from pipe

Low native shrubs only within water main easement e.g. Burnet Rose

Vertical root barriers to deflect tree roots away from main

Semi-mature oak to provide shade & impact

Stone wall curves into site, finishing at stove pier

Brick built timber clad kiosk for equipment

Kissing gate to nature reserve

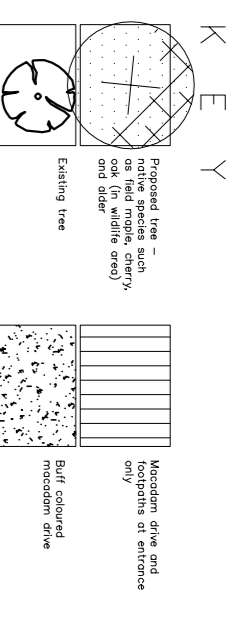

DESIGN NOTES
1. The drawings are for the proposed works. The contractor is responsible for checking the site conditions and for any necessary variations to the drawings. The contractor is also responsible for obtaining all necessary permissions and consents from the relevant authorities.
2. The contractor is to ensure that all work is carried out in accordance with the latest editions of the relevant British Standards and Codes of Practice.
3. The contractor is to ensure that all work is carried out in accordance with the relevant health and safety legislation.
4. The contractor is to ensure that all work is carried out in accordance with the relevant environmental legislation.
5. The contractor is to ensure that all work is carried out in accordance with the relevant planning legislation.
6. The contractor is to ensure that all work is carried out in accordance with the relevant building regulations.
7. The contractor is to ensure that all work is carried out in accordance with the relevant fire safety legislation.
8. The contractor is to ensure that all work is carried out in accordance with the relevant accessibility legislation.
9. The contractor is to ensure that all work is carried out in accordance with the relevant equality legislation.
10. The contractor is to ensure that all work is carried out in accordance with the relevant data protection legislation.
11. The contractor is to ensure that all work is carried out in accordance with the relevant general contract conditions.
12. The contractor is to ensure that all work is carried out in accordance with the relevant terms and conditions of the contract.
13. The contractor is to ensure that all work is carried out in accordance with the relevant schedule of conditions.
14. The contractor is to ensure that all work is carried out in accordance with the relevant bill of materials.
15. The contractor is to ensure that all work is carried out in accordance with the relevant programme of works.
16. The contractor is to ensure that all work is carried out in accordance with the relevant risk assessment.
17. The contractor is to ensure that all work is carried out in accordance with the relevant safety plan.
18. The contractor is to ensure that all work is carried out in accordance with the relevant quality plan.
19. The contractor is to ensure that all work is carried out in accordance with the relevant environmental management plan.
20. The contractor is to ensure that all work is carried out in accordance with the relevant social value plan.



Small verge on inside face of acoustic fence — planted and seeded with robust natives. Fence to be planted both sides with native ivy

Native trees planted as whips and advanced nursery stock, all at 2m centres

Footway — shored surface, no kerb, just metal in

Residential plots 6-13 have raised planters on patios

1.1m high plant turning area to keep views open across the site

Existing fence line

Existing ash tree felled to 5m height and left as standing dead wood

Parking bay moved 1m to SE

Approximate location of existing scrub

Native scrub and trees with dead wood habitats (vertical log piles and bug hotels)

Rough grass verge to back of plots, within boundary fence

Standard trees with under planting across site to break up view of caravans from local high points

1.5m wide gravel strip with boulders to provide crown parking — part of 6m

6m wide fire breaks between plots 5 & 6; 3x 13; 7&8 and 11& 12

Acoustic fence extends into field at both ends of the site. Height tapers down over last panel from 3.2m to 2.6m

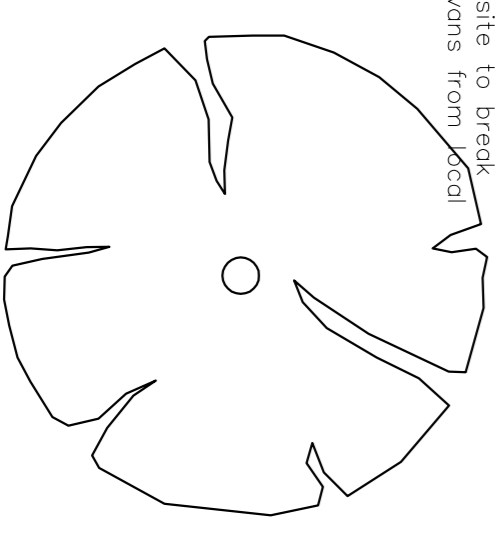

1:50 @ A1 & 1:100 @ A3

Item	Description	Quantity	Unit	Date
1	Sheds added, government type	TM	10.12.2014	
H	Formed plot 1 landscaping	TM	27.11.2014	
F	Footway added	TM	05.11.2014	
G	Water main replaced	TM	15.10.2014	
E	Water main replaced	TM	01.10.2014	
D	Caravan parking areas moved off 16-19 relocated	TM	01.10.2014	
C	Caravan parking areas moved off	TM	19.09.2014	
B	Native trees added	TM	16.09.2014	
A	FNST 4 amended to match others	TM	10.09.2014	
A	FNST ISSUE	TM	02.09.2014	
Rev	By	Date		

gpp Chartered Architects
150, Oldfield Road, Bath, BA2 9JN
Tel: 01225 310000
www.gpparchitects.co.uk

LOWER BRISTOL ROAD, BATH
GVPST & TRAVELLER SITE
SITING LAYOUT

Drawn by: TM Date: 03.09.2014
Checked by: JHL Scale: 1:200 @ A1
Drawing No: 14032/201 Rev: 1
Status: CONSTRUCTION

The drawings are for the proposed works. The contractor is responsible for checking the site conditions and for any necessary variations to the drawings. The contractor is also responsible for obtaining all necessary permissions and consents from the relevant authorities.