

**The Bath and North East Somerset Council
(Oldfield Park Junior School – Provision of a School Playing Field)
Compulsory Purchase Order 2010**

*The Education Act 1996
and The Acquisition of land Act 1981*

The Bath and North East Somerset Council (in this order called “the Acquiring Authority “) makes the following order:-

1. (1) Subject to the provisions of this Order, the Acquiring Authority are hereby authorised under section 530 Education Act 1996 to purchase compulsorily the land, interests and rights over land described in paragraph 2 for the purpose of:-

(2) the provision of a playing field for the benefit of Oldfield Park Junior School on 0.4184 hectares of land at Lymore Terrace, Oldfield Park, Bath in Bath and North East Somerset.

2. (1) The land authorised to be purchased compulsorily under this Order is the land described in the Schedule and delineated red and shown coloured pink on a Map consisting of 1 sheet numbered 1 prepared in duplicate, sealed with the common seal of the Acquiring Authority and marked “Map referred to in the Bath and North East Somerset Council (Oldfield Park Junior School – Provision of a School Playing Field) Compulsory Purchase Order 2010.

SCHEDULE

PART 1 - LAND

TABLE 1

Number on map	Extent, description and situation of land	Qualifying person under section 12(2)(a) of the Acquisition of Land Act 1981 - name and address (3)	Owners or reputed Owners	Lessees or reputed Lessees	Tenants or reputed tenants (other than lessees)	Occupiers
(1) 1	(2) All that land comprising of a partially uncultivated privately owned smallholding to the east of Oldfield Park Junior School bounded on the north side by land belonging to the Council not delineated on the ground with the western boundary marked by the Oldfield Park Junior School building, a stone wall and 1m high chain link		Mr R V Mancini 5 Ivy Avenue Oldfield Park Bath BA2 1AJ	None	None	Mr R V Mancini

SCHEDULE

PART 1 – LAND

TABLE 1

Number on map	Extent, description and situation of land	Qualifying person under section 12(2)(a) of the Acquisition of Land Act 1981 – name and address (3)
(1)	(2)	Occupiers
	Owners or reputed Owners	Lessees or reputed Lessees
		Tenants or reputed tenants (other than lessees)
1 cont'd	fence. The southern boundary is made up of overgrown hedging and bushes with the eastern boundary being adjacent to Plot 2. The land has a dilapidated plastic polytunnel and shed within it and contains plum and apple trees. The total area being 984m ² .	
2	All that land comprising of a partly cultivated private owned	Mr L R Hawkins 16 Manor Park Bath
		None
		None
		Mr L R Hawkins

SCHEDULE

PART 1 – LAND

TABLE 1

Number on map	Extent, description and situation of land	Qualifying person under section 12(2)(a) of the Acquisition of Land Act 1981 – name and address (3)	Lessees or reputed Lessees	Tenants or reputed tenants (other than lessees)	Occupiers
(1)	(2)	Owners or reputed Owners			
2 cont'd	smallholding to the rear of Oldfield Park Junior School kitchen. The north boundary is 2 metres to the north of a 2 metre high corrugated iron fence and wooden access gate. On the west it is bounded by Plot 1 and a grassed path. The eastern side is delineated by a grassed path adjacent to Plot 3. The southern boundary is made up of overgrown hedging and	BA1 3RJ Mrs J Hiscocks 57 Milton Avenue Bath BA2 4RA			

SCHEDULE
PART 1 -- LAND

TABLE 1

Number on map	Extent, description and situation of land	Qualifying person under section 12(2)(a) of the Acquisition of Land Act 1981 – name and address (3)	Owners or reputed Owners	Lessees or reputed Lessees	Tenants or reputed tenants (other than lessees)	Occupiers
(1)	(2)					
	bushes backing onto Council owned allotments at Monksdale Avenue. The land is partly cultivated and has a dilapidated wooden shed towards the north of the site and contains 2 apple trees. The total area being 514m ² .					
3	All that land comprising an uncultivated allotment. The southern boundary is a chainlink fence and overgrown		Bath Scaffolding Limited Old Track Claude Avenue Bath	None	None	None

SCHEDULE

PART 1 – LAND

TABLE 1

Number on map	Extent, description and situation of land	Qualifying person under section 12(2)(a) of the Acquisition of Land Act 1981 – name and address (3)	Owners or reputed Owners	Lessees or reputed Lessees	Tenants or reputed tenants (other than lessees)	Occupiers
(1)	(2)					
3 cont'd	hedging abutting the Council owned allotments at Monksdale Avenue. The northern boundary is 2m in front of a dilapidated garage with corrugated iron doors. The western boundary adjoins Plot 2 and is delineated by a line of metal posts. The east boundary with Plot 5 is a 2m high chainlink fence and with Plot 4 by a 1m high corrugated metal sheet fence. The		BA2 1AF			

SCHEDULE

PART 1 -- LAND

TABLE 1

Number on map	Extent, description and situation of land	Qualifying person under section 12(2)(a) of the Acquisition of Land Act 1981 – name and address (3)	Owners or reputed Owners	Lessees or reputed Lessees	Tenants or reputed tenants (other than lessees)	Occupiers
(1)	(2)					
3 cont'd	land is uncultivated and contains a number of small trees and a dilapidated shed at the southern end of the site. The total area being 695m ² .					
4	All that land comprising of a cultivated privately owned smallholding. The northern boundary is a chainlink fence forming the boundary of Plot 5 and an open boundary with Plot 6		Mr R V Mancini 5 Ivy Avenue Oldfield Park Bath BA2 1AJ	None	None	Mr R V Mancini

SCHEDULE

PART 1 – LAND

TABLE 1

Number on map	Extent, description and situation of land	Qualifying person under section 12(2)(a) of the Acquisition of Land Act 1981 – name and address (3)
(1)	(2)	Owners or reputed Owners
		Lessees or reputed Lessees
		Tenants or reputed tenants (other than lessees)
		Occupiers
4 cont'd	and a fence made of old garage doors adjacent to an access track. The eastern boundary is open to Plot 7 and the western boundary is corrugated iron fencing dividing the land from Plot 3. The southern boundary is adjacent to the Council owned allotments in Monksdale Avenue and comprises of overgrown hedging and a line of dilapidated low sheds. The land is	

SCHEDULE

PART 1 – LAND

TABLE 1

Number on map	Extent, description and situation of land	Qualifying person under section 12(2)(a) of the Acquisition of Land Act 1981 – name and address (3)	Owners or reputed Owners	Lessees or reputed Lessees	Tenants or reputed tenants (other than lessees)	Occupiers
(1)	(2)					
4 cont'd	cultivated and has 1 long polytunnel, 2 greenhouses, 2 sheds and water storage tanks. The total area being 996m ² .					
5	All that land being used as a builder's storage yard. The land is bounded on its north side by a high corrugated metal fence and corrugated double doors. On the east side by a chainlink fence and		Mr R S and Mrs J F Spurrell 21a Bloomfield Road Bath BA2 2AD	None	None	Mr R S Spurrell

SCHEDULE

PART 1 – LAND

TABLE 1

Number on map	Extent, description and situation of land	Qualifying person under section 12(2)(a) of the Acquisition of Land Act 1981 – name and address (3)
(1)	(2)	Occupiers
	Owners or reputed Owners	Lessees or reputed Lessees
		Tenants or reputed tenants (other than lessees)
5 cont'd	the southern side by a fence and rear panel of a wooden shed situated on Plot 4. The boundary on the western side is overgrown hedging. The total area being 135m ² .	
6	All that land comprising an uncultivated privately owned smallholding bounded on the north side by a fence made of garage doors. On the west side the land is separated from Plot 5	<p>Mr P A Tinkler 19 West Shepton Shepton Mallett Somerset BA4 5UJ</p> <p>None</p> <p>None</p> <p>None</p>

**SCHEDULE
PART 1 – LAND**

TABLE 1

Number on map	Extent, description and situation of land	Qualifying person under section 12(2)(a) of the Acquisition of Land Act 1981 – name and address (3)	Owners or reputed Owners	Lessees or reputed Lessees	Tenants or reputed tenants (other than lessees)	Occupiers
(1)	(2)					
6 cont'd	by a chainlink fence and by a fence of garage doors with metal pedestrian gate and 2m high chainlink fence. On the south and east side of the land there are open boundaries to Plot 4 where an access path allows the owners of Plot 4 access to their land. The land is uncultivated and partially covered by a blue plastic tarpaulin. The total area being					

SCHEDULE

PART 1 – LAND

TABLE 1

Number on map	Extent, description and situation of land	Qualifying person under section 12(2)(a) of the Acquisition of Land Act 1981 – name and address (3)	Owners or reputed Owners	Lessees or reputed Lessees	Tenants or reputed tenants (other than lessees)	Occupiers
(1)	(2)					
	259m2.					
7	All that land comprising an uncultivated privately owned smallholding covered with brambles and Elder trees. The land is bounded on the east side by a stonemason's yard and 6 foot high chainlink and barbed wire fence. On the southern boundary marked by overgrown hedging the land abuts the Council owned		Mr K Miles 186 Coronation Avenue Oldfield Park Bath BA2 2JS Ms C Neighbour 91 Hillcrest Drive Southdown Road Bath BA2 1HE	None	None	None

SCHEDULE
PART 1 – LAND

TABLE 1

Number on map	Extent, description and situation of land	Qualifying person under section 12(2)(a) of the Acquisition of Land Act 1981 – name and address (3)	Owners or reputed Owners	Lessees or reputed Lessees	Tenants or reputed tenants (other than lessees)	Occupiers
(1) 7 cont'd	(2) allotments at Monksdale Avenue. The west boundary adjacent to Plots 4 and 6 is marked by some iron posts. On the northern boundary there is stone shed and 2m high sheet metal fence. The total area being 462m ² .		Mr G Miles 56 Whatcombe Road Frome Somerset BA11 3AX			
8	Land within the Council's ownership currently grassed and subject to rights of way by the owners of Plots		Bath and North East Somerset Council Riverside Temple Street	None	None	None

SCHEDULE

PART 1 – LAND

TABLE 1

Number on map	Extent, description and situation of land	Qualifying person under section 12(2)(a) of the Acquisition of Land Act 1981 – name and address (3)	Owners or reputed Owners	Lessees or reputed Lessees	Tenants or reputed tenants (other than lessees)	Occupiers
(1) 8 cont'd	(2) 1-7. The boundary is marked on the northern and western sides by the chainlink fence of the school and on the southern side is unmarked. On the eastern side the boundary consists of the garage door panels of Plot 6. The total area is 139m².		Keynsham BS31 1LA			



ID	Address
1	Land adjoining east side of Oldfield Park Junior School
2	Land to south west of Oldfield Park Junior School
3	Land on western boundary of Builders Yard
4	Land to south and east of Builders Yard
5	Land at Builders Yard
6	Land on eastern boundary of Builders Yard
7	Land adjacent to Stonemasons Yard
8	Track to rear of Oldfield Park Junior School Kitchen

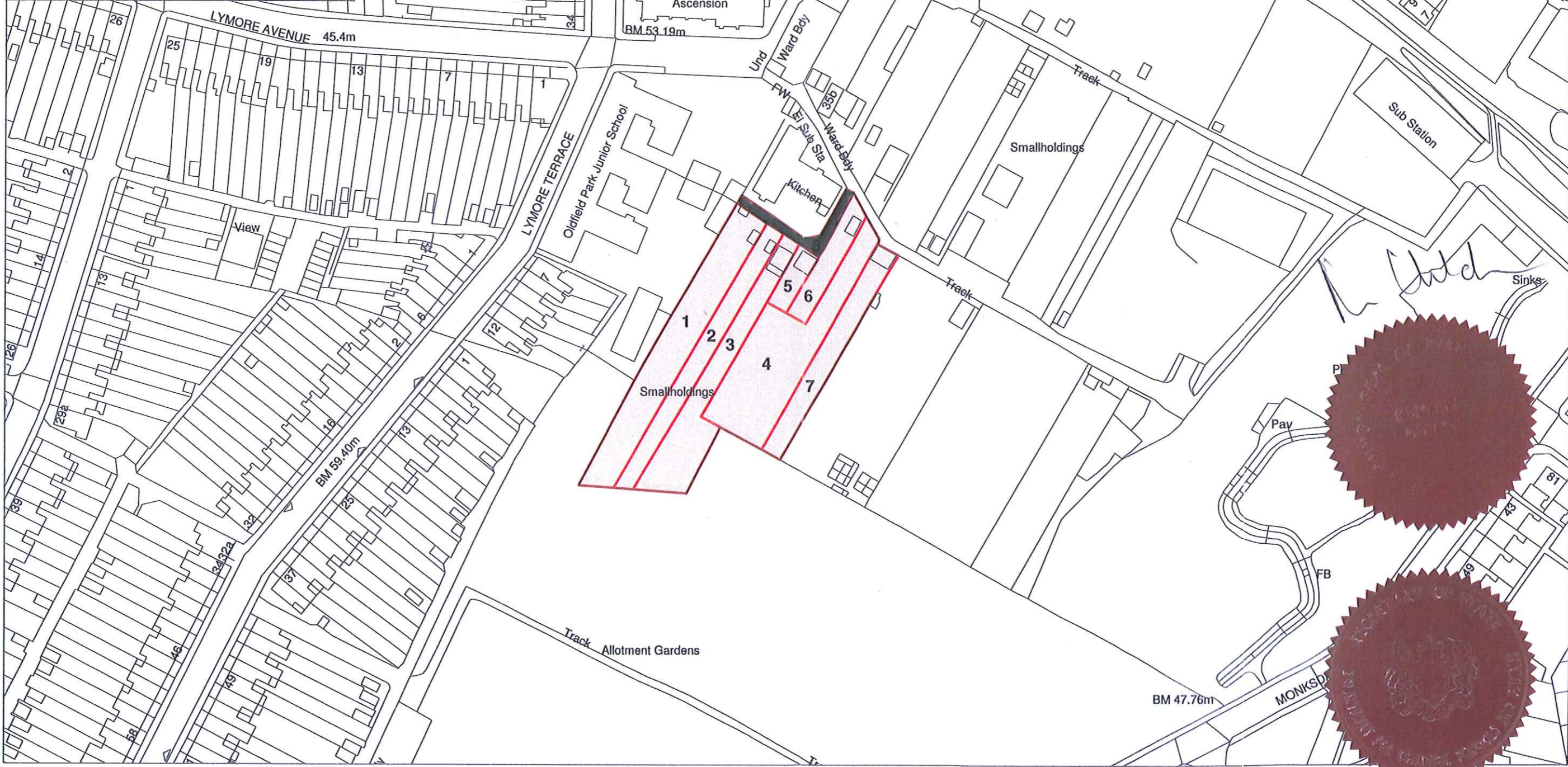

 Land to be acquired

MAP REFERRED TO IN THE BATH AND NORTH EAST SOMERSET COUNCIL
 (OLDFIELD PARK JUNIOR SCHOOL - PROVISION OF A SCHOOL PLAYING FIELD)
 COMPULSORY PURCHASE ORDER 2010

Bath & North East Somerset Council
Property Services
Northgate House
Upper Borough Walls
BATH BA1 1RG

Reproduced from Ordnance Survey mapping with permission of the Controller of Her Majesty's Stationary Office Crown Copyright. Unauthorised reproduction infringes Crown Copyright and may lead to prosecution or civil proceedings. License Number: 100023334



The COMMON SEAL of the
BATH AND NORTH EAST SOMERSET
COUNCIL

was hereunto affixed
in the presence of:-

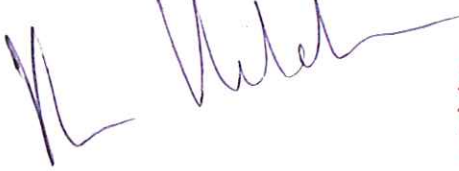

Authorised signatory



Dated this 13th day of January 2010

**The Corporate Seal of the Secretary of State
for Children, Schools and Families hereunto
affixed is authenticated by:**



BRETT WELCH



